

# PLAT OF SURVEY

**TRACT 2 DESCRIPTION:**

The Southeast Quarter (SE 1/4) of the Northeast Quarter (NE 1/4) and the Northeast Quarter (NE 1/4) of the Southeast Quarter (SE 1/4) of Section Thirty-one (31), Town Six (6) North, Range Three (3) West of the 4th P.M., Mount Ida Township, Grant County, Wisconsin.

NORTHWEST CORNER  
SE 1/4, NE 1/4

N 89°44'42" W 1327.91'

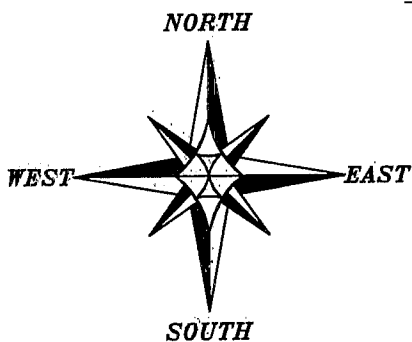

TRACT 1  
PREVIOUS SURVEY  
BY LARRY AUSTIN  
DATED 10-20-2003

**HILLTOP**

NORTHEAST CORNER  
SE 1/4, NE 1/4

SE 1/4-NE 1/4  
40.49± ACRES

**TRACT 2**  
81.00± ACRES  
3,528,407± SQ. FT.

ROAD

66' WIDE PUBLIC  
ROADWAY EASEMENT

**LEGEND**

- ☒ Aluminum Monument found with Grant County Aluminum Cap
- ⊗ No. 6 rebar found with Grant County Aluminum Cap
- No. 6 rebar found
- No. 6 x 24" rebar set with cap
- △ 1" diameter iron pipe found
- Approximate location of fence

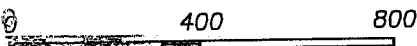

SCALE 1" = 400'

BEARINGS REFERENCED TO THE EAST LINE OF THE SE 1/4 OF SECTION 31 WHICH IS ASSUMED TO BEAR N 00°23'26" E.

**SURVEYOR'S CERTIFICATE:**

I, Larry L. Austin, Registered Wisconsin Land Surveyor, hereby certify:  
That the above description was surveyed, mapped and monumented as shown on this plat by me or under my direct supervision all in accordance to the instructions of Robert Belscamper, and to the best of my knowledge and belief, this plat is an accurate representation thereof.  
Dated this 21st day of September, 2005.

ALL PLANS THAT DO NOT SHOW A SEAL IMPRINT IN RED INK MAY CONTAIN UNAUTHORIZED ALTERATIONS. THE CERTIFICATION CONTAINED ON THIS DOCUMENT SHALL NOT APPLY TO ANY COPIES.

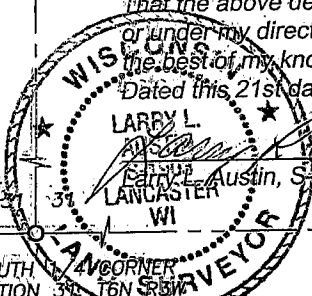

SOUTH CORNER SECTION 31, T6N R3W

N 89°47'16" W 2653.37'

SOUTHEAST CORNER SECTION 31, T6N R3W



**Austin Engineering LLC**

Prepared For: **ROBERT BELSCAMPER**

4211 HWY 81 E, LANCASTER, WI 53813  
PHONE 608-723-6363 FAX 608-723-6702

JOB NO: 05s101  
FIELDBOOK: TDS RANGER  
G:\T6NR3W\30A  
H:\PLAT\T6NR3W\31\05s101-BELSCAMPER

DRAWN BY: AJ AUSTIN  
APPROVED: LL AUSTIN  
CREW: BS - SA