

NORTH 1/4 CORNER
SECTION 19, T6N R2W

PLAT OF SURVEY

THIS SURVEY WAS PREPARED FOR THE EXCHANGE
OF LAND BETWEEN ADJOINING LAND OWNERS.

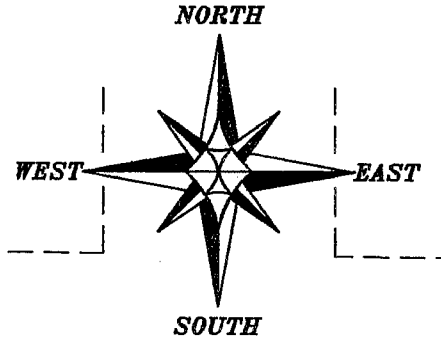

SEVENTH STREET

S 00°07'27" E
1229.20'

ADDITION

(STREET) STREET

BLOCK 3 BYERLY'S

JEFFERSON (WEFEL)

STREET

(CHURCH STREET)

JACKSON

TRACT 1
0.04± ACRE
1,714± SQ.FT.

TRACT 2
0.03± ACRE
1,241± SQ.FT.

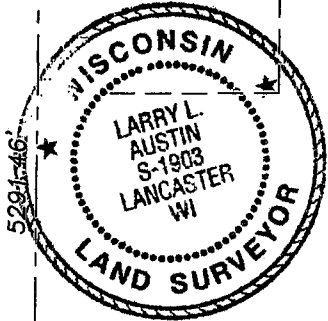

PREVIOUS SURVEY BY BRUCE
BOWDEN, DATED JULY 31, 2001

OUTLOT 43

OUTLOT 44

EIGHTH (PINE STREET) STREET

TRACT 1 DESCRIPTION:

Part of the Northwest Quarter (NW 1/4) of the Northeast Quarter (NE 1/4) of Section Nineteen (19), Town Six (6) North, Range Two (2) West of the 4th P.M., City of Fennimore, Grant County, Wisconsin, containing 0.04 acre, more or less, and being described as follows: Commencing at the North Quarter (N 1/4) corner of said Section Nineteen (19); thence South 00° 07' 27" East 1229.20' along the North-South Quarter (N-S 1/4) line of said Section; thence North 89° 52' 33" East 332.95' a No. 6 rebar marking the point of beginning; thence South 89° 26' 35" East 70.14' to a No. 6 rebar on the Southerly line of that property as described in Volume 674, Page 1, Grant County Registry; thence North 54° 49' 27" West 86.09' along the Southerly line of said property to a No. 6 rebar on the East line of Jefferson Street; thence South 00° 21' 26" East 34.41' along the East line of Jefferson Street to an 1 1/4" iron pipe; thence South 00° 02' 43" East 14.50' along the East line of Jefferson Street to the point of beginning. Tract being subject to any and all easements of record and or usage.

TRACT 2 DESCRIPTION:

Part of the Northwest Quarter (NW 1/4) of the Northeast Quarter (NE 1/4) of Section Nineteen (19), Town Six (6) North, Range Two (2) West of the 4th P.M., City of Fennimore, Grant County, Wisconsin, containing 0.03 acre, more or less, and being described as follows: Commencing at the North Quarter (N 1/4) corner of said Section Nineteen (19); thence South 00° 07' 27" East 1229.20' along the North-South Quarter (N-S 1/4) line of said Section; thence North 89° 52' 33" East 332.95' a No. 6 rebar; thence South 89° 26' 35" East 70.14' to a No. 6 rebar marking the point of beginning; thence South 89° 26' 35" East 59.68' to a No. 6 rebar on the East line of that property as described in Volume 674, Page 1, Grant County Registry; thence South 00° 14' 35" East 41.60' along the East line of said property to a No. 6 rebar; thence North 54° 49' 27" West 73.22' along the Southerly line of said property to the point of beginning. Tract being subject to any and all easements of record and or usage.

SURVEYOR'S CERTIFICATE:

I, Larry L. Austin, Registered Wisconsin Land Surveyor, hereby certify: That the descriptions herein were surveyed, mapped and monumented as shown on this plat by me or under my direct supervision all in accordance to the instructions of Fennimore and Rural Fire Board and Lewis and Kathy Gabel, and to the best of my knowledge and belief, this plat is an accurate representation thereof.
Dated this 18th day of March, 2005.

Larry L. Austin
Larry L. Austin, S-1903

That all plans that do not show a seal imprint in red ink may contain unauthorized alterations. The certification contained on this document shall not apply to any copies.

LEGEND

- ⊠ Aluminum Cap in Concrete found
- ⊞ Aluminum Monument in Concrete found
- No. 6 rebar found
- No. 10 rebar found
- ▲ 1 1/4" diameter iron pipe found
- ▲ 2" diameter iron pipe found
- No. 6 x 24" rebar set with cap
- () Recorded information

BEARINGS REFERENCED TO THE
NORTH-SOUTH 1/4 LINE OF SECTION 19
WHICH IS ASSUMED TO BEAR S 00°07'27" E.

0 50 100

SCALE 1" = 50'

SOUTH 1/4 CORNER
SECTION 19, T6N R2W

19 19
30 30



**Austin
Engineering LLC**

4211 HWY 81 E, LANCASTER, WI 53813
PHONE 608-723-6363 FAX 608-723-6702

Prepared For: **CITY OF FENNIMORE**

JOB NO: 05s042 DRAWN BY: AJ AUSTIN
FIELDBOOK: 2415B APPROVED: LL AUSTIN
G:\GRANTDOT\HWY18 CREW: BS - SA
H:\PLAT\FENNIMORE\OUTLOT\43\05s042-FIREDEPT

DELTA 3 ENGINEERING, INC
52 MEANS DRIVE, SUITE 101 PLATTEVILLE, WI 53818
PHONE: 608-348-5355 FAX: 608-348-5455