

# PLAT OF SURVEY

## TRACT 5 DESCRIPTION:

Part of the Southwest Quarter (SW 1/4) of the Northwest Quarter (NW 1/4) of Section Fifteen (15), Town Three (3) North, Range Four (4) West of the 4th P.M., Waterloo Township, Grant County, Wisconsin, containing 5.93 acres, more or less, and being described as follows:

Commencing at the Northwest corner of said Section;  
thence South 00° 11' 16" East 1323.80' along the West line of said Section to a No. 6 rebar marking the Northwest corner of the Southwest Quarter (SW 1/4) of the Northwest Quarter (NW 1/4) thereof;  
thence North 89° 30' 41" East 447.97' along the North line of the Southwest Quarter (SW 1/4) of said Northwest Quarter (NW 1/4) to a No. 6 rebar marking the point of beginning;  
thence North 89° 30' 41" East 73.75' along said North line to a No. 6 rebar;  
thence South 26° 41' 09" East 185.92' to a No. 6 rebar on the North line of a Tract 1 of a previous survey by Larry Austin dated June 25, 2003;  
thence South 73° 36' 20" West 33.36' along a line of said Tract 1 to a No. 6 rebar;  
thence South 25° 08' 16" East 321.44' along a line of said Tract 1 to a No. 6 rebar;  
thence South 16° 18' 20" East 82.62' along a line of Tract 2 of a previous survey by Larry Austin dated June 25, 2003 to a No. 6 rebar;  
thence continuing South 16° 18' 20" East 134.40' along a line of a previous survey by Larry Austin dated February 1, 1990 to a No. 7 rebar;  
thence South 62° 02' 12" East 93.46' to a No. 6 rebar marking a corner of Tract 3 of a previous survey by Larry Austin dated June 2, 2004;  
thence South 00° 40' 23" West 325.26' along a line of said Tract 3 to a point in the centerline of a township road known as Chaffie Hollow Road;  
thence 31.64' on the arc of a curve to the left having a radius of 475.00' and a long chord bearing South 80° 36' 33" West 31.63' along said centerline;  
thence South 78° 42' 04" West 64.69' along said centerline;  
thence 260.47' on the arc of a curve to the left having a radius of 285.00' and a long chord bearing South 52° 31' 09" West 251.50' along said centerline;  
thence South 26° 20' 15" West 17.95' along said centerline to a corner of Tract 4 of a previous survey by Larry Austin dated December 22, 2004;  
thence North 04° 36' 48" West 1234.20' along a line of said Tract 4 to the point of beginning.  
Tract being subject to any and all easements of record and/or usage.

## TRACT 6 DESCRIPTION:

Part of the Northwest Quarter (NW 1/4) of the Northwest Quarter (NW 1/4) of Section Fifteen (15), Town Three (3) North, Range Four (4) West of the 4th P.M., Waterloo Township, Grant County, Wisconsin, containing 9.33 acres, more or less, and being described as follows:

Commencing at the Northwest corner of said Section;  
thence North 89° 32' 17" East 592.55' along the North line of said Section to a No. 6 rebar marking the point of beginning;  
thence North 89° 32' 17" East 720.71' along the North line of said Section to a point in the centerline of a township road known as Salis Road;  
thence South 02° 36' 01" West 308.04' along said centerline;  
thence 231.33' on the arc of a curve to the left having a radius of 1697.40' and a long chord bearing South 01° 18' 15" East 231.15' along said centerline;  
thence 135.24' on the arc of a curve to the right having a radius of 5500.00' and a long chord bearing South 04° 30' 14" East 135.24' along said centerline;  
thence South 89° 32' 17" West 505.69' to a No. 6 rebar;  
thence North 17° 53' 35" West 706.05' to the point of beginning.  
Tract being subject to any and all easements of record and/or usage.

## SURVEYOR'S CERTIFICATE:

I, Larry L. Austin, Registered Wisconsin Land Surveyor, hereby certify:  
That the above descriptions were surveyed, mapped and monumented as shown on this plat by me or under my direct supervision.

That conformance with local ordinances are not guaranteed with this survey.  
That this survey was prepared under the instructions of Eric Salis.  
That to the best of my knowledge and belief, this plat is an accurate representation thereof.  
That all plans that do not show a seal imprint in red ink may contain unauthorized alterations.  
The certification contained on this document shall not apply to any copies.  
Dated this 2nd day of March, 2005.

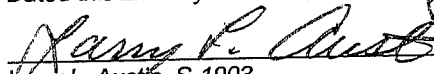
  
Larry L. Austin, S-1903

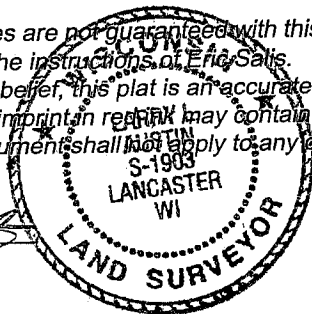

## SURVEYOR'S NOTES:

Surveyor has made no investigation for easements of record, encumbrances, restrictive covenants, ownership title evidence except as specifically shown on this plat. No distance should be assumed by scaling. No improvements have been located unless shown and noted. No representation as to ownership, use or possession should be hereon implied. Refer to abstract, title or local ordinances for any additional restriction, easements or building setback lines. No abstract, nor title commitment, nor results of title searches were furnished the surveyor. There may exist documents of record which would affect this parcel.



**Austin**  
**Engineering** *inc*

4211 HWY 81 E, LANCASTER, WI 53813  
PHONE 608-723-6363 FAX 608-723-6702

Prepared For: **ERIC SALIS**

JOB NO: 05s015  
FIELDBOOK: TDS RANGER  
G:\T3NR4W\15A  
H:\PLAT\T3NR4W\15\05s215-SALIS

DRAWN BY: AJ AUSTIN  
APPROVED: LL AUSTIN  
CREW: BS - SA - BD

SHEET 2 OF 2

# PLAT OF SURVEY

**TRACT 5 DESCRIPTION:**

Part of the Southwest Quarter (SW 1/4) of the Northwest Quarter (NW 1/4) of Section Fifteen (15), Town Three (3) North, Range Four (4) West of the 4th P.M., Waterloo Township, Grant County, Wisconsin, containing 5.93 acres, more or less, and being described as follows:

Commencing at the Northwest corner of said Section;

thence South 00° 11' 16" East 1323.80' along the West line of said Section to a No. 6 rebar marking the Northwest corner of the Southwest Quarter (SW 1/4) of the Northwest Quarter (NW 1/4) thereof;

thence North 89° 30' 41" East 447.97' along the North line of the Southwest Quarter (SW 1/4) of said Northwest Quarter (NW 1/4) to a No. 6 rebar marking the point of beginning;

thence North 89° 30' 41" East 73.75' along said North line to a No. 6 rebar;

thence South 26° 41' 09" East 185.92' to a No. 6 rebar on the North line of a Tract 1 of a previous survey by Larry Austin dated June 25, 2003;

thence South 73° 36' 20" West 33.36' along a line of said Tract 1 to a No. 6 rebar;

thence South 25° 08' 16" East 321.44' along a line of said Tract 1 to a No. 6 rebar;

thence South 16° 18' 20" East 82.62' along a line of Tract 2 of a previous survey by Larry Austin dated June 25, 2003 to a No. 6 rebar;

thence continuing South 16° 18' 20" East 134.40' along a line of a previous survey by Larry Austin dated February 1, 1990 to a No. 7 rebar;

thence South 62° 02' 12" East 93.46' to a No. 6 rebar marking a corner of Tract 3 of a previous survey by Larry Austin dated June 2, 2004;

thence South 00° 40' 23" West 325.26' along a line of said Tract 3 to a point in the centerline of a township road known as Chaffie Hollow Road;

thence 31.64' on the arc of a curve to the left having a radius of 475.00' and a long chord bearing South 80° 36' 33" West 31.63' along said centerline;

thence South 78° 42' 04" West 64.69' along said centerline;

thence 260.47' on the arc of a curve to the left having a radius of 285.00' and a long chord bearing South 52° 31' 09" West 251.50' along said centerline;

thence South 26° 20' 15" West 17.95' along said centerline to a corner of Tract 4 of a previous survey by Larry Austin dated December 22, 2004;

thence North 04° 36' 48" West 1234.20' along a line of said Tract 4 to the point of beginning.

Tract being subject to any and all easements of record and/or usage.

**TRACT 6 DESCRIPTION:**

Part of the Northwest Quarter (NW 1/4) of the Northwest Quarter (NW 1/4) of Section Fifteen (15), Town Three (3) North, Range Four (4) West of the 4th P.M., Waterloo Township, Grant County, Wisconsin, containing 9.33 acres, more or less, and being described as follows:

Commencing at the Northwest corner of said Section;

thence North 89° 32' 17" East 592.55' along the North line of said Section to a No. 6 rebar marking the point of beginning;

thence North 89° 32' 17" East 720.71' along the North line of said Section to a point in the centerline of a township road known as Salis Road;

thence South 02° 36' 01" West 308.04' along said centerline;

thence 231.33' on the arc of a curve to the left having a radius of 1697.40' and a long chord bearing South 01° 18' 15" East 231.15' along said centerline;

thence 135.24' on the arc of a curve to the right having a radius of 5500.00' and a long chord bearing South 04° 30' 14" East 135.24' along said centerline;

thence South 89° 32' 17" West 505.69' to a No. 6 rebar;

thence North 17° 53' 35" West 706.05' to the point of beginning.

Tract being subject to any and all easements of record and/or usage.

**SURVEYOR'S CERTIFICATE:**

I, Larry L. Austin, Registered Wisconsin Land Surveyor, hereby certify:

That the above descriptions were surveyed, mapped and monumented as shown on this plat by me or under my direct supervision.

That conformance with local ordinances are not guaranteed with this survey.

That this survey was prepared under the instructions of Eric Salis.

That to the best of my knowledge and belief, this plat is an accurate representation thereof.

That all plans that do not show a seal or stamp in red ink may contain unauthorized alterations.

The certification contained on this document shall not apply to any copies.

Dated this 2nd day of March, 2005.

*Larry L. Austin*  
Larry L. Austin, S-1908

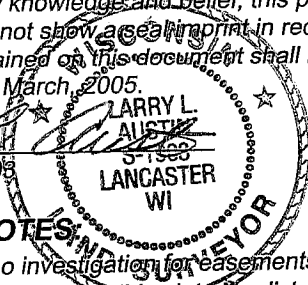

**SURVEYOR'S NOTES:**

Surveyor has made no investigation for easements of record, encumbrances, restrictive covenants, ownership title evidence except as specifically shown on this plat. No distance should be assumed by scaling. No improvements have been located unless shown and noted. No representation as to ownership, use or possession should be hereon implied. Refer to abstract, title or local ordinances for any additional restriction, easements or building setback lines. No abstract, nor title commitment, nor results of title searches were furnished the surveyor. There may exist documents of record which would affect this parcel.



**Austin Engineering LLC**

4211 HWY 81 E, LANCASTER, WI 53813  
PHONE 608-723-6363 FAX 608-723-6702

Prepared For: **ERIC SALIS**

JOB NO: 05s015  
FIELDBOOK: TDS RANGER  
G:\T3NR4W\15A  
H:\PLAT\T3NR4W\15\05s215-SALIS

DRAWN BY: AJ AUSTIN  
APPROVED: LL AUSTIN  
CREW: BS - SA - BD

SHEET 2 OF 2

# PLAT OF SURVEY

