

# BRENEMAN'S BLUFFVIEW LAND SURVEYING SERVICES

E 12865 C. T. H. W  
BARABOO, WISCONSIN, 53913  
PHONE 608-356-8780



PROJECT NO. 2916A  
NOVEMBER 22, 2004  
FILE NO. 29-16A  
SHEET 1 OF 3

CLIENT & OWNER:  
HARVEY R. & YVONNE A. RILEY  
414 NORTH 6TH STREET  
MUSCODA WI 53573

## PLAT OF SURVEY

VILLAGE OF MUSCODA, GRANT COUNTY WISCONSIN BLOCK 103 OF ORIGINAL PLAT LOTS SEVEN (7), EIGHT (8), NINE (9) AND TEN (10). PARCEL DESCRIPTION 'A' BEING LOCATED IN LOTS SEVEN (7), EIGHT (8), NINE (9) AND TEN (10) ABOVE DESCRIBED PARCEL. PARCEL DESCRIPTION 'B' BEING LOCATED IN LOTS NINE (9) AND TEN (10) ABOVE DESCRIBED PROPERTY.

DESCRIPTION 'A' BEING LOCATED IN LOTS SEVEN (7), EIGHT (8), NINE (9) AND TEN (10) OF BLOCK 103 ORIGINAL PLAT VILLAGE OF MUSCODA, GRANT COUNTY WISCONSIN, WHICH IS BOUNDED BY A LINE DESCRIBED AS FOLLOWS TO WIT:

Beginning at an existing 3/4" O.D. solid iron rod at the Southwest corner of Lot Eight (8) Block 103 original plat Village of Muscoda; thence N00° 00' 30"W 99.98 feet along the West lines of Lots Eight (8) and Seven (7) respectively, of said Block 103; to an existing 3/4" O.D. solid iron rod at the Northwest corner of said Lot Seven (7); thence N89° 59' 26"E 140.01 feet along the North line of said Lot Seven (7), to an existing 3/4" solid iron rod at the Northeast corner thereof; thence N89° 59' 46"E 20.00 feet along the North line of Lot Ten (10) said Block 103, to a set 3/4" O.D. x 24" solid iron rod; thence S00° 00' 04"W 99.98 feet parallel to and with the East boundary lines of said Lots Seven (7) and Eight (8) respectively, to a set 3/4" O.D. x 24" solid iron rod on the South boundary line of said Lot Nine (9) Block 103; also being on the North right of way line of Maple Street; thence S89° 59' 26"W 20.00 feet along the South boundary line of said Lot Nine (9); to an existing 3/4" O.D. x 24" solid iron rod at the Southwest corner of said Lot Nine (9); thence continuing S89° 59' 26"W 139.99 feet along the South line of said Lot Eight (8) Block 103 and the North right of way line of Maple Street, to the point of beginning.

Said parcel DESCRIPTION 'A' containing residence at 414 North 6th Street and an outside utility storage shed contains an area of 15,997± square feet more or less or 0.367± acres more or less and is subject to any and all easements and rights of ways of record.

Said parcel DESCRIPTION 'A' may also be subject to any and all of the following exceptions to warranties; easements and restrictions of record, zoning, land use, building and other laws affecting the use of premise, if any.

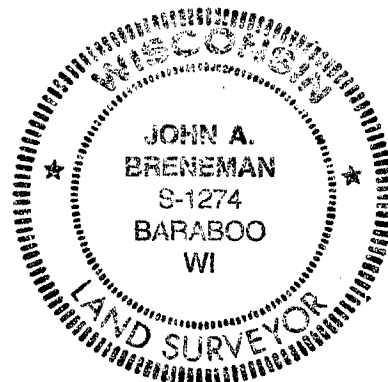

*John A. Breneman*  
Nov 22, 2004

**BRENEMAN'S BLUFFVIEW  
LAND SURVEYING SERVICES**

E 12865 C. T. H. W  
BARABOO, WISCONSIN, 53913  
PHONE 608-356-8780

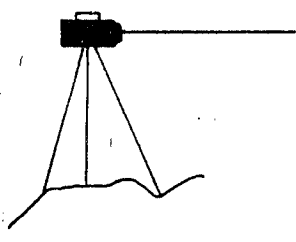

PROJECT NO. 2916A

SHEET 2 OF 3

**DESCRIPTION 'B' BEING LOCATED IN LOTS NINE (9) AND TEN (10) OF BLOCK 103 ORIGINAL PLAT VILLAGE OF MUSCODA, GRANT COUNTY WISCONSIN WHICH IS BOUNDED BY A LINE AND DESCRIBED AS FOLLOWS TO WIT:**

Commencing at an existing 3/4" O.D. solid iron rod at the Southwest corner of Lot Eight (8) Block 103 original plat Village of Muscoda; thence N89° 59' 26"E 159.99 feet along the South lines of Lots Eight (8) and Nine (9) respectively of said Block 103; also being the North right of way line of Maple Street to the point of beginning.

Thence N00° 00' 04"E 99.98 feet parallel to and with the East lines of Lots Eight (8) and Seven (7) Block 103, respectively to a set 3/4" O.D. x 24" solid iron rod on the North line of Lot Ten (10) said Block 103; thence N89° 59' 46"E 120.13 feet along the North line of said Lot Ten (10) to a set 3/4" O.D. x 24" solid iron rod at the Northeast corner of said Lot Ten (10), being on the West right of way line of Seventh (7th) Street; thence S00° 04' 56"W 99.97 feet along the East boundary lines of Lots Ten (10) and Nine (9) respectively and the West right of way line of Seventh (7th) Street, to an existing 3/4" O.D. solid iron rod at the Southeast corner of said Lot Nine (9) Block 103; thence S89° 59' 26"W 119.99 feet along the South boundary line of said Lot Nine (9) Block 103, being contiguous with the North R.O.W. line of Maple Street, to the point of beginning.

Said parcel DESCRIPTION 'B' contains 12,003± square feet more or less or 0.276± acres more or less and is subject to any and all easements and rights of ways of record.

Said parcel DESCRIPTION 'B' may also be subject to any and all of the following exceptions to warranties; easements and restrictions of record, zoning, land use, building and other laws affecting the use of premise, if any.

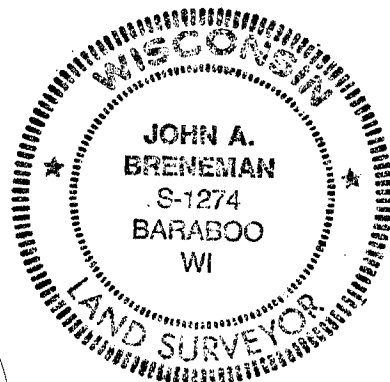

Nov. 22, 2004

*John A. Breneman*

