

PLAT OF SURVEY

FOR: LEE MELLUM (TRAPPER)

LOCATED IN THE NE 1/4 OF THE SW 1/4 OF SECTION 13, T8N, R1W,
MUSCODA TOWNSHIP, GRANT COUNTY, WISCONSIN

SHEET 1 OF 2
JOB #2004-60
CREW ML SS

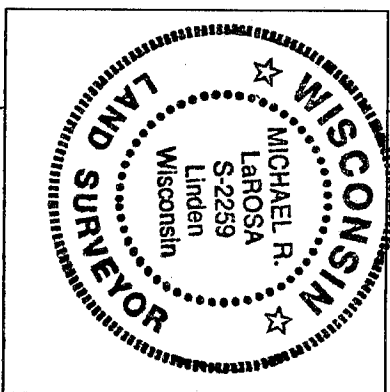

Michael R. LaRosa 10/12/04

Michael R. LaRosa RLS S-2259 Date

W 1/4 CORNER 13, T8N, R1W
FD. ALUM. CAPPED CO. MON.

N 89°06'37" E
245.78' 1" NORTH OF
FENCE CORNER

N 00°01'37" E
256.35'

LEGEND:
1"X24"X1.13 #/LF IRON PIPE SET IN
PREVIOUS SURVEY DATED 8/8/2004
3/4" IRON ROD SET THIS SURVEY
RECORDED AS

50.09 ACRES ±
PREVIOUSLY SURVEYED
8/8/2004

N 89°06'37" E
2390.92'

10.66
ACRES ±

S 59°47'32" W 208.75'
S 52°35'04" W 280.24'
N 33°06'09" E 374.76'

2" NORTH AND 4" WEST
OF FENCES N.S.W.

N 00°17'45" E
2615.63'

N 89°06'37" E
2647.23'

E 1/4 CORNER 13, T8N, R1W
FD. 1-1/2" IRON ROD

N 1/4 CORNER 13, T8N, R1W
FOUND 3/4" IRON ROD



PLAT BEARINGS ARE REFERENCED TO THE N-S QUARTER
SECTION LINE OF 13, T8N, R1W WHICH COMPUTES TO
BEAR AS SHOWN IN THE GRANT COUNTY COORDINATE SYSTEM.

ORIGINAL DRAWING
SCALE
1" = 300'

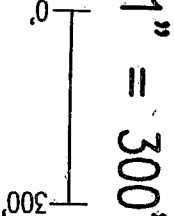

STRIP NOTED IN A PLAT OF
SURVEY BY K. A. KERST
DATED 7/30/81 CONTAINS
DRIVEWAY

ACCESS EASEMENT
CENTERLINE OF EXISTING
GRAVEL DRIVEWAY

S 00°17'45" W
1440.97'

S 87°06'16" W
217.11'

N 03°38'55" W, 125.12'

S 85°09'53" W, 254.28'

N 17°37'30" W, 146.10'

N 82°31'46" W, 526.04'

N 03°38'55" W, 94.48'

S 73°16'01" W, 245.78'

S 69°02'23" W, 252.23'

S 86°13'13" W, 238.60'

S 00°59'36" W, 213.38'

N 18°56'37" W, 705.73'

S 18°56'37" W, 705.73'

N 46°59'48" E, 656.42'

N 46°59'48" E, 656.42'

N 17°37'30" W, 146.10'

N 82°31'46" W, 526.04'

N 03°38'55" W, 94.48'

S 73°16'01" W, 245.78'

S 69°02'23" W, 252.23'

S 86°13'13" W, 238.60'

S 00°59'36" W, 213.38'

N 18°56'37" W, 705.73'

S 18°56'37" W, 705.73'

N 46°59'48" E, 656.42'

N 46°59'48" E, 656.42'

N 17°37'30" W, 146.10'

N 82°31'46" W, 526.04'

N 03°38'55" W, 94.48'

S 73°16'01" W, 245.78'

S 69°02'23" W, 252.23'

S 86°13'13" W, 238.60'

S 00°59'36" W, 213.38'

N 18°56'37" W, 705.73'

S 18°56'37" W, 705.73'

N 46°59'48" E, 656.42'

N 46°59'48" E, 656.42'

N 17°37'30" W, 146.10'

N 82°31'46" W, 526.04'

N 03°38'55" W, 94.48'

S 73°16'01" W, 245.78'

S 69°02'23" W, 252.23'

S 86°13'13" W, 238.60'

S 00°59'36" W, 213.38'

N 18°56'37" W, 705.73'

S 18°56'37" W, 705.73'

N 46°59'48" E, 656.42'

N 46°59'48" E, 656.42'

N 17°37'30" W, 146.10'

N 82°31'46" W, 526.04'

N 03°38'55" W, 94.48'

S 73°16'01" W, 245.78'

S 69°02'23" W, 252.23'

S 86°13'13" W, 238.60'

S 00°59'36" W, 213.38'

N 18°56'37" W, 705.73'

S 18°56'37" W, 705.73'

N 46°59'48" E, 656.42'

N 46°59'48" E, 656.42'

N 17°37'30" W, 146.10'

N 82°31'46" W, 526.04'

N 03°38'55" W, 94.48'

S 73°16'01" W, 245.78'

S 69°02'23" W, 252.23'

S 86°13'13" W, 238.60'

S 00°59'36" W, 213.38'

N 18°56'37" W, 705.73'

S 18°56'37" W, 705.73'

N 46°59'48" E, 656.42'

N 46°59'48" E, 656.42'

N 17°37'30" W, 146.10'

N 82°31'46" W, 526.04'

N 03°38'55" W, 94.48'

S 73°16'01" W, 245.78'

S 69°02'23" W, 252.23'

S 86°13'13" W, 238.60'

S 00°59'36" W, 213.38'

N 18°56'37" W, 705.73'

S 18°56'37" W, 705.73'

N 46°59'48" E, 656.42'

N 46°59'48" E, 656.42'

N 17°37'30" W, 146.10'

N 82°31'46" W, 526.04'

N 03°38'55" W, 94.48'

S 73°16'01" W, 245.78'

S 69°02'23" W, 252.23'

S 86°13'13" W, 238.60'

S 00°59'36" W, 213.38'

N 18°56'37" W, 705.73'

S 18°56'37" W, 705.73'

N 46°59'48" E, 656.42'

N 46°59'48" E, 656.42'

N 17°37'30" W, 146.10'

N 82°31'46" W, 526.04'

N 03°38'55" W, 94.48'

S 73°16'01" W, 245.78'

S 69°02'23" W, 252.23'

S 86°13'13" W, 238.60'

S 00°59'36" W, 213.38'

N 18°56'37" W, 705.73'

S 18°56'37" W, 705.73'

N 46°59'48" E, 656.42'

N 46°59'48" E, 656.42'

N 17°37'30" W, 146.10'

N 82°31'46" W, 526.04'

N 03°38'55" W, 94.48'

S 73°16'01" W, 245.78'

S 69°02'23" W, 252.23'

S 86°13'13" W, 238.60'

S 00°59'36" W, 213.38'

N 18°56'37" W, 705.73'

S 18°56'37" W, 705.73'

N 46°59'48" E, 656.42'

N 46°59'48" E, 656.42'

N 17°37'30" W, 146.10'

N 82°31'46" W, 526.04'

N 03°38'55" W, 94.48'

S 73°16'01" W, 245.78'

S 69°02'23" W, 252.23'

S 86°13'13" W, 238.60'

S 00°59'36" W, 213.38'

N 18°56'37" W, 705.73'

S 18°56'37" W, 705.73'

N 46°59'48" E, 656.42'

N 46°59'48" E, 656.42'

N 17°37'30" W, 146.10'

N 82°31'46" W, 526.04'

N 03°38'55" W, 94.48'

S 73°16'01" W, 245.78'

S 69°02'23" W, 252.23'

S 86°13'13" W, 238.60'

S 00°59'36" W, 213.38'

N 18°56'37" W, 705.73'

S 18°56'37" W, 705.73'

N 46°59'48" E, 656.42'

N 46°59'48" E, 656.42'

N 17°37'30" W, 146.10'

N 82°31'46" W, 526.04'

N 03°38'55" W, 94.48'

S 73°16'01" W, 245.78'

S 69°02'23" W, 252.23'

S 86°13'13" W, 238.60'

S 00°59'36" W, 213.38'

N 18°56'37" W, 705.73'

S 18°56'37" W, 705.73'

N 46°59'48" E, 656.42'

N 46°59'48" E, 656.42'

N 17°37'30" W, 146.10'

N 82°31'46" W, 526.04'

N 03°38'55" W, 94.48'

S 73°16'01" W, 245.78'

S 69°02'23" W, 252.23'

S 86°13'13" W, 238.60'

S 00°59'36" W, 213.38'

N 18°56'37" W, 705.73'

S 18°56'37" W, 705.73'

N 46°59'48" E, 656.42'

N 46°59'48" E, 656.42'

N 17°37'30" W, 146.10'

N 82°31'46" W, 526.04'

N 03°38'55" W, 94.48'

S 73°16'01" W, 245.78'

S 69°02'23" W, 252.23'

S 86°13'13" W, 238.60'

S 00°59'36" W, 213.38'

N 18°56'37" W, 705.73'

S 18°56'37" W, 705.73'

N 46°59'48" E, 656.42'

N 46°59'48" E, 656.42'

N 17°37'30" W, 146.10'

N 82°31'46" W, 526.04'

N 03°38'55" W, 94.48'

S 73°16'01" W, 245.78'

S 69°02'23" W, 252.23'

S 86°13'13" W, 238.60'

S 00°59'36" W, 213.38'

N 18°56'37" W, 705.73'

S 18°56'37" W, 705.73'

N 46°59'48" E, 656.42'

N 46°59'48" E, 656.42'

N 17°37'30" W, 146.10'

N 82°31'46" W, 526.04'

N 03°38'55" W, 94.48'

S 73°16'01" W, 245.78'

S 69°02'23" W, 252.23'

Plat of survey
For: Lee Mellum (Trapper)
Job #2004-60
Sheet 2 of 2

PARCEL DESCRIPTION:

A parcel of land located in part of the NE 1/4 of the SW 1/4 of Section 13, T8N, R1W, Muscoda Township, Grant County, Wisconsin, to wit:

Commencing at the S 1/4 CORNER of said Section 13; thence N 0° 17' 45" E, 1440.97'; thence S 87° 06' 16" W, 217.11'; thence N 3° 38' 55" W, 125.12' to the POINT OF BEGINNING; thence S 69° 02' 25" W, 252.23'; thence S 86° 13' 13" W, 238.60'; thence S 85° 09' 53" W, 254.28'; thence S 69° 08' 33" W, 191.23'; thence N 63° 13' 33" W, 118.95'; thence N 0° 59' 36" E, 213.38'; thence N 18° 56' 37" E, 705.79'; thence N 59° 47' 32" E, 243.67'; thence N 52° 35' 04" E, 208.75'; thence N 89° 06' 37" E, 280.24'; thence S 33° 06' 09" W, 374.76'; thence S 46° 59' 48" W, 656.42'; thence S 17° 37' 30" E, 146.10'; thence S 82° 31' 46" E, 526.04'; thence N 73° 16' 01" E, 245.78'; thence S 3° 38' 55" E, 94.48' to the POINT OF BEGINNING; said described parcel containing 10.66 acres, more or less. Parcel is subject to any easements, restrictions, and regulations of record.

SURVEYOR'S CERTIFICATE:

I hereby certify that I have made a survey according to the instructions and/or description furnished me and that the plat drawn is a correct representation of that survey to the best of my knowledge and belief.

Michael R. LaRosa

10/12/2004

Michael R. LaRosa RLS No. S-2259

date

