

**PLAT OF SURVEY for ERIC VONDRUM**

LOCATED IN THE SW 1/4 OF THE SE 1/4 OF SECTION 20, T4N  
R2W, ELLENBORO TOWNSHIP, GRANT COUNTY, WISCONSIN

**PROPERTY DESCRIPTION:**

Part of the Southwest Quarter (SW 1/4) of the Southeast Quarter (SE 1/4) of Section Twenty (20), Town Four (4) North, Range Two (2) West of the 4th P.M., Ellenboro Township, Grant County, Wisconsin, containing 7.34 acres, more or less and being described as follows:

Commencing at the South Quarter (S 1/4) corner of said Section; thence North 01° 44' 50" West 520.74' along the North-South Quarter (N-S 1/4) line of said Section to the point of beginning;

thence North 87° 56' 55" East 546.52';

thence North 17° 33' 19" East 29.85';

thence 207.10' on the arc of a curve to the left having a radius of 500.00' and a long chord bearing North 05° 27' 09" East 205.62';

thence North 06° 24' 48" West 194.79';

thence North 03° 53' 27" West 306.33';

thence North 05° 36' 00" East 45.60';

thence North 88° 59' 50" West 250.38' along the North line of the

Southwest Quarter (SW 1/4) of said Southeast Quarter (SE 1/4);

thence South 00° 58' 36" East 413.84' along a line as described in Volume 626, Page 525, Document No. 514172, Grant County Registry;

thence South 87° 56' 55" West 305.03' along a line as described in said Volume 626, Page 525;

thence South 01° 44' 50" East 377.16' along said North-South Quarter (N-S 1/4) line to the point of beginning.

Parcel being subject to any and all easements of record and/or usage.

**EASEMENT DESCRIPTION: (USE TO BE CLARIFIED BY OTHERS)**

A Sixty-six foot (66') wide ingress-egress easement being located in the Southwest Quarter (SW 1/4) of the Southeast Quarter (SE 1/4) and the Northwest Quarter (NW 1/4) of the Southeast Quarter (SE 1/4) of Section Twenty (20), Town Four (4) North, Range Two (2) West of the 4th P.M., Ellenboro Township, Grant County, Wisconsin, the centerline of said easement being described as follows:

Commencing at the South Quarter (S 1/4) corner of said Section;

thence North 01° 44' 50" West 520.74' along the North-South Quarter (N-S 1/4) line of said Section;

thence North 87° 56' 55" East 546.52' to the point of beginning;

thence North 17° 33' 19" East 29.85';

thence 207.10' on the arc of a curve to the left having a radius of 500.00' and a long chord bearing North 05° 27' 09" East 205.62';

thence North 06° 24' 48" West 194.79';

thence North 03° 53' 27" West 306.33';

thence North 05° 36' 00" East 45.60';

Thence North 05° 36' 00" West 54.17' to a point in the centerline of East Lane, said point being the terminus point.

**SURVEYOR'S CERTIFICATE:**

I, Larry L. Austin, Registered Wisconsin Land Surveyor, hereby certify: That the above descriptions were surveyed, mapped and monumented as shown on this plat by me or under my direct supervision.

That conformance with local ordinances are not guaranteed with this survey.

That this survey was prepared under the instructions of Eric Vondrum. That to the best of my knowledge and belief, this plat is an accurate representation thereof.

That all plans that do not show a seal imprint in red ink may contain unauthorized alterations.

The certification contained on this document shall not apply to any copies.

Dated this 15th day of April, 2002.

*Larry L. Austin*  
Larry L. Austin, S-1903

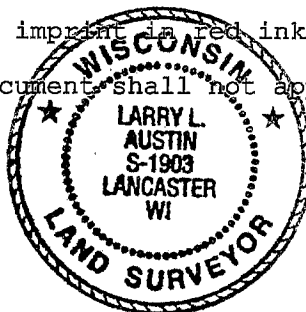

**AUSTIN ENGINEERING, LLC**  
4211 HWY 81 E, LANCASTER, WI 53813  
PHONE 608-723-6363 FAX 608-723-6702

FIELDBOOK: SDR33, 9726  
G:\T4NR2W\T4NR2W  
C:\AJA\T4NR2W\20\VONDRUM

DRAWN BY: AJ AUSTIN  
APPROVED: LL AUSTIN  
CREW: SA - BD

NORTH 1/4 CORNER  
SECTION 20, T4N R2W

# PLAT OF SURVEY for ERIC VONDRUM

LOCATED IN THE SW 1/4 OF THE SE 1/4 OF SECTION 20, T4N  
R2W, ELLENBORO TOWNSHIP, GRANT COUNTY, WISCONSIN

WEST 1/4  
CORNER

N 88°52'39" W 5281.29'

EAST 1/4  
CORNER

ALL PLANS THAT DO NOT SHOW A SEAL IMPRINT IN  
RED INK MAY CONTAIN UNAUTHORIZED ALTERATIONS.  
THE CERTIFICATION CONTAINED ON THIS DOCUMENT  
SHALL NOT APPLY TO ANY COPIES.  
DATED THIS 15TH DAY OF APRIL, 2002.



TERMINUS POINT  
CENTERLINE EASEMENT

## BAST LANE

N 88°59'50" W 250.38'  
217.27'

N 05°36'00" E 54.17'

NORTH LINE, SW 1/4, SE 1/4  
N 00°58'36" W 5.31'  
FOUND REBAR IS LOCATED IN THE  
SOUTHERLY R.O.W. OF BAST LANE

N 05°36'00" E 45.68'

N 05°36'00" E 45.60'

PROPERTY DESCRIBED IN  
VOLUME 586, PAGE 751,  
DOCUMENT NO. 592895,  
GRANT COUNTY REGISTRY

LINES RETRACED FROM  
PROPERTY DESCRIBED IN  
VOLUME 626, PAGE 525,  
DOCUMENT NO. 514172,  
GRANT COUNTY REGISTRY

(SOUTHERLY.....409')  
S 00°58'36" E 408.53'  
(NORTHERLY.....442±' TO THE NORTH LINE, SW 1/4, SE 1/4)  
S 00°58'36" E 413.84'

N 03°53'27" W 309.80'

N 03°53'27" W 306.33'

CENTERLINE  
66' WIDE ACCESS  
EASEMENT

NORTH-SOUTH 1/4 LINE

N 01°44'50" W 5286.76'  
N 01°44'50" W 430.34'

N 01°44'50" W 430.34'

S 01°44'50" E 377.16'

S 01°44'50" E 377.16'

EAST 10.5±

(WESTERLY.....293')  
S 87°56'55" W 305.03'  
(EASTERLY.....293')

### 7.34 ACRES ± 319,858 SQ. FT. ±

L=193.43'  
R=467.00'  
C LEN=192.05'  
BRG=N 05°27'09" E

L=207.10'  
R=500.00'  
C LEN=205.62'  
BRG=N 05°27'09" E

EAST 7.0±

N 87°56'55" E 546.52'

N 17°33'19" E 41.47'

N 17°33'19" E 29.85'

POINT OF BEGINNING  
CENTERLINE EASEMENT

Bearings referenced to the North-South 1/4 line of  
Section 20 which is assumed to bear N 01°44'50" W.

POINT OF BEGINNING  
PROPERTY

SOUTH 1/4 CORNER  
SECTION 20, T4N R2W

S 89°07'03" E 2646.74'

SOUTHEAST CORNER  
SECTION 20, T4N R2W

### LEGEND

- Aluminum Monument found with Grant County Aluminum Cap
- No. 6 rebar found
- No. 6 x 24" rebar set with cap
- ± No monument set
- ( ) Recorded as
- x-x- Approximate location of fence

0 100 200

SCALE 1" = 100'

**AUSTIN ENGINEERING, LLC**  
4211 HWY 81 E, LANCASTER, WI 53813  
PHONE 608-723-6363 FAX 608-723-6702

FIELDBOOK: SDR33, 9726  
G:\T4NR2W\T4NR2W  
C:\AJA\T4NR2W\20\VONDRUM

DRAWN BY: AJ AUSTIN  
APPROVED: LL AUSTIN  
CREW: SA - BD