



# PLAT OF SURVEY

## TRACT 1 DESCRIPTION:

Part of that property described in Volume 819, Page 158, recorded as Document No. 606137, Grant County Registry, being located in the Southwest Quarter (SW 1/4) of the Southeast Quarter (SE 1/4) of Section Seven (7), Town Three (3) North, Range Three (3) West of the 4th P.M., Potosi Township, Grant County, Wisconsin, containing 4.82 acres, more or less, and being described as follows: Commencing at the South Quarter (S 1/4) corner of said Section;

thence South 89° 35' 16" East 648.05' along the South line of said Section to the point of beginning;

thence North 06° 52' 57" West 38.02';

thence North 88° 47' 23" East 197.65';

thence North 74° 41' 01" East 80.71';

thence North 05° 00' 30" West 515.38';

thence South 85° 57' 42" West 229.68';

thence North 77° 05' 14" East 649.46';

thence 134.33' on the arc of a curve to the left having a radius of 223.59' and a long chord bearing South 11° 10' 15" West 132.32';

thence South 07° 35' 44" East 74.15';

thence South 00° 34' 16" East 135.98';

thence South 15° 22' 44" West 100.00';

thence South 37° 32' 44" West 100.00';

thence South 48° 57' 44" West 100.00';

thence South 57° 51' 44" West 100.00';

thence South 65° 36' 44" West 78.65';

thence South 01° 34' 16" East 41.45' to the South line of said Section;

thence North 89° 35' 16" West 297.29' along said South line to the point of beginning.

Tract being subject to any and all easements of record and/or usage.

## SURVEYOR'S CERTIFICATE:

I, Larry L. Austin, Registered Wisconsin Land Surveyor, hereby certify:

That the above description was surveyed, mapped and monumented as shown on this plat by me or under my direct supervision.

That conformance with local ordinances are not guaranteed with this survey.

That this survey was prepared under the instructions of Gerald Koeller.

That to the best of my knowledge and belief, this plat is an accurate representation thereof.

That all plans that do not show a seal imprint in red ink may contain unauthorized alterations.

The certification contained on this document shall not apply to any copies.

Dated this 25th day of October, 2003.

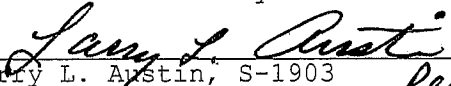
  
Larry L. Austin, S-1903

REV. 11-3-03 *llh* (monuments on plat) (desc. OK)

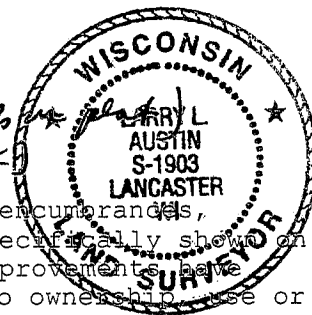

## SURVEYOR'S NOTES:

Surveyor has made no investigation for easements of record, encumbrances, restrictive covenants, ownership title evidence except as specifically shown on this plat. No distance should be assumed by scaling. No improvements have been located unless shown and noted. No representation as to ownership, use or possession should be hereon implied. Refer to abstract, title or local ordinances for any additional restriction, easements or building setback lines. No abstract, nor title commitment, nor results of title searches were furnished the surveyor. There may exist documents of record which would affect this parcel.

Prepared For: GERALD KOELLER

**AUSTIN ENGINEERING, LLC**  
4211 HWY 81 E, LANCASTER, WI 53813  
PHONE 608-723-6363 FAX 608-723-6702

JOB NO: 03S234  
FIELDBOOK: TDS RANGER, 2306  
G:\T3NR3W\T3NR3W  
H:\PLAT\T3NR3W\07\03S234-KOELLER

DRAWN BY: AJ AUSTIN  
APPROVED: LL AUSTIN  
CREW: BS - SA - SB - BD

SHEET 2 OF 2