

PLAT OF SURVEY

PART OF OUTLOT 31, SUBDIVISION OF SECTION 34, T3N R3W

DESCRIPTION PROVIDED:

A part of Out Lot Thirty-one (31) in the Village of Potosi, Grant County, Wisconsin, described as follows: Commence at the Northeast corner of Section Thirty-four (34), Town Three (3) North, Range Three (3) West in Grant County, Wisconsin, thence run South $41^{\circ} 51'$ West 733 feet, thence North $48^{\circ} 09'$ West 25 feet to the place of beginning, thence North $48^{\circ} 09'$ West 90 feet, thence South $41^{\circ} 51'$ West 91 feet, thence South $48^{\circ} 09'$ East 90 feet, thence North $41^{\circ} 51'$ East 91 feet to the place of beginning.

SURVEYOR'S CERTIFICATE:

I, Larry L. Austin, Registered Wisconsin Land Surveyor, hereby certify: That the above description was surveyed, mapped and monumented as shown on this plat by me or under my direct supervision. That conformance with local ordinances are not guaranteed with this survey. That this survey was prepared under the instructions of Phillip Otting. That to the best of my knowledge and belief, this plat is an accurate representation thereof. That all plans that do not show a seal imprint in red ink may contain unauthorized alterations. The certification contained on this document shall not apply to any copies.

Dated this 17th day of September, 2003

Larry L. Austin, S-1903

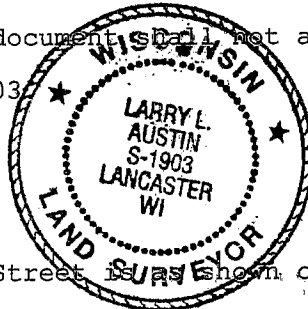

SURVEYOR'S NOTE:

The platted centerline of Reservoir Street is shown on this plat.

The Northeast corner of Section Thirty-four (34) has several locations based on previous surveys. The Northeast corner of Section Thirty-four (34) was NOT utilized in the retracement of this property. The retracement of this property was based upon adjoining properties and local evidence around the property.

The intent of the description provided matches the local evidence very well.

Surveyor has made no investigation for easements of record, encumbrances, restrictive covenants, ownership title evidence except as specifically shown on this plat. No distance should be assumed by scaling. No underground improvements have been located unless shown and noted. No representation as to ownership, use or possession should be hereon implied. Refer to abstract, title or local ordinances for any additional restriction, easements or building setback lines. No abstract, nor title commitment, nor results of title searches were furnished the surveyor. There may exist documents of record which would affect this parcel.

Prepared For: Phillip Otting

AUSTIN ENGINEERING, LLC
4211 HWY 81 E, LANCASTER, WI 53813
PHONE 608-723-6363 FAX 608-723-6702

JOB NO: 03S221
FIELDBOOK: 97-19
G:\POTOSI\POTOSI
H:\PLAT\POTOSI\OL\31\03S221-OTTING

DRAWN BY: SW AUSTIN
APPROVED: LL AUSTIN
CREW: BS - SB - SA - BD

SHEET 2 OF 2