

PLAT OF SURVEY FOR BRODBECK REALTY CORPORATION

LOT 3 AND PART OF LOT 2 OF BLOCK 44 OF THE ORIGINAL PLAT OF THE VILLAGE (NOW CITY) OF BOSCOBEL; AND PART OF THE VACATED ALLEY OF SAID BLOCK 44, ALL BEING LOCATED IN THE SOUTHEAST QUARTER OF THE SOUTHEAST QUARTER OF SECTION 27, TOWN 8 NORTH, RANGE 3 WEST, CITY OF BOSCOBEL, GRANT COUNTY, WISCONSIN, MORE PARTICULARLY DESCRIBED AS FOLLOWS:

COMMENCING AT THE SOUTHEAST CORNER OF SECTION 27; THENCE S 89°47'34"W ON THE SOUTH LINE OF THE SOUTHEAST QUARTER, 672.46'; THENCE N 0°04'40"W, 299.49' TO A No.6(3/4" DIA.) REBAR AT THE NORTHWEST CORNER OF LOT 3 OF BLOCK 44 OF THE ORIGINAL PLAT OF THE CITY OF BOSCOBEL AND THE POINT OF BEGINNING; THENCE N 89°59'51"E ON THE NORTH LINE OF BLOCK 44, 101.40' TO A 1/4" DIA. BRASS "SURVEY MARK" PLUG; THENCE S 0°08'54"E, 134.68' TO A No.6 REBAR; THENCE N 88°19'24"W, 85.61' TO A No.6 REBAR; THENCE S 89°59'51"W, 16.00'; THENCE N 0°04'40"W ON THE WEST LINE OF LOT 3, 132.17' TO THE POINT OF BEGINNING. PARCEL CONTAINS 0.31 ACRES (13,520 SQ. FT.), MORE OR LESS, AND IS SUBJECT TO ANY AND ALL EASEMENTS AND RIGHTS-OF-WAY OF RECORD AND/OR USAGE.

I, JAMES M. BAKER, REGISTERED WISCONSIN LAND SURVEYOR - 2530, AGENT OF BOWDEN SURVEYING, LTD., DO HEREBY CERTIFY THAT I HAVE SURVEYED, DESCRIBED, MAPPED AND MONUMENTED THE PROPERTY SHOWN HEREON IN ACCORDANCE WITH THE INSTRUCTIONS OF MR. RICK TAGGERT REPRESENTING BRODBECK REALTY CORPORATION AND THAT THIS MAP IS A CORRECT REPRESENTATION THEREOF TO THE BEST OF MY KNOWLEDGE AND BELIEF.

James M. Baker
 JAMES M. BAKER, R.L.S. - 2530
 AGENT OF BOWDEN SURVEYING, LTD.

DATE 4/29/2012

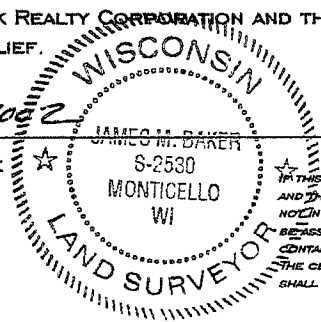

IF THE STAMP IS NOT RED COLORED AND THE SURVEYOR'S SIGNATURE IS NOT IN BLUE INK, THE MAP SHOULD BE ASSUMED TO BE A COPY AND MAY CONTAIN UNAUTHORIZED ALTERATIONS. THE CERTIFICATE SHOWN HEREON SHALL NOT APPLY TO ANY COPIES.

(66) OAK STREET (66)

