

JOB #2001-55A
CREW ML SS

PLAT OF SURVEY

FOR: DON & DORIS UDELHOFEN

E 1/4 CORNER 10, T2N, R3W
FOUND ALUMINUM CAPPED
COUNTY MONUMENT 20' ±
SOUTHERLY OF FENCE
CORNER.

PARCEL DESCRIPTION:

A parcel of land located in part of the SE 1/4 of the SE 1/4 of Section 10, T2N, R3W, Potosi Township, Grant County, Wisconsin, to wit:

Commencing at the SE CORNER of said Section 10; said point being the POINT OF BEGINNING; thence N 89° 57' 56" W, 18.50' to the northeasterly railroad right of way; thence along said right of way, N 49° 37' 56" W, 825.71'; thence N 45° 55' 04" E, 930.51' to the section line; thence along the section line, S 1° 00' 31" W, 1182.34' to the POINT OF BEGINNING; said described parcel containing 9.03 acres, more or less. Parcel is subject to any easements, restrictions, or regulations of record.

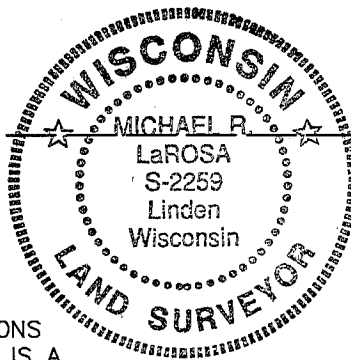

SURVEYOR'S CERTIFICATE

I HEREBY CERTIFY THAT I HAVE MADE A SURVEY ACCORDING TO THE DESCRIPTION AND/OR INSTRUCTIONS FURNISHED ME AND THAT THE PLAT DRAWN HEREON IS A CORRECT REPRESENTATION OF THAT SURVEY TO THE BEST OF MY KNOWLEDGE AND BELIEF.

Michael R. LaRosa 12/14/2001
MICHAEL R. LaROSA S-2259

NOTE: THIS LINE WAS SURVEYED BY THE U.S. ENGINEER OFFICE FOR THE BELOW NOTED PROJECT AND IS NOTED IN FIELD NOTES DATED 11/25/36 FROM THIS PROJECT.

9.03 ACRES ±



PLAT BEARINGS ARE REFERENCED TO THE EAST LINE OF THE SE 1/4 OF SECTION 10, T2N, R3W WHICH BEARS AS SHOWN IN THE GRANT COUNTY COORDINATE SYSTEM.

ORIGINAL DRAWING SCALE

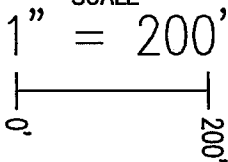

SET AT BASE OF CONCRETE SET POST

LEGEND:

- ⊗ MAG NAIL SET
- 1/2" IRON ROD SET
- 3/4" IRON ROD SET
- X- FENCE
- () RECORDED AS

N 45°55'04" E 100.47'

(N 45°00' E, 459.4')
N 45°55'04" E 459.41'

TRACT NO. FW-56
MISSISSIPPI RIVER
LOCK & DAM NO. 11
LAND ACQUISITION
SURVEY DATED 4/13/1937

N 89°57'56" W (N 89°53' W) 1158.60'

(N 89°53' W)
N 89°57'56" W 173.00'

S 01°00'31" W 1182.34'

SE CORNER 10, T2N, R3W
SET 1" X 30" IRON ROD
WITH COUNTY ALUMINUM CAP

RIVER LANE ROAD
N 01°00'31" E 1408.01'
N 01°00'31" E 60.61'

930.51'
322.33'

(N 46°45' E, 24.37 CH.)
303.94'

N 45°55'04" E 217.44'

N 89°57'56" W 18.50'

N 49°37'56" W 825.71'
S 49°37'56" E 717.65'
(S 49°33' E, 717.8')

FELL IN DITCH
NO MONUMENT SET

M. R. LaROSA TECHNICAL SERVICES

P.O. BOX 383 (263 E. MAIN ST.)

LINDEN, WISCONSIN 53553

TEL 608-623-3000