

Range 2 West of the 4th P. M.

North Line of the SE 1/4 of Section 13
S. 88°45'36" E. 2630.78'

Center of Creek Line Legend		
1	N. 26°42'53" E.	37.86'
2	N. 02°09'57" E.	113.34'
3	N. 73°14'16" E.	130.23'
4	N. 21°53'36" E.	84.52'
5	N. 10°34'05" E.	57.05'
6	N. 61°18'16" E.	113.84'
7	N. 28°36'45" E.	70.54'
8	N. 64°26'21" W.	104.44'
9	N. 15°32'14" E.	86.87'
10	N. 83°21'11" W.	93.42'
11	N. 12°33'52" W.	46.96'

20' Creek Meander Line Legend		
12	N. 26°42'53" E.	82.06'
13	N. 02°09'57" E.	103.40'
14	N. 73°14'16" E.	125.56'
15	N. 21°53'36" E.	96.12'
16	N. 10°34'05" E.	49.55'
17	N. 61°18'16" E.	110.22'
18	N. 28°36'45" E.	97.50'
19	N. 64°26'21" W.	108.76'
20	N. 15°32'14" E.	93.47'
21	N. 83°21'11" W.	102.58'
22	N. 12°33'52" W.	28.04'

Easement Centerline Curve Data					
Curve No	Radius	Arc	Angle	Chord	Bearing
C-1	142.40	154.87'	62°18'35"	147.35'	N. 54°06'40" W.
C-2	146.47	220.16'	86°07'15"	200.01'	N. 42°12'20" W.

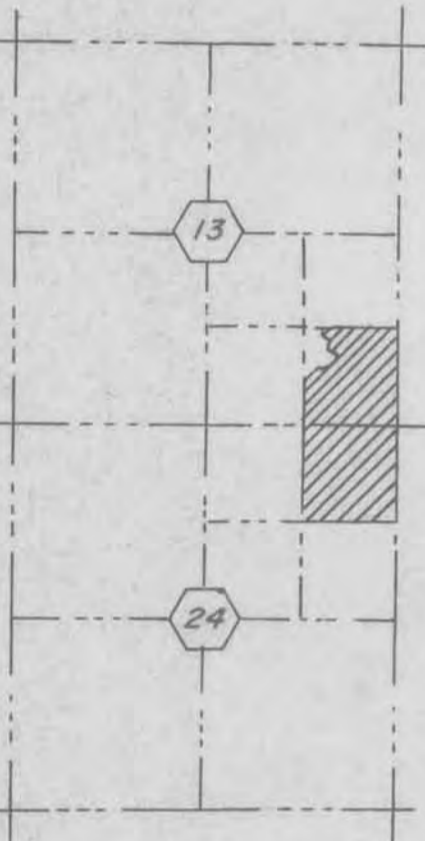

NOTE: FOR THE PURPOSES OF THIS SURVEY, THE EAST LINE OF THE SOUTHEAST QUARTER OF SECTION 13, IS ASSUMED TO BEAR SOUTH 00 DEGREES 41 MINUTES 12 SECONDS WEST.

SURVEYOR'S CERTIFICATE

I, PAUL C. BRASHAW, A WISCONSIN REGISTERED LAND SURVEYOR, NO. S-1509, DO HEREBY CERTIFY THAT I HAVE MADE A SURVEY OF THE ABOVE DESCRIBED PROPERTY, AND THAT I HAVE FOUND AND/OR SET THE SURVEY MONUMENTS, ALL AS SHOWN ON THE ACCOMPANYING PLAT OF SURVEY. IT SHOULD BE NOTED THAT IN THE PERFORMANCE OF THIS SURVEY, THE COURSES AND DISTANCES OF THE SURVEY MAY VARY FROM THE RECORDED CALLS, BASED ON THE EXISTENCE OF FOUND MONUMENTATION, OCCUPATION, OR OTHER CONTROLLING CALLS OR CONDITIONS THAT HAVE OCCURRED IN THE SURVEY OF THIS PROPERTY.

I FURTHER CERTIFY THAT THIS LAND SURVEYING DOCUMENT WAS PREPARED AND THE RELATED SURVEY WORK WAS PERFORMED BY ME OR UNDER MY DIRECT PERSONAL SUPERVISION, AND THAT I AM A DULY REGISTERED LAND SURVEYOR UNDER THE LAWS OF THE STATE OF WISCONSIN.

SIGNED THIS 11th DAY OF December, 1999

Paul C. Brashaw
PAUL C. BRASHAW
WISCONSIN REGISTERED LAND SURVEYOR
NO. S-1509

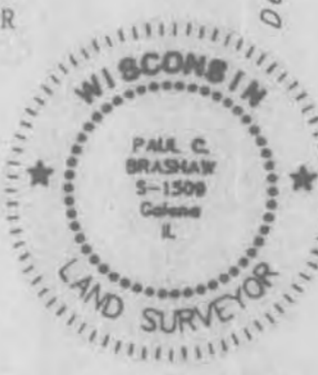

Legend

- 0.00' Measured Distance/Bearing
- (0.00') Platted/Deeded Distance/Bearing
- Boundary of the Property Surveyed
- Existing Fence Line
- 5/8" Iron Rod Set weighing 1.13 lbs/ft.
- Iron Rod/Pipe Found 36" long
- R. R. Spike
- P. K. Nail

Paul C. Brashaw

4413 W. Stagecoach Tr. Galena Illinois 61036
Telephone (815) 777-1172

SURVEYED FOR MARVIN AND ELIZABETH ENRIGHT
P.O. BOX 153
SCALES MOUND, ILLINOIS 61075
TELEPHONE (815) 845-2247

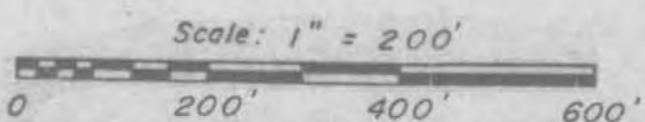

Revised Easement January 28, 2000

Date: December 10, 1999 Sheet 1 of 2

9/64

9/64

MARVIN AND ELIZABETH ENRIGHT
PLAT OF SURVEY
OF

A TRACT OF LAND LOCATED IN A PART OF THE SOUTHEAST QUARTER OF THE SOUTHEAST QUARTER OF SECTION 13, AND ALSO LOCATED IN THE NORTHEAST QUARTER OF THE NORTHEAST QUARTER OF SECTION 24, ALL IN TOWNSHIP 7 NORTH, RANGE 2 WEST OF THE FOURTH PRINCIPAL MERIDIAN, HICKORY GROVE TOWNSHIP, GRANT COUNTY, WISCONSIN, THE BOUNDARY OF SAID TRACT ALONG WITH THE CENTERLINE OF A 33.00 FOOT WIDE EASEMENT FOR INGRESS AND EGRESS BEING MORE PARTICULARLY DESCRIBED AS FOLLOWS:

BEGINNING AT THE NORTHEAST CORNER OF THE NORTHEAST QUARTER OF SECTION 24, TOWNSHIP 7 NORTH, RANGE 2 WEST OF THE FOURTH PRINCIPAL MERIDIAN; THENCE SOUTH 01 DEGREES 15 MINUTES 11 SECONDS WEST, ALONG THE EAST LINE OF THE NORTHEAST QUARTER OF SAID SECTION 24, A DISTANCE OF 1,318.24 FEET TO THE SOUTHEAST CORNER OF THE NORTHEAST QUARTER OF THE NORTHEAST QUARTER OF SAID SECTION 24; THENCE NORTH 89 DEGREES 38 MINUTES 23 SECONDS WEST, ALONG THE SOUTH LINE OF THE NORTHEAST QUARTER OF THE NORTHEAST QUARTER OF SAID SECTION 24, A DISTANCE OF 1,288.38 FEET TO THE SOUTHWEST CORNER OF THE NORTHEAST QUARTER OF THE NORTHEAST QUARTER OF SAID SECTION 24; THENCE NORTH 01 DEGREES 20 MINUTES 49 SECONDS EAST, ALONG THE WEST LINE OF THE NORTHEAST QUARTER OF THE NORTHEAST QUARTER OF SAID SECTION 24, A DISTANCE OF 1,313.17 FEET TO THE NORTHWEST CORNER OF THE NORTHEAST QUARTER OF THE NORTHEAST QUARTER OF SAID SECTION 24; THENCE NORTH 00 DEGREES 03 MINUTES 45 SECONDS EAST, ALONG THE WEST LINE OF THE SOUTHEAST QUARTER OF THE SOUTHEAST QUARTER OF SECTION 13, IN AFORESAID TOWNSHIP AND RANGE, A DISTANCE OF 711.63 FEET TO A POINT IN THE CENTER OF COON VALLEY CREEK; THENCE NORTH 26 DEGREES 42 MINUTES 53 SECONDS EAST, ALONG SAID CREEK CENTER, A DISTANCE OF 37.86 FEET; THENCE NORTH 02 DEGREES 09 MINUTES 57 SECONDS EAST, ALONG SAID CREEK CENTER, A DISTANCE OF 113.34 FEET; THENCE NORTH 73 DEGREES 14 MINUTES 16 SECONDS EAST, ALONG SAID CREEK CENTER, A DISTANCE OF 130.23 FEET; THENCE NORTH 21 DEGREES 53 MINUTES 36 SECONDS EAST, ALONG SAID CREEK CENTER, A DISTANCE OF 84.52 FEET; THENCE NORTH 10 DEGREES 34 MINUTES 05 SECONDS EAST, ALONG SAID CREEK CENTER, A DISTANCE OF 57.05 FEET; THENCE NORTH 61 DEGREES 18 MINUTES 16 SECONDS EAST, ALONG SAID CREEK CENTER, A DISTANCE OF 113.84 FEET; THENCE NORTH 28 DEGREES 36 MINUTES 45 SECONDS EAST, ALONG SAID CREEK CENTER, A DISTANCE OF 70.54 FEET; THENCE NORTH 64 DEGREES 26 MINUTES 21 SECONDS WEST, ALONG SAID CREEK CENTER, A DISTANCE OF 104.44 FEET; THENCE NORTH 15 DEGREES 32 MINUTES 14 SECONDS EAST, ALONG SAID CREEK CENTER, A DISTANCE OF 86.87 FEET; THENCE NORTH 83 DEGREES 21 MINUTES 11 SECONDS WEST, ALONG SAID CREEK CENTER, A DISTANCE OF 93.42 FEET; THENCE NORTH 12 DEGREES 33 MINUTES 52 SECONDS WEST, ALONG SAID CREEK CENTER, A DISTANCE OF 46.96 FEET TO A POINT ON THE NORTH LINE OF THE SOUTHEAST QUARTER OF THE SOUTHEAST QUARTER OF SAID SECTION 13; THENCE SOUTH 89 DEGREES 18 MINUTES 27 SECONDS EAST, ALONG SAID NORTH LINE, A DISTANCE OF 1,153.80 FEET TO THE NORTHEAST CORNER OF THE SOUTHEAST QUARTER OF THE SOUTHEAST QUARTER OF SAID SECTION 13; THENCE SOUTH 00 DEGREES 41 MINUTES 12 SECONDS WEST, ALONG THE EAST LINE OF THE SOUTHEAST QUARTER OF SAID SECTION 13, A DISTANCE OF 1,321.90 FEET TO THE POINT OF BEGINNING, SAID TRACT CONTAINING 75.98 ACRES, MORE OR LESS, SUBJECT TO ANY AND ALL RECORDED EASEMENTS AND RIGHT-OF-WAYS, TOGETHER WITH A 33.00 FOOT WIDE EASEMENT FOR INGRESS AND EGRESS, LYING 16.50 FEET EACH SIDE OF THE

FOLLOWING DESCRIBED EASEMENT CENTERLINE:
COMMENCING AT THE SOUTHEAST CORNER OF THE SOUTHEAST QUARTER OF SAID SECTION 13; THENCE NORTH 89 DEGREES 52 MINUTES 02 SECONDS WEST, ALONG THE SOUTH LINE OF THE SOUTHEAST QUARTER OF SAID SECTION 13, A DISTANCE OF 1,286.32 FEET TO THE SOUTHWEST CORNER OF THE SOUTHEAST QUARTER OF THE SOUTHEAST QUARTER OF SAID SECTION 13; THENCE NORTH 00 DEGREES 03 MINUTES 45 SECONDS EAST, ALONG THE WEST LINE OF THE SOUTHEAST QUARTER OF THE SOUTHEAST QUARTER OF SAID SECTION 13, A DISTANCE OF 545.61 FEET TO THE POINT OF BEGINNING OF A 33.00 FOOT WIDE EASEMENT FOR INGRESS AND EGRESS, LYING 16.50 FEET EACH SIDE OF THE FOLLOWING DESCRIBED CENTERLINE; THENCE SOUTH 54 DEGREES 48 MINUTES 44 SECONDS WEST, ALONG SAID EASEMENT CENTERLINE, A DISTANCE OF 404.84 FEET; THENCE SOUTH 25 DEGREES 22 MINUTES 55 SECONDS WEST, ALONG SAID EASEMENT CENTERLINE, A DISTANCE OF 179.11 FEET; THENCE NORTH 72 DEGREES 34 MINUTES 42 SECONDS WEST, ALONG SAID EASEMENT CENTERLINE, A DISTANCE OF 113.79 FEET; THENCE SOUTH 66 DEGREES 09 MINUTES 48 SECONDS WEST, ALONG SAID EASEMENT CENTERLINE, A DISTANCE OF 210.95 FEET; THENCE NORTH 22 DEGREES 57 MINUTES 21 SECONDS WEST, ALONG SAID EASEMENT CENTERLINE, A DISTANCE OF 45.78 FEET TO A POINT OF CURVE; THENCE CONTINUING NORTHWESTERLY ALONG SAID EASEMENT CENTERLINE, ALONG A CIRCULAR CURVE CONCAVE TO THE WEST, AN ARC DISTANCE OF 154.87 FEET TO A POINT OF TANGENT; SAID CURVE HAVING A RADIUS OF 142.40 FEET, A CENTRAL ANGLE OF 62 DEGREES 18 MINUTES 35 SECONDS, AND WHOSE LONG CHORD BEARS NORTH 54 DEGREES 06 MINUTES 40 SECONDS WEST, 147.35 FEET FROM THE LAST DESCRIBED COURSE; THENCE NORTH 85 DEGREES 15 MINUTES 57 SECONDS WEST, ALONG SAID EASEMENT CENTERLINE, A DISTANCE OF 285.67 FEET TO A POINT OF CURVE; THENCE CONTINUING NORTHWESTERLY ALONG SAID EASEMENT CENTERLINE, ALONG A CIRCULAR CURVE CONCAVE TO THE EAST, AN ARC DISTANCE OF 220.16 FEET TO A POINT OF TANGENT; SAID CURVE HAVING A RADIUS OF 146.47 FEET, A CENTRAL ANGLE OF 86 DEGREES 07 MINUTES 15 SECONDS, AND WHOSE LONG CHORD BEARS NORTH 42 DEGREES 12 MINUTES 20 SECONDS WEST, 200.01 FEET FROM THE LAST DESCRIBED COURSE; THENCE NORTH 00 DEGREES 51 MINUTES 18 SECONDS EAST, ALONG SAID EASEMENT CENTERLINE, A DISTANCE OF 761.75 FEET TO A POINT IN THE CENTERLINE OF NEFF ROAD, SAID POINT ALSO BEING THE POINT OF TERMINUS OF SAID EASEMENT. ALL OF THE ABOVE DESCRIBED PROPERTY BEING SITUATED IN HICKORY GROVE TOWNSHIP, GRANT COUNTY, WISCONSIN.

NOTE: FOR THE PURPOSES OF THIS SURVEY, THE EAST LINE OF THE SOUTHEAST QUARTER OF SECTION 13, IS ASSUMED TO BEAR SOUTH 00 DEGREES 41 MINUTES 12 SECONDS WEST.

SURVEYOR'S CERTIFICATE

I, PAUL C. BRASHAW, A WISCONSIN REGISTERED LAND SURVEYOR, NO. S-1509, DO HEREBY CERTIFY THAT I HAVE MADE A SURVEY OF THE ABOVE DESCRIBED PROPERTY, AND THAT I HAVE FOUND AND/OR SET THE SURVEY MONUMENTS, ALL AS SHOWN ON THE ACCOMPANYING PLAT OF SURVEY. IT SHOULD BE NOTED THAT IN THE PERFORMANCE OF THIS SURVEY, THE COURSES AND DISTANCES OF THE SURVEY MAY VARY FROM THE RECORDED CALLS, BASED ON THE EXISTENCE OF FOUND MONUMENTATION, OCCUPATION, OR OTHER CONTROLLING CALLS OR CONDITIONS THAT HAVE OCCURRED IN THE SURVEY OF THIS PROPERTY.

I FURTHER CERTIFY THAT THIS LAND SURVEYING DOCUMENT WAS PREPARED AND THE RELATED SURVEY WORK WAS PERFORMED BY ME OR UNDER MY DIRECT PERSONAL SUPERVISION, AND THAT I AM A DULY REGISTERED LAND SURVEYOR UNDER THE LAWS OF THE STATE OF WISCONSIN.

SIGNED THIS 11th DAY OF December, 1999

REvised: JANUARY 28, 2000
Paul C. Brashaw
FEBRUARY 1, 2000

PAUL C. BRASHAW
WISCONSIN REGISTERED LAND SURVEYOR
NO. S-1509



REVISED EASEMENT LEGAL DESCRIPTION : JANUARY 28, 2000

SURVEYED FOR MARVIN AND ELIZABETH ENRIGHT
P.O. BOX 153
SCALES MOUND, ILLINOIS 61075
TELEPHONE (815) 845-2247



Paul C. Brashaw
4413 W. Stagecoach Tr. Galena Illinois 61036
Telephone (815) 777-1172