

BRENEMAN'S BLUFFVIEW LAND SURVEYING SERVICES

E 12865 C. T. H. W.
BARABOO, WISCONSIN, 53913
PHONE 608-356-8780

JOHN A. BRENEMAN
R.L.S. 1274
CERTIFIED SURVEY MAPS



PLATTING OF ALL KINDS
RETRACEMENT SURVEYS
TOPOGRAPHIC SURVEYS

CLIENT & OWNER:
STEVEN J. & BARBARA J. BAUMAN
430 NORTH 6TH STREET
MUSCODA WI 53573

PROJECT NO. 2916
APRIL 13, 2001
FILE NO. 29-16
SCALE 1" = 50'
SHEET 1 OF 1

RETRACEMENT PLAT OF SURVEY

PERFORM A RETRACEMENT PLAT OF SURVEY OF WARRANTY DEED VOLUME 787 PAGE 179 AS DESCRIBED VERBATUM AT THE GRANT COUNTY REGISTER OF DEEDS OFFICE. LOTS FIVE (5), SIX (6), ELEVEN (11) AND TWELVE (12), BLOCK ONE HUNDRED THREE (103) ORIGINAL PLAT, VILLAGE OF MUSCODA, GRANT COUNTY WISCONSIN, ALSO THE WEST ONE-HALF (W. 1/2) OF VACATED SEVENTH (7th) STREET ADJOINING LOTS ELEVEN (11) AND TWELVE (12), BLOCK ONE HUNDRED THREE (103), ORIGINAL PLAT, VILLAGE OF MUSCODA, GRANT COUNTY WISCONSIN.

PLATTED AS MUSCODA CEMETERY SEE SURVEY PLAT

(NOT OPEN) PINE STREET Rec. 70' Street HERMAN J. HOVELSRUD S749

EAST - WEST 280.61' Rec. 280' JAN. 3, 1973 60.01' Ex. 2" I.D. iron pipes

24" solid iron rods 1.502 lbs/lin ft
Ex. capped rods

Rec. 50' Lots N. - S.

L-1

L-16

L-2

L-15

Meas. 137.60'
N89° 58' 49"E
140.04'

2.44'

Cor. in tel. ped.

L-3

L-14

BLOCK 103 ORIGINAL PLAT

L-4

L-13

N89° 59' 26"E 140.02'
7,000± Sq. Ft.
LOT FIVE (5)

S89° 59' 56"E
140.27'
7,010± Sq. Ft.
LOT TWELVE (12)

N89° 59' 26"E
140.01'

N89° 59' 56"E
140.20'

6,999± Sq. Ft.
LOT SIX (6)

7,006± Sq. Ft.
LOT ELEVEN (11)

140.01'
N89° 59' 26"E

140.13'

Rec. 50' Lots N. S.

L-7

L-10

L-8

L-9

139.99'

139.99'

N89° 59' 26"E

279.98'

Rec. 70' MAPLE STREET

Rec. 70'

Rec. 280'

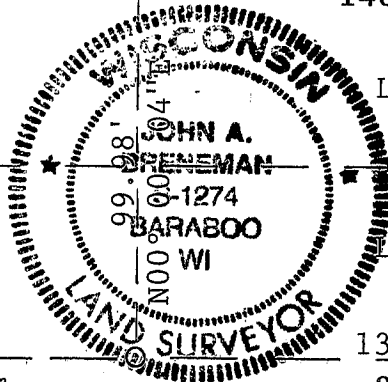

SEE VOLUME 617 DEEDS PAGE 664 NOT WARRANTED

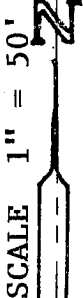

LEGEND:

o = Set 3/4" x 24" solid iron rods 1.502 lbs/lin ft
Ex. capped rods

CERTIFICATE:

I, JOHN A. BRENEMAN, *John A. Breneman*, Registered Land Surveyor of the State of Wisconsin do hereby certify that I have surveyed and mapped the property shown upon this plat and that the within is a true representation of all the exterior boundaries of the land surveyed to the best of my knowledge and belief and that I have fully complied with the provision of A-E7 Wisconsin Administrative Code.

APR 13 2001