

# PLAT OF SURVEY FOR JOHN D. ROSS

OF LOT 42 OF THE FIRST ADDITION TO COVENTRY ESTATES,  
LOCATED IN THE SOUTHEAST QUARTER OF THE NORTHEAST QUARTER  
OF SECTION 10, TOWN 4 NORTH, RANGE 3 WEST, CITY OF LANCASTER,  
GRANT COUNTY, WISCONSIN.

NE CORNER  
SEC. 10,  
T4N, R3W

**SURVEYOR'S CERTIFICATE**

I, BRUCE D. BOWDEN, REGISTERED WISCONSIN LAND SURVEYOR - 1250, AGENT OF BOWDEN SURVEYING, LTD., DO HEREBY CERTIFY THAT I HAVE SURVEYED, DESCRIBED, MAPPED AND MONUMENTED THE PROPERTY SHOWN HEREON IN ACCORDANCE WITH THE INSTRUCTIONS OF BARBARA ZUTZ FOR JOHN D. ROSS AND THAT THIS MAP IS A CORRECT REPRESENTATION THEREOF TO THE BEST OF MY KNOWLEDGE AND BELIEF. PARCEL SHOWN HEREON IS SUBJECT TO ANY AND ALL EASEMENTS AND RIGHTS-OF-WAY OF RECORD AND/OR USAGE.

*Bruce D. Bowden*  
BRUCE D. BOWDEN, R.L.S. - 1250  
AGENT OF BOWDEN SURVEYING, LTD.

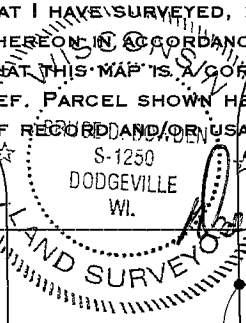

DATE 27, 2000

46  
IF THE SURVEYOR'S STAMP IS NOT RED COLORED AND THE SIGNATURE IS NOT IN BLUE INK, THE MAP SHOULD BE ASSUMED TO BE A COPY AND MAY CONTAIN UNAUTHORIZED ALTERATIONS. THE CERTIFICATE SHOWN HEREON SHALL NOT APPLY TO ANY COPIES.

NOTE: BEARINGS ARE REFERENCED TO THE EAST LINE OF THE NORTHEAST QUARTER OF SEC. 10-T4N-R3W, WHICH BEARS S 0° 34' 33" E ACCORDING TO THE GRANT CO. COORDINATE SYSTEM AS DEFINED BY THE W.D.O.T. AND DETERMINED BY GPS OBSERVATION.



45 1st  
COVENTRY  
44

**LEGEND**

- ⊕ - ALUMINUM MONUMENT - FOUND
- - 2" DIA. IRON PIPE - FOUND
- - No. 6(3/4" DIA.) REBAR - FOUND
- - No. 6(3/4" DIA.) X 24" REBAR - SET
- - No. 10(1 1/4" DIA.) X 30" REBAR - SET
- ( ) - RECORDED AS INFORMATION

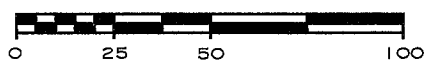

SCALE: 1" = 50'

**BOWDEN SURVEYING, LTD.**  
619 W. MERRIMAC STREET  
DODGEVILLE, WI 53533  
PHONE (608)935-5513

Job No. 20090

