

PLAT OF SURVEY for MAC McKICHAN, JR. of the KOPP PROPERTY

PART OF LOTS 4 AND 5 OF BLOCK 38, ASSESSMENT PLAT OF
THE CITY OF PLATTEVILLE, GRANT COUNTY, WISCONSIN

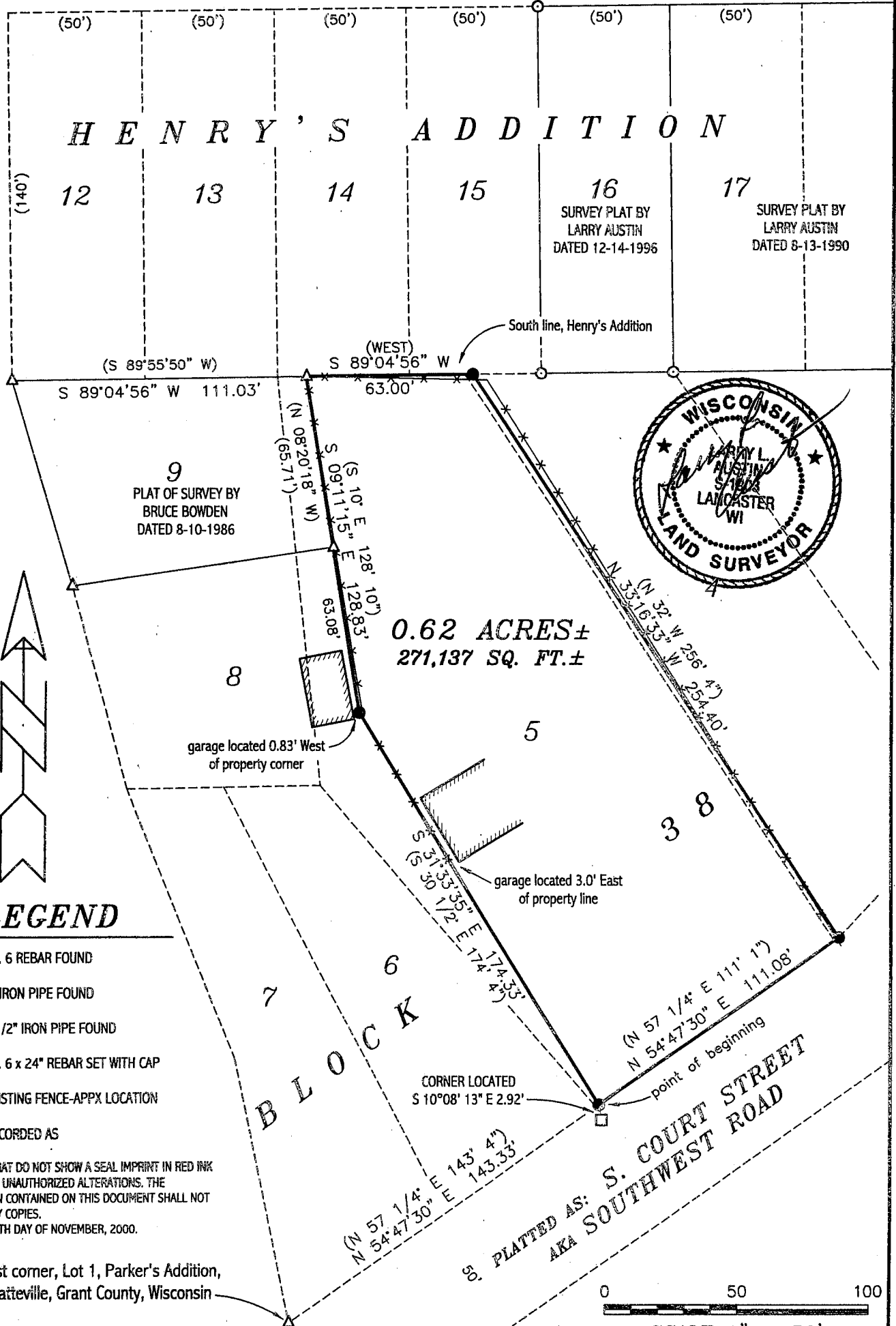

Bearings referenced to the South line of Henry's Addition which is assumed to bear S 89°04'56\" W.

LEGEND

- NO. 6 REBAR FOUND
- △ 1\" IRON PIPE FOUND
- 1 1/2\" IRON PIPE FOUND
- NO. 6 x 24\" REBAR SET WITH CAP
- × × EXISTING FENCE-APPX LOCATION
- () RECORDED AS

ALL PLANS THAT DO NOT SHOW A SEAL IMPRINT IN RED INK MAY CONTAIN UNAUTHORIZED ALTERATIONS. THE CERTIFICATION CONTAINED ON THIS DOCUMENT SHALL NOT APPLY TO ANY COPIES.
DATED THIS 7TH DAY OF NOVEMBER, 2000.

Southeast corner, Lot 1, Parker's Addition,
City of Platteville, Grant County, Wisconsin

0 50 100
SCALE 1\" = 50'

AUSTIN ENGINEERING, LLC
4211 HWY 81 E, LANCASTER, WI 53813
PHONE 608-723-6363 FAX 608-723-6702

FIELDBOOK: 9730
G:\PVILLE\HOMESTD
C:\A\A\PVILLE\AP\BLOCK38\LOT4+5KE

DRAWN BY: AJ AUSTIN
APPROVED: LL AUSTIN
CREW: BS - SB

**PLAT OF SURVEY for MAC McKICHAN, JR.
of the KOPP PROPERTY**

**PART OF LOTS 4 AND 5 OF BLOCK 38, ASSESSMENT PLAT OF
THE CITY OF PLATTEVILLE, GRANT COUNTY, WISCONSIN**

DESCRIPTION PROVIDED:

Begin at the Southeast corner of Lot 1 in Parker's Addition to the Village (now City) of Platteville, Grant County, Wisconsin, according to the recorded map or plat thereof, thence North 57 1/4° East 143 feet 4 inches along the North boundary line of Court Street to an iron stake driven in the ground where this survey begins; thence North 57 1/4° East 111 feet and 1 inch along the North boundary line of Court Street to an iron stake driven in the ground and to the Knox lot; thence North 32° West 256 feet 4 inches along the Southwest side of the Knox lot to an iron stake driven in the ground and to Henry's Addition; thence West 63 feet along the South side of Henry's Addition to a stake driven in the ground; thence South 10° East 128 feet and 10 inches to the middle of a fence post; thence South 30 1/2° East 174 feet 4 inches to Court Street and to the place of beginning. The above described land being a part of Lots 4 and 5 of Block 38 of the Assessment Plat of the City of Platteville Grant County, Wisconsin.

SURVEYOR'S NOTES:

- 1.) THE ORIGINAL DESCRIPTION PROVIDED HAS A MISCLOSURE OF 5.45'.
- 2.) THE EXISTING FENCES SHOWN MEANDER THROUGH THE BRUSH AND TREES.

MORE ACCURATELY DESCRIBED AS FOLLOWS:

Commencing at the Southeast corner of Lot One (1) of Parker's Addition to the Village (now City) of Platteville, Grant County, Wisconsin, according to the recorded map or plat thereof;
Thence North 54° 47' 30" East 143.33' along the North boundary line of Court Street to the point of beginning;
Thence North 54° 47' 30" East 111.08' along said North line;
Thence North 33° 16' 33" West 254.40' along a line of that property as described in Volume 168, Page 641, Grant County Registry;
Thence South 89° 04' 56" West 63.00' along the South line of Henry's Addition to the City of Platteville;
Thence South 09° 11' 15" East 128.83';
Thence South 31° 33' 35" East 174.33' to the point of beginning.

SURVEYOR'S CERTIFICATE:

I, Larry L. Austin, Registered Wisconsin Land Surveyor, hereby certify:

That the above description was surveyed, mapped and monumented as shown on this plat by me or under my direct supervision.

That this survey was prepared under the direction of Mac McKichan Jr.

That to the best of my knowledge and belief, this plat is an accurate representation thereof.

That all plans that do not show a seal imprint in red ink may contain unauthorized alterations.

The certification contained on this document shall not apply to any copies.

Dated this 7th day of November, 2000.

Larry L. Austin, S-1908
