

PLAT OF SURVEY

FOR THOMAS NOWAK AND GERALD STANEK

PARCEL DESCRIPTION

PART OF THE SOUTHEAST QUARTER OF THE NORTHWEST QUARTER AND PART OF THE NORTH HALF OF THE SOUTHWEST QUARTER OF THE NORTHEAST QUARTER, ALL IN SECTION 21, TOWN 7 NORTH, RANGE 1 WEST, CASTLE ROCK TOWNSHIP, GRANT COUNTY, WISCONSIN, BEING MORE PARTICULARLY DESCRIBED AS FOLLOWS:
 COMMENCING AT THE NORTH QUARTER CORNER OF SECTION 21; THENCE S 0° 55' 16" E, 1327.67' TO THE NORTHEAST CORNER OF THE SOUTHEAST QUARTER OF THE NORTHWEST QUARTER AND THE POINT OF BEGINNING;
 THENCE N 89° 58' 56" W, 1316.75' TO A No.6 REBAR AT THE NORTHWEST CORNER THEREOF;
 THENCE S 0° 44' 06" E ON THE WEST LINE THEREOF, 1261.77' TO A RAILROAD SPIKE ON THE CENTER LINE OF COUNTY TRUNK HIGHWAY "G"; THENCE S 45° 25' 24" E, 41.49' TO THE LAST POINT ON SAID CENTER LINE; THENCE N 1° 39' 23" W, 637.83' TO A No.6 REBAR; THENCE N 89° 56' 26" E, 2637.75' TO A No.6 REBAR ON THE EAST LINE OF THE NORTH HALF OF THE SOUTHWEST QUARTER OF THE NORTHEAST QUARTER;
 THENCE N 0° 40' 34" W, 647.84' TO A No.6 REBAR AT THE NORTHEAST CORNER THEREOF;
 THENCE N 89° 54' 08" W, 1340.66' TO A No.6 REBAR AND THE POINT OF BEGINNING. PARCEL CONTAINS 40.05 ACRES (1,744,549 SQUARE FEET), MORE OR LESS, AND IS SUBJECT TO ANY AND ALL EASEMENTS AND RIGHTS-OF-WAY OF RECORD AND/OR USAGE.

NOTE: CORNER FALLS ON NORTH EDGE OF LARGE BOULDER. AN "X" WAS CHISELED INTO THE BOULDER 1 FOOT SOUTH OF THE CORNER LOCATION FOR REFERENCE.

PARCEL AREA
40.05 ACRES +/-
 1,744,549 SQ. FT.

LEGEND

- No. 6(3/4" DIA.) REBAR - FOUND
- 1 1/2" DIA. IRON PIPE - FOUND
- No. 10(1 1/4" DIA.) REBAR - FOUND
- ⊙ GRANT COUNTY ALUMINUM CAP ON No. 6 x 24" REBAR - SET
- No. 6 x 24" REBAR - SET
- ▶ RAILROAD SPIKE - SET
- ⊗ CHISELED "X" ON LARGE BOULDER
- () RECORDED AS INFORMATION

DESCRIPTION OF 33' WIDE EASEMENT

A 33' WIDE EASEMENT FOR INGRESS TO AND EGRESS FROM THE NORTHEAST QUARTER OF THE NORTHEAST QUARTER OF SECTION 21, TOWN 7 NORTH, RANGE 1 WEST, CASTLE ROCK TOWNSHIP, THE WEST AND NORTH WEST LINES BEING MORE FULLY DESCRIBED AS FOLLOWS:
 COMMENCING AT THE NORTH QUARTER CORNER OF SECTION 21; THENCE S 0° 55' 16" E, 1327.67' TO THE NORTHEAST CORNER OF THE SOUTHEAST QUARTER OF THE NORTHWEST QUARTER; THENCE S 89° 54' 08" E, 1340.66' TO A No.6 REBAR AT THE SOUTHWEST CORNER OF THE NORTHEAST QUARTER OF THE NORTHEAST QUARTER AND THE POINT OF BEGINNING OF THE EASEMENT; THENCE S 0° 40' 34" E ON THE WEST LINE OF SAID EASEMENT, 647.84' TO A No.6 REBAR; THENCE S 89° 56' 26" W ON THE NORTH LINE OF SAID EASEMENT, 2637.75' TO A No.6 REBAR; THENCE S 1° 39' 23" E ON THE WEST LINE OF SAID EASEMENT, THROUGH A No. 6 REBAR, 637.83' TO THE CENTER LINE OF COUNTY TRUNK HIGHWAY "G" AND THE TERMINATION OF THE EASEMENT.

NOTE: THE SURVEYED PARCEL IS BEING CONVEYED BY THOMAS NOWAK TO GERALD STANEK, AN ADJOINING LANDOWNER. THE SURVEYED PARCEL IS NOT "LANDLOCKED" BECAUSE MR. STANEK'S LANDS ALREADY ADJOIN C.T.H. "G" AND THIS PARCEL WILL BE CONNECTED TO HIS EXISTING OWNERSHIP.

SURVEYOR'S CERTIFICATE

I, TODD T. RUMMLER, REGISTERED WISCONSIN LAND SURVEYOR - 2443, AGENT OF BOWDEN SURVEYING, LTD., DO HEREBY CERTIFY THAT I HAVE SURVEYED, DESCRIBED, MAPPED AND MONUMENTED THE PROPERTY SHOWN HEREON IN ACCORDANCE WITH THE INSTRUCTIONS OF THOMAS NOWAK AND GERALD STANEK AND THAT THIS MAP IS A CORRECT REPRESENTATION THEREOF TO THE BEST OF MY KNOWLEDGE AND BELIEF.

Todd T. Rummeler
 TODD T. RUMMLER, R.L.S. - 2443
 AGENT OF BOWDEN SURVEYING, LTD.

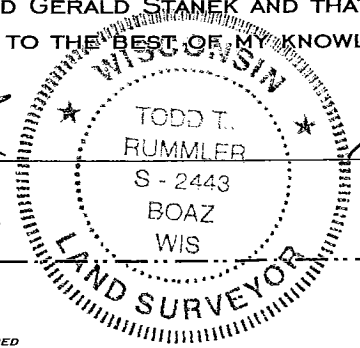

12/2/00
 DATE

IF THIS STAMP IS NOT RED COLORED AND THE SURVEYOR'S SIGNATURE IS NOT IN BLUE INK, THE MAP SHOULD BE ASSUMED TO BE A COPY AND MAY CONTAIN UNAUTHORIZED ALTERATIONS. THE CERTIFICATE SHOWN HEREON SHALL NOT APPLY TO ANY COPIES.

SCALE: 1 INCH = 200 FEET

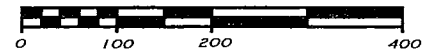

NOTE: BEARINGS ARE REFERENCED TO THE NORTH/SOUTH QUARTER LINE OF SECTION 21, T7N, R1W, WHICH BEARS S 0° 55' 16" E ACCORDING TO THE GRANT COUNTY COORDINATE SYSTEM AS DEFINED BY THE WISCONSIN DEPARTMENT OF TRANSPORTATION AND DETERMINED BY GPS OBSERVATION.

BOWDEN SURVEYING, LTD.
 619 W. MERRIMAC STREET
 DODGEVILLE, WI 53533
 PHONE (608)935-5513

Job No. 20029-A