

MAP OF EASEMENT for JERRY RICHARDSON

DESCRIPTION:

The width of this Easement will be decided by others at a later date:

An Ingress-egress easement located in the Southeast Quarter (SE 1/4) of Section Eight (8), Township Seven (7) North, Range Three (3) West of the 4th P.M., Grant County, Wisconsin, the centerline being described as follows:

Commencing at the South Quarter (S 1/4) corner of said Section Eight (8);
Thence North 02° 20' 26" East 71.03' along the North-South Quarter (N-S 1/4) line of said Section Eight (8);
Thence North 56° 29' 47" East 1985.49' to a 3/4" iron bar marking the Southern most corner of a 1.75 acre survey by Paul Chafer dated 12-20-88;
Thence North 43° 17' 33" West 120.76' along a westerly line of said survey to the point of beginning;
Thence North 24° 19' 56" East 54.10';
Thence Northerly 80.58' on the arc of a curve concave Easterly having a radius of 188.08' and a long chord bearing North 36° 36' 24" East 79.97';
Thence Northerly 75.25' on the arc of a curve concave Westerly having a radius of 55.00' and a long chord bearing North 09° 41' 08" East 69.52';
Thence North 29° 30' 37" West 228.57' to a point in the centerline of Wisconsin Valley Road, said point being the terminus point.

SURVEYOR'S CERTIFICATE:

I, Larry L. Austin, Registered Wisconsin Land Surveyor, hereby certify:
That the above description was surveyed, mapped and monumented as shown on this plat by me or under my direct supervision.
That conformance with local ordinances are not guaranteed with this survey.
That this survey was prepared under the direction of Attorney John McNamee.
That to the best of my knowledge and belief, this plat is an accurate representation thereof.
That all phases undertaken do not show a seal imprint in red ink may contain unauthorized alterations.
The certification contained on this document shall not apply to any copies.
Dated this 23rd day of March, 2000.

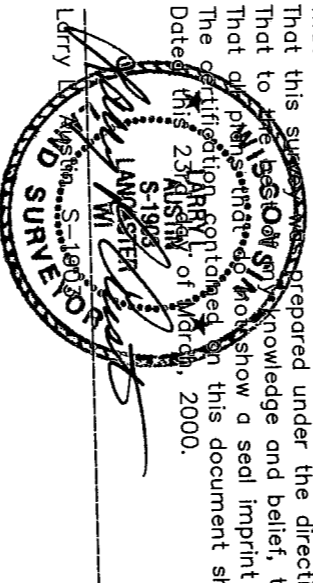

Larry L.

Austin

Registered

Wisconsin

Land

Surveyor

No. S-1903

WI

Surveyor

Seal

Imprint

Red Ink

Unauthorized

Alterations

Apply

To

Copies

AUSTIN ENGINEERING, LLC
4211 HWY 81 E, LANCASTER, WI 53813
PHONE 608-723-6363 FAX 608-723-6702

FIELDBOOK: 9613, 9319
G:\T7NR3W\BOEBEL
C:\SC14\WORK\T7NR3W\08UR

DRAWN BY: AJ AUSTIN
APPROVED: LL AUSTIN
CREW: BS-SB

SHEET 2 OF 2