

SURVEY PLAT

TIM GIELLIS
2222FB9612

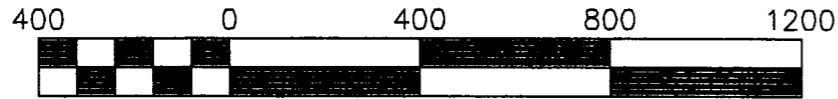

Scale 1" = 400'

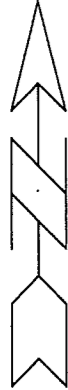

SHOWING THE NORTH LINE OF THE NW 1/4 OF SECTION 31 AND THE NE CORNER OF THE NW 1/4 OF THE NW 1/4 OF SECTION 31 AND RANDOM POINTS ON THE NORTH LINE OF THE NE 1/4 OF THE NW 1/4, ALL OF SECTION 31, T2N, R2W OF THE 4TH P.M., GRANT COUNTY, WISCONSIN.

3/4" X 24" IRON BAR SET

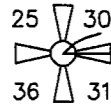

NORTHEAST CORNER
NORTHWEST 1/4,
NORTHWEST 1/4
SECTION 31,
T2NR2W

SW - SW SEC 30
PLATTE VALLEY CO.

SE - SW SEC 30
KOWALSKI & KIELER INC.

CL WEST LANE

EXISTING FIELD ROAD

S 89°59'05" W 1400.62'

S 89°59'05" W 786.84'

S 89°59'05" W
145.09'

S 89°59'05" W
383.20'

NE - NW SEC 31
PLATTE VALLEY CO.

NORTH 1/4 CORNER
SECTION 31, T2N, R2W
4TH P.M., GRANT CO.
WISCONSIN.

3/4" X 24" IRON BAR SET

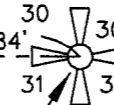

LEGEND

* 3/4" X 24" IRON BAR SET

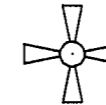

GOVERNMENT CORNER AS NOTED

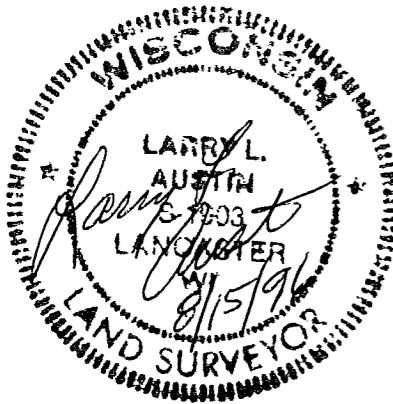

SURVEYOR'S CERTIFICATE:
I, LARRY L. AUSTIN, REGISTERED WISCONSIN LAND SURVEYOR, DO HEREBY CERTIFY THAT THIS SURVEY WAS PERFORMED BY ME OR UNDER MY DIRECT SUPERVISION IN ACCORDANCE WITH THE INSTRUCTIONS OF TIM GIELLIS AND TO THE BEST OF MY KNOWLEDGE AND BELIEF, THIS PLAT IS AN ACCURATE REPRESENTATION THEREOF.

PREPARED BY:

AUSTIN ENGINEERING
LARRY L. AUSTIN, RLS 1903
4211 STH 81 E
LANCASTER, WI 53813
PHONE: 608-723-6363
FAX: 608-723-6702

DRAWN BY: AJ AUSTIN	REVISIONS
DATE: 8-14-96	
DWG. NO.: 2222FB9612	CREW: BS-DK
APPROVED BY: LL AUSTIN	File name: C:\EPSA\PROGRAM\T2NR2W