

# PLAT OF SURVEY for RON STEGER

All plans that do not show seal imprint in red ink may contain unauthorized alterations. The certification contained on this document shall not apply to any copies. Dated this 19th day of November, 1999.

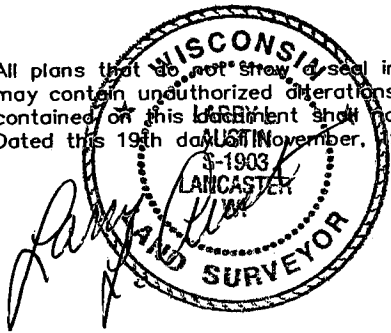

Northeast corner, Section 25, T6N R1W, Existing Aluminum Monument in casing

Point previously described as 13 chains North of the Southeast corner of the East 1/2 of the Northeast 1/4, Section 25, T6N R1W

Former South line of the Chicago and Northwestern Railway property  
(EASTERLY)  
N 81°32'47" E 202.18'

Bearings referenced to the East line of the NE 1/4 of Section 25 which is assumed to bear N 00°01'15" W.

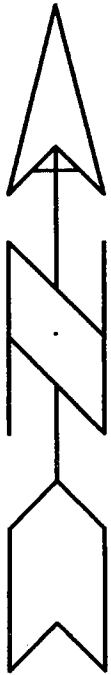

**PARCEL "A"**  
0.60 Acres ±  
26,062 Sq Ft ±

Point of Beginning Parcel "A" and "B"

**PARCEL "B"**  
0.64 Acres ±  
28,106 Sq Ft ±

## LEGEND

- ⊕ Section corner - as designated
- Set No. 6 x 24" rebar with cap
- Existing No. 6 rebar
- ( ) Recorded as

50 0 50 100



SCALE 1" = 50'

### NOTE:

This survey is a split of that property as described in Volume 611, Page 442, Grant County Registry.

East 1/4 corner, Section 25, T6N R1W, 4th P.M., Grant County Wisconsin-Existing Aluminum cap in concrete casing

**AUSTIN ENGINEERING, LLC**  
4211 HWY 81 E, LANCASTER, WI 53813  
PHONE 608-723-6363 FAX 608-723-6702

FIELDBOOK: 9724  
G: \MONTFORT\MONTFORT  
C: \EPSA\PROGRAM\T6NR1W\25RS

DRAWN BY: AJ AUSTIN  
APPROVED: LL AUSTIN  
CREW: BS - SB

# PLAT OF SURVEY for RON STEGER

## PARCEL "A" - NORTH PARCEL

A parcel of land located in the Southeast Quarter (SE 1/4) of the Northeast Quarter (NE 1/4) of Section Twenty-five (25), Township Six (6) North, Range One (1) West of the 4th P.M., Grant County, Wisconsin, said parcel being described as follows:

Commencing at the East Quarter (E 1/4) corner of said Section Twenty-five (25);

Thence North 00° 01' 15" West 713.74' along the East line of said Section Twenty-five (25) to the point of beginning;

Thence South 89° 58' 45" West 200.00' to the West line of that property as described in Volume 611, Page 442, Grant County Registry;

Thence North 00° 01' 15" West 115.48' along the West line of said property;

Thence North 81° 32' 47" East 202.18' along the North line of said property;

Thence South 00° 01' 15" East 145.14' along the East line of said Section Twenty-five (25) to the point of beginning, containing 0.60 acres, more or less, and being subject to any and all easements of record and/or usage.

## PARCEL "B" - SOUTH PARCEL

A parcel of land located in the Southeast Quarter (SE 1/4) of the Northeast Quarter (NE 1/4) of Section Twenty-five (25), Township Six (6) North, Range One (1) West of the 4th P.M., Grant County, Wisconsin, said parcel being described as follows:

Commencing at the East Quarter (E 1/4) corner of said Section Twenty-five (25);

Thence North 00° 01' 15" West 713.74' along the East line of said Section Twenty-five (25) to the point of beginning;

Thence South 89° 58' 45" West 200.00' to the West line of that property as described in Volume 611, Page 442, Grant County Registry;

Thence South 00° 01' 15" East 127.86' along the West line of said property;

Thence North 89° 58' 45" East 200.00' along the South line of said property;

Thence North 00° 01' 15" West 127.86' along the East line of said Section Twenty-five (25) to the point of beginning, containing 0.64 acres, more or less, and being subject to any and all easements of record and/or usage.

## SURVEYOR'S CERTIFICATE:

I, Larry Austin, registered land surveyor, do hereby certify:

That the above description was surveyed, mapped and monumented by me or under my direct supervision.

That conformance with local ordinances are not guaranteed with this survey.

That this survey was prepared under the direction of Ron Steger.

That to the best of my knowledge and belief, this plat is an accurate representation thereof.

That all plans that do not show a seal imprint in red ink may contain unauthorized alterations.

The certification contained on this document shall not apply to any copies.

Dated this 19th day of November, 1999.

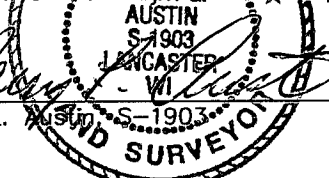
  
Larry L. Austin, S-1903