

PLAT OF SURVEY for JAMES BOTTOMLEY

Located in part of Block "M" of Rountree's Eastern Addition and part of Lot 12 of Prospect Park Addition to the City of Platteville, Grant County, Wisconsin



SCALE 1" = 60'

Northwest corner, Lot 1, Block "M", Rountree's Eastern Addition to the City of Platteville, Grant County, Wisconsin
Point of beginning

platted as: LAURA STREET

platted as: WATER STREET
platted as: LYDIA STREET

platted as: ELLEN STREET

Rountree's Eastern Addition

Block "M"

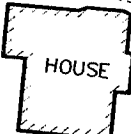
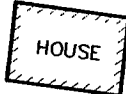

0.88 Acres±
38,392 Sq. Ft.±

[671-936]

[784-505]

Prospect Park

Bearings referenced to the West line of Block "M" of Rountree's Eastern Addition which is assumed to bear S 06°41'22" W.



All plans that do not show a seal imprint in red ink may contain unauthorized alterations. The certification contained on this document shall not apply to any copies. Dated this 23rd day of July, 1999.

LEGEND

- NO. 6 x 24" REBAR SET WITH CAP
- EXISTING NO. 6 REBAR
- △ 1" IRON PIPE FOUND
- STONE MONUMENT FOUND
- ⊗ 1/4" DRILL HOLE IN CONCRETE PLACED
- () RECORDED AS
- [-] PROPERTY DESCRIBED IN VOLUME AND PAGE, GRANT COUNTY REGISTRY

PLAT OF SURVEY for JAMES BOTTOMLEY

Located in part of Block "M" of Rountree's Eastern Addition
and part of Lot 12 of Prospect Park Addition to the
City of Platteville, Grant County, Wisconsin

DESCRIPTION OF LAND SURVEYED:

A parcel of land located in part of Lots One (1), Two (2), Three (3) of Block "M" of Rountree's Eastern Addition and part of Lot Twelve (12) of Prospect Park Addition to the City of Platteville, Grant County, Wisconsin, said parcel being described as follows:

Commencing at a no. 6 rebar marking the Northwest corner of Lot One (1) of said Block "M", said rebar marking the point of beginning;

Thence South 06° 41' 22" West 242.00' along the West line of that property as described in Volume 671, Page 936, Grant County Registry to a no. 6 rebar;

Thence South 84° 11' 14" East 94.82' along the South line of said property to a no. 6 rebar;

Thence South 84° 11' 14" East 200.00' along the South line of that property as described in Volume 784, Page 505, Grant County Registry to a no. 6 rebar;

Thence North 06° 38' 45" East 86.00' along the East line of said property to a 1/4" drill hole in concrete;

Thence North 84° 11' 14" West 200.00' along the North line of said property to a no. 6 rebar;

Thence North 84° 11' 14" West 6.19' along a line of that property as described in said Volume 671, Page 936 to a no. 6 rebar;

Thence North 06° 41' 22" East 138.58' along an East line of said property to a no. 6 rebar;

Thence North 73° 02' 04" West 90.00' along the North line of said property to the point of beginning, containing 0.88 acre, more or less, and being subject to any and all easements of record and/or usage.

SURVEYOR'S CERTIFICATE:

I, Larry Austin, registered land surveyor, do hereby certify:

That the above description was surveyed, mapped and monumented by me or under my direct supervision.

That conformance with local ordinances are not guaranteed with this survey.

That this survey was prepared under the direction of Arnie Roper, agent.

That to the best of my knowledge and belief, this plat is an accurate representation thereof.

That all plans that do not show a seal imprint in red ink may contain unauthorized alterations.

The certification contained on this document shall not apply to any copies.

Dated this 25th day of July, 1999

Larry L. Austin,

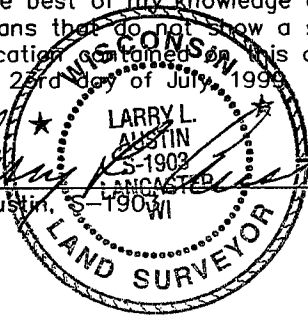

SHEET 2 OF 2

AUSTIN ENGINEERING, LLC
4211 HWY 81 E, LANCASTER, WI 53813
PHONE 608-723-6363 FAX 608-723-6702

FIELDBOOK: 9739
G: \PVILLE\WEYGNTS2
C: \EPSA\PROGRAM\PVILLE\RNTREE\BLKMJB

DRAWN BY: AJ AUSTIN
APPROVED: LL AUSTIN
CREW: BS-SB-MS