

# PLAT OF SURVEY of CHRIS MULROONEY LANDS

LOCATED IN THE SW 1/4 OF THE SE 1/4, SOUTH 1/2 OF THE SW 1/4 OF SECTION 9 AND THE SE 1/4 OF THE SE 1/4 OF SECTION 8, T6N R4W, 4TH P.M., GRANT COUNTY, WISCONSIN

### DESCRIPTION PROVIDED - PREVIOUSLY DESCRIBED AS:

The South Half (S.1/2) of the Southeast Quarter (S.E.1/4) of Section Eight (8); the South Half (S.1/2) of the Southwest Quarter (S.W.1/4) of Section Nine (9); all in Township Six (6) North, Range Four (4) West of the 4th P.M., Grant County, Wisconsin.

EXCEPT the following described tract of land:  
Beginning at the Quarter Section corner on the South line of said Section 9;  
thence North on the Quarter Section line 87 1/4 rods;  
thence South 35° West 28 rods;  
thence South 43° West 29 rods and 2 1/2 feet;  
thence South 1 1/2° East 22 rods and 13 feet;  
thence East on the South line of said Section 9 35 1/4 rods to the place of beginning.

Also including a tract of land described as follows:  
Beginning at a point on the North and South quarter Section line running through the center of said Section 9, 67 1/4 rods North of the Quarter corner on the South line of said Section 9;  
thence North 12 3/4 rods;  
thence East on the North line of the S.W. 1/4 of the S.E. 1/4 of said Section 9, 6 rods;  
thence South 23 1/2° West 13 rods and 14 1/2 feet to the place of beginning, all in the S.W.1/4 of the S.E.1/4 of said Section 9.

Also EXCEPTING that part of the Southeast Quarter (S.E.1/4) of said Section 8 described as follows:  
Commencing at the East Quarter corner of Section Seventeen (17);  
thence North 07° 38' West 2904.82 feet;  
thence North 71° 46' West 90.70 feet to a 1 inch diameter iron pipe and the point of beginning;  
thence North 79° 36' West 71.34 feet to a 1 inch diameter iron pipe;  
thence North 33° 51' West 59.47 feet to a 1 inch diameter iron pipe;  
thence North 02° 52' East 95.61 feet to a 1 inch diameter iron pipe;  
thence South 84° 59' East 54.09 feet to a 1 inch diameter iron pipe;  
thence North 03° 24' East 17.68 feet to a 1 inch diameter iron pipe;  
thence South 87° 04' East 49.17 feet to a 1 inch diameter iron pipe;  
thence South 03° 42' West 64.68 feet to a 1 inch diameter iron pipe;  
thence South 12° 24' West 18.52 feet to a 1 inch diameter iron pipe;  
thence South 05° 57' East 64.03 feet to a 1 inch diameter iron pipe;  
thence South 10° 25' West 22.20 feet to the point of beginning, containing 0.35 acres, more or less.

Also EXCEPTING that part of the South Half (S.1/2) of the Southeast Quarter (S.E.1/4) of said Section 8, which lies West of Highway #133.

### MORE ACCURATELY DESCRIBED AS FOLLOWS:

A parcel of land located in the Southwest Quarter (SW 1/4) of the Southeast Quarter (SE 1/4), the South Half (S 1/2) of the Southwest Quarter (SW 1/4) of Section Nine (9), and the Southeast Quarter (SE 1/4) of the Southwest Quarter (SE 1/4) of Section Eight (8), Town Six (6) North, Range Four (4) West of the 4th P.M., Grant County, Wisconsin, said parcel being described as follows:  
Commencing at the Southwest corner of said Section Nine, said corner being the point of beginning;  
Thence North 89°52'57" West 368.59' along the South line of said Section Eight to a point in the centerline of State Trunk Highway #133;  
Thence Northerly 539.43' on the arc of a curve concave Westerly having a radius of 2960.75' and a long chord bearing North 01°58'58" East 538.61' to a point in said centerline;  
Thence North 03°14'12" West 253.71' to a point in said centerline;  
Thence Northerly 534.34' on the arc of a curve concave Easterly having a radius of 2083.54' and a long chord bearing North 03°46'16" East 532.88' to a point in said centerline and on the North line of the Southeast Quarter of the Southwest Quarter of said Section Eight;  
Thence South 89°52'32" East 336.60' to the Northwest corner of the South Half of the Southwest Quarter of said Section Nine;  
Thence North 89°46'04" East 2631.00' along the North line of the South Half of the Southwest Quarter of said Section Nine to the Northeast corner thereof;  
Thence North 89°49'09" East 99.00' (previously recorded as East 6 rods) along the North line of the Southwest Quarter of said Section Nine;  
Thence South 25°22'30" West 232.89' (previously recorded as South 23 1/2° West 13 rods 14 1/2 feet);  
Thence South 34°58'06" West 483.55' (previously recorded as South 35° West 28 rods);  
Thence South 42°58'14" West 482.65' (previously recorded as South 43° West 29 rods 2 1/2 feet);  
Thence South 01°20'25" East 378.25' (previously recorded as South 1 1/2° East 22 rods 13 feet) to the South line of said Section Nine;  
Thence South 89°39'22" West 2052.44' along the South line of said Section Nine to the point of beginning and being subject to any and all easements of record and/or usage.

### SURVEYOR'S CERTIFICATE:

I, Larry Austin, registered land surveyor, do hereby certify:  
That the description hereon was surveyed, mapped and monumented by me or under my direct supervision.  
That the survey was prepared under the direction of Arnie Roper of Century 21.  
That to the best of my knowledge and belief, this plat is an accurate representation thereof.  
That all plans that do not show a clear and distinct imprint in red ink may contain unauthorized alterations.  
The certification contained on this document shall not apply to any copies.  
Dated this 12th day of March 1999.

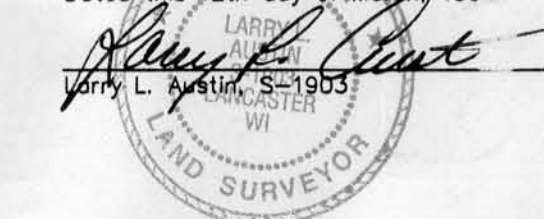

### LEGEND

- NO. 8 x 30" REBAR SET WITH GRANT COUNTY ALUMINUM CAP
- NO. 6 x 24" REBAR SET WITH CAP
- EXISTING ALUMINUM MONUMENT
- EXISTING ANGLE IRON POST IN CONCRETE
- EXISTING NO. 6 REBAR
- ▲ EXISTING 1" IRON PIPE
- EXISTING 1.5" IRON PIPE
- EXISTING FENCE
- ( ) RECORDED AS



SCALE 1" = 300'

BEARINGS REFERENCED TO THE SOUTH LINE OF THE SW 1/4 OF SECTION 9 WHICH IS ASSUMED TO BEAR S 89°39'22" W.

### NOTES:

RIGHT OF WAY ESTABLISHED FROM PLAT OF RIGHT OF WAY PROJECT T0335(1).

THE EXTERIOR OF SECTION 9 WAS RETRACED FROM A PLAT OF SURVEY FOR WALTER VAN VALKENBERG BY LAUFENCE SCHMIT DATED 10/25/1978.

### R.O.W. TABULATION

- ① ARC=542.32' RAD=3010.73' L.C.=N 01°58'58" E 541.51'
- ② N 03°14'12" W 254.06'
- ③ ARC=531.24' RAD=2033.14' L.C.=N 03°46'16" E 529.71'

WEST 1/4 CORNER, SECTION 9 AS SHOWN ON THE SHEET DATED 8/26/1998 BY MICHAEL LAROSA LOCATED S 84°05'56" W 32.21' FROM NO. 8 REBAR WITH GRANT COUNTY ALUMINUM CAP -SEE THE SHEET BY LARRY AUSTIN-

81.28 ACRES ±

### PLAT OF SURVEY of CHRIS MULROONEY LANDS

LOCATED IN THE SW 1/4 OF THE SE 1/4, SOUTH 1/2 OF THE SW 1/4 OF SECTION 8 AND THE SE 1/4 OF THE SE 1/4 OF SECTION 9, T6N R4W, 4TH P.M., GRANT COUNTY, WISCONSIN

AUSTIN ENGINEERING, LLC  
4211 HWY 81 E, LANCASTER, WI 53819  
PHONE 608-783-6363 FAX 608-783-8702

FIELDBOOK: SDR33  
C:\TBR\RAW\09  
C:\EPSA\PROGRAM\T6N4W\09CM  
DRAWN BY: AJ AUSTIN  
APPROVED: LL AUSTIN  
CREW: BS - SB