

PLAT OF SURVEY for GLENDON STASKAL

DESCRIPTION:

A parcel of land located in the Southwest Quarter (SW 1/4) of the Southeast Quarter (SE 1/4) of Section Five (5), Town Seven (7) North, Range Two (2) West of the 4th P.M., Grant County, Wisconsin, said parcel being described as follows:
 Commencing at the South Quarter (S 1/4) corner of said Section Five (5);
 Thence South 89°52'06" East 608.40' along the South line of said Section Five (5) to the point of beginning.
 Thence South 89°52'06" East 714.44' along the South line of said Section Five (5) to the Southeast (SE) corner of the Southwest Quarter (SW 1/4) of the Southeast Quarter (SE 1/4) of said Section Five (5);
 Thence North 00°40'39" West 1040.80' along the East line of the Southwest Quarter (SW 1/4) of the Southeast Quarter (SE 1/4) of said Section Five (5);
 Thence North 89°52'07" West 792.52';
 Thence South 04°57'48" East 1044.82' to the point of beginning, containing 18.001 acres, more or less, and being subject to any and all easements of record and/or usage.

SURVEYOR'S CERTIFICATE:

I, Larry Austin, registered land surveyor, do hereby certify:
 That the above description was surveyed, mapped and monumented by me or under my direct supervision.
 That conformance with local ordinances are not guaranteed with this survey.
 That this survey was prepared under the direction of Glendon Staskal.
 That to the best of my knowledge and belief, this plat is an accurate representation thereof.
 That all plans that do not show a seal imprint in red ink may contain unauthorized alterations.
 The certification contained on this document shall not apply to any copies.
 Dated this 25th day of February, 1999.

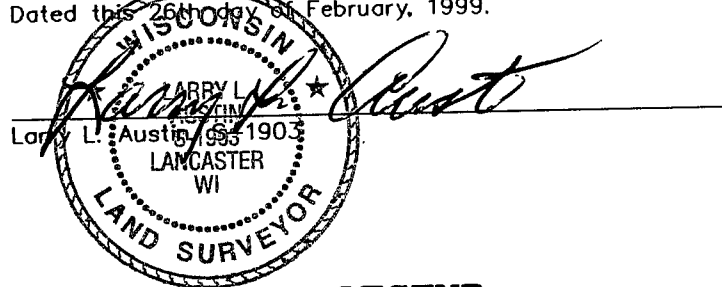

LEGEND

- ⊕ EXISTING NO. 6 REBAR
- ⊙ NO. 8 X 30" REBAR SET WITH GRANT COUNTY ALUMINUM CAP
- NO. 6 X 24" REBAR SET WITH CAP
- x x x - EXISTING FENCE



S 00°40'15" E 5393.48'

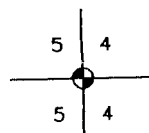

SOUTH 1/4 CORNER, SEC. 5, T7N R2W, 4TH P.M., GRANT COUNTY, WISCONSIN

