

RECEIVED MAR 19 1999

84

SHEET 1 OF 2

# SURVEY PLAT

- BILL BARNS  
- 6230FB9518PW11

Of a parcel of land located in the Northeast 1/4 of the Northwest 1/4 of Section 30, T 6 N, R 2 W of the 4th P.M., Grant County, Wisconsin, said parcel being more particularly described as follows:

Commencing at the North 1/4 corner of Section 30, T 6 N, R 2 W of the 4th P.M., Grant County, Wisconsin, said corner being the point of beginning;

thence S 01° 48' 16" W 1327.99' along the North-South 1/4 line of said Section 30 to the Southeast corner of the Northeast 1/4 of the Northwest 1/4;

thence N 88° 03' 57" W 459.48' along the South line of the Northeast 1/4 of the Northwest 1/4 of said Section 30;

- thence N 18° 49' 59" W 501.92';
- thence N 07° 18' 52" E 485.82';
- thence N 26° 48' 45" E 294.18';
- thence N 46° 25' 44" E 67.63';
- thence N 01° 48' 16" E 60.00' to the North line of the Northwest

1/4 of said Section 30;  
thence S 88° 02' 50" E 417.86' along the North line of said Northwest 1/4 to the point of beginning, containing 17.007 acres, more or less, inclusive of R.O.W.'s and being subject to any and all easements of record, including, but not limited to a R.O.W. for U.S.H. "61" as shown on the attached plat.

SURVEYOR'S CERTIFICATE: I, Larry L. Austin, Registered Wisconsin Land Surveyor, do hereby certify that the above survey, description, and plat were prepared by me or under my direct supervision, in accordance with the instructions of Bill Barns of Fennimore, and to the best of my knowledge and belief, this plat is an accurate representation thereof.

*Larry L. Austin*  
 \_\_\_\_\_  
 LARRY L. AUSTIN                      RLS 1903  
 AUSTIN ENGINEERING  
 RT. 2  
 LANCASTER, WI 53813  
 PHONE (608) 723-6363

4/14/96  
DATE

BEARING REFERENCE: For purposes of this survey bearings are referenced to the North line of the Northwest 1/4 which assumed to bear S 88° 02' 50" E.

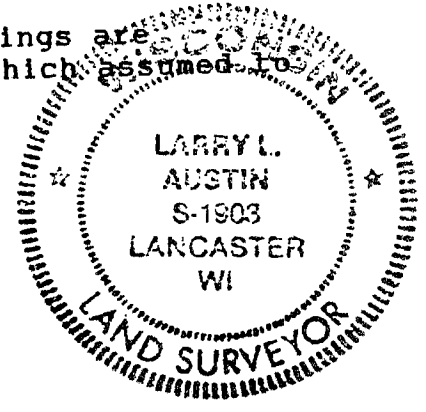

# SURVEY PLAT

- BILL BARNS  
- 6230FB9518PW11

