

RECEIVED FEB 12 1999

Sec 13, Town 5 N, Range 1 West

63

PLAT OF SURVEY for RON IVERSON

PARCEL "A"

A parcel of land located in the Southeast 1/4 of the Southeast 1/4 of Section 13, Town 5 North, Range 1 West of the 4th P.M., Grant County, Wisconsin, said parcel being described as follows:
 Commencing at the Southeast corner of said Section 13;
 Thence N 00°01'03" E 747.68' along the East line of said Section 13;
 Thence N 88°36'07" W 1016.82' along the North line of Woodward Avenue and it's extension thereof to the Westerly line of the right-of-way line of the old Chicago & Northwestern Railroad, and the point of beginning;
 Thence N 35°38'39" W 349.16' along said Westerly right-of-way line;
 Thence N 54°21'21" E 157.64';
 Thence S 35°25'48" E 319.69';
 Thence S 88°36'07" E 54.56' to the Easterly right-of-way line of the old Chicago & Northwestern Railroad;
 Thence S 30°42'13" E 139.02' to the extension of the North line of said Woodward Avenue;
 Thence N 88°36'07" W 235.57' along said Northerly extension to the point of beginning, containing 1.60 acres, more or less, and being subject to any and all easements of record and/or usage.

PARCEL "B"

A parcel of land located in the Southeast 1/4 of the Southeast 1/4 of Section 13, Town 5 North, Range 1 West of the 4th P.M., Grant County, Wisconsin, said parcel being described as follows:
 Commencing at the Southeast corner of said Section 13;
 Thence N 00°01'03" E 747.68' along the East line of said Section 13;
 Thence N 88°36'07" W 1016.82' along the North line of Woodward Avenue and it's extension thereof to the Westerly right-of-way line of the old Chicago & Northwestern Railroad;
 Thence N 35°38'39" W 349.16' along said Westerly right-of-way to the point of beginning;
 Thence N 54°21'21" E 157.64';
 Thence N 35°25'48" W 72.64' to the Southeast corner of a 1.043 acre survey by Matthew Janiak dated March 30, 1983;
 Thence S 54°21'21" W 157.91' along said survey to the Southwest corner thereof;
 Thence S 35°38'39" E 72.64' along the Westerly right-of-way line of the old Chicago & Northwestern Railroad to the point of beginning containing 0.26 acres, more or less, and being subject to any and all easements of record and/or usage.

PARCEL "C"

A parcel of land located in the Southeast 1/4 of the Southeast 1/4 of Section 13, Town 5 North, Range 1 West of the 4th P.M., Grant County, Wisconsin, said parcel being described as follows:
 Commencing at the Southeast corner of said Section 13;
 Thence N 00°01'03" E 747.68' along the East line of said Section 13;
 Thence N 88°36'07" W 766.25' along the North line of Woodward Avenue and it's extension thereof to the Easterly line of the right-of-way line of the old Chicago & Northwestern Railroad, and the point of beginning;
 Thence N 88°36'07" W 15.00' along the extension of said Woodward Avenue;
 Thence N 30°42'13" W 139.02' to the Easterly right-of-way line of said Railroad;
 Thence S 35°38'39" E 147.54' along said Easterly right-of-way line to the point of beginning, containing 0.02 acre, more or less, and being subject to any and all easements of record and/or usage.

SURVEYOR'S CERTIFICATE:

I, Larry L. Austin, registered land surveyor, do hereby certify:
 That the description hereon was surveyed, mapped, and monumented by me or under my direct supervision.
 That conformance with local ordinances are not guaranteed with this survey.
 That this survey was prepared under the direction of Ron Iverson.
 That to the best of my knowledge and belief, this plat is an accurate representation of the land.

Dated this 5th day of January, 1999.
 Revised this 20th day of January, 1999.
 Revised this 26th day of January, 1999.

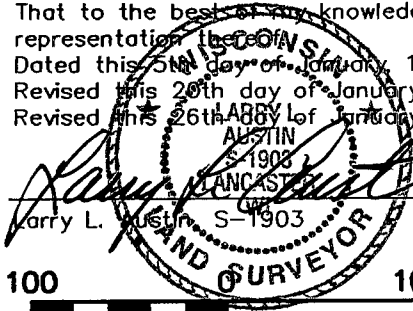

SCALE 1" = 100'

BEARINGS REFERENCED TO THE EAST LINE OF THE SE 1/4 WHICH IS ASSUMED TO BEAR N 00°01'03" E.

LEGEND

- NO. 6 X 24" REBAR SET WITH CAP
- ⊕ EXISTING 1 1/4" IRON ROD
- ⊕ EXISTING 1" IRON ROD
- ⊕ EXISTING 1" IRON PIPE
- ⊕ EXISTING RAILROAD SPIKE
- ⊕ EXISTING DRILL HOLE
- - - EXISTING FENCE
- () RECORDED AS

