

RECEIVED JAN 8 1999

Village of Montfort Sec. 25, T6N, R1 West

# MAP OF EASEMENT for THE VILLAGE OF MONTFORT

54

TERMINUS POINT  
EASEMENT

24 24  
25 25

NORTH 1/4 CORNER, SECTION 25,  
T6N R1W, 4TH P.M., GRANT CO., WI

**DESCRIPTION OF EASEMENT:**  
 A 20' WIDE SANITARY SEWER EASEMENT, THE CENTERLINE BEING DESCRIBED AS FOLLOWS:  
 COMMENCING AT THE NORTH 1/4 CORNER, SECTION 25, TOWN 6 NORTH, RANGE 1 WEST OF THE 4TH P.M., GRANT COUNTY, WISCONSIN;  
 THENCE S 00°32'26" W 2598.05' ALONG THE WEST LINE OF THE NORTHEAST 1/4 OF SAID SECTION 25;  
 THENCE S 89°52'47" E 1084.56' TO THE POINT OF BEGINNING;  
 THENCE N 00°52'23" W 239.75' TO THE TERMINUS POINT.

**SURVEYOR'S CERTIFICATE:**  
 I, LARRY L. AUSTIN, REGISTERED WISCONSIN LAND SURVEYOR, DO HEREBY CERTIFY:  
 THAT THE ABOVE DESCRIPTION WAS SURVEYED AND MAPPED BY ME OR UNDER MY DIRECT SUPERVISION.  
 THAT THIS EASEMENT WAS PREPARED UNDER THE DIRECTION OF THE VILLAGE OF MONTFORT.  
 THAT TO THE BEST OF MY KNOWLEDGE AND BELIEF, THIS MAP IS AN ACCURATE REPRESENTATION THEREOF.  
 DATED THIS 8TH DAY OF AUGUST, 1998.

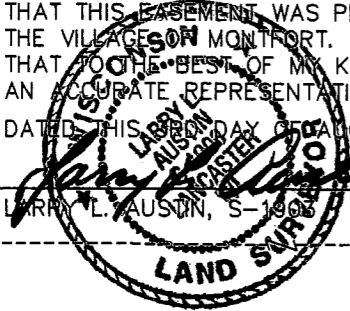

JOHNSON STREET SURVEYS  
BY LARRY AUSTIN

(VET CLINIC)

SCALE 1" = 50'

### LEGEND

- EXISTING ALUMINUM MONUMENT
- EXISTING SANITARY SEWER MANHOLE
- ⊙ EXISTING NO. 6 REBAR
- 2" IRON PIPE FOUND

BEARINGS REFERENCED TO THE WEST LINE OF THE NORTHWEST 1/4 WHICH IS ASSUMED TO BEAR S 00°32'26" W.

2658.53'

2598.05'

S 00°32'26" W

25 25  
25 25

S 89°52'47" E 1084.56'

U.S.H.

10' 10'

N 00°52'23" W 239.75'

10' 10'

"18"

POINT OF BEGINNING  
CENTERLINE OF 20' WIDE  
SANITARY SEWER EASEMENT

AUSTIN ENGINEERING, LLC.  
 4211 HWY 81E, LANCASTER, WI 53813  
 PHONE 608-723-6363 FAX 608-723-6702

FIELDBOOK: 9724  
 C:\SURVEY3\MONTFORT\MONTFORT  
 C:\EPSA\PROGRAM\T6NR1W\WCSWR

DRAWN BY: AJ AUSTIN  
 APPROVED: LL AUSTIN  
 CREW: BS - SB