

Dec 12, T1N, R2W
SURVEY PLAT REC'D APR 8 1998

28

- CORA HAVERLAND
 - DD19FB9411PW6

Of land located in the NW 1/4 of Section 12, T 1 N, R 2 W of the 4th P.M., Grant County, Wisconsin, said parcel purported to be that property described in Volume 341, at Page 173, Grant County Registry, Lancaster, Wi., and said parcel now being split into two parcels, said parcels being more particularly described as follows:

PARCEL 1 (NORTH PARCEL)

Commencing at the NW corner of Section 12, T 1 N, R 2 W of the 4th P.M., Grant County, Wisconsin, thence S 87°41'35" E 1333.15' along the north line of said section 12 to the point of beginning; thence S 00°46'35" W 71.81' along the extension of the west line of a 1992 survey by David Burbach; thence N 87°22'33" E 225.10' to the Westerly R.O.W. of Louisburg Road; thence N 25°01'03" W 59.03' along said R.O.W. to the north line of said Section 12; thence N 87°41'35" W 199.09' along said north line to the point of beginning, containing 0.305 acres, more or less, and being subject to any and all easements of record.

PARCEL 2 (SOUTH PARCEL)

Commencing at the NW corner of Section 12, T 1 N, R 2 W of the 4th P.M., Grant County, Wisconsin, thence S 87°41'35" E 1333.15' along the North line of said Section 12; thence S 00°46'35" W 71.81' along the extension of the West line of a 1992 survey by David Burbach to the point of beginning; thence N 87°22'33" E 225.10' to the Westerly R.O.W. of Louisburg Road; thence S 25°01'03" E 74.17' along said R.O.W. to a found 3/4" bar at the NW corner of said Burbach survey; thence S 87°06'52" W 257.50' along the North line of said survey to a 3/4" bar at the NE corner thereof; thence N 00°46'35" E 69.87' along the extension of the west line of said survey to the point of beginning, containing 0.545 acres, more or less, and being subject to any and all easements of record.

SURVEYOR'S CERTIFICATE: I, Larry L. Austin, Registered Wisconsin Land Surveyor do hereby certify that the above survey, description and plat were prepared by me or under my direct supervision, in accordance with the instructions of Cora Haverland and Attorney Phil Karkmann, and to the best of my knowledge and belief, this plat is an accurate representation thereof.

Larry L. Austin
 LARRY L. AUSTIN RLS 1903
 LARRY AUSTIN ENGINEERING
 RT. 2
 LANCASTER, WI 53813
 PHONE (608) 723-6363

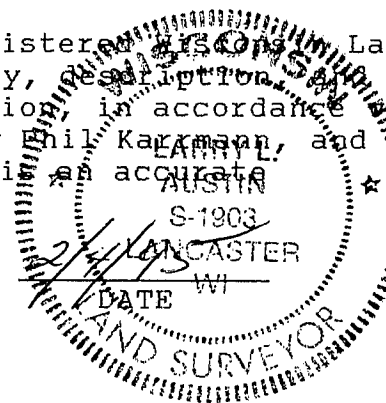

BEARING REFERENCE: For purposes of this survey bearings are referenced to the North line of the NW 1/4 Section 12 which is assumed to bear S 87°41'35" E.

