

PLAT OF SURVEY FOR LONNIE KOLMAN

LOCATED IN PART OF THE SOUTHEAST ONE-QUARTER OF THE SOUTHEAST ONE-QUARTER AND PART OF THE SOUTHWEST ONE-QUARTER OF THE SOUTHEAST ONE-QUARTER OF SECTION 33, TOWNSHIP 8 NORTH, RANGE 1 WEST, TOWNSHIP OF MUSCODA, GRANT COUNTY, WISCONSIN.

BASIS OF BEARINGS:
THE SOUTH LINE OF THE SOUTHEAST ONE-QUARTER OF SECTION 33 IS ASSUMED TO BEAR SOUTH 89° 58' 45" WEST TO CORRESPOND WITH SURVEY BY T. CORNELL FOR THE BLUE RIVER VALLEY CHURCH.

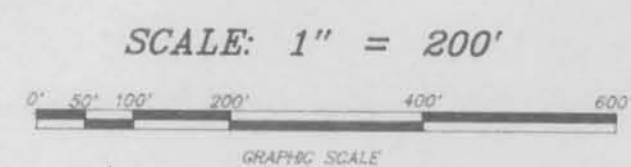

LEGEND

- --- INDICATES 3/4" X 24" IRON ROD PLACED (MINIMUM WEIGHT = 1.5 LBS. PER LINEAL FOOT)
- --- INDICATES 1" DIAMETER IRON PIPE LOCATED
- (00) --- DIMENSIONS IN PARENTHESES ARE AS PREVIOUSLY DESCRIBED
- X - X - X --- INDICATES LOCATION OF EXISTING FENCELINE

DESCRIPTION:

All that part of the Southeast One-quarter of the Southeast One-quarter and part of the Southwest One-quarter of the Southeast One-quarter of Section 33, Township 8 North, Range 1 West, Town of Muscoda, Grant County, Wisconsin, bounded and described as follows:

Commencing at the Southeast corner of Section 33, said point being the point of beginning of the parcel hereinafter described; thence South 89° 58' 45" West, along the South line of the Southeast One-quarter of Section 33, 2302.68 feet; thence North 00° 01' 23" East, 367.00 feet (previously described as South 22 rods 4 feet); thence South 89° 58' 45" West, parallel to the South line of the Southeast One-quarter, 538.25 feet (previously described as East 20-1/2 rods) to a point on the West line of the Southwest One-quarter (previously described as West 80 rods); thence North 76° 07' 17" East, 1361.09 feet (previously described as South- the Southeast One-quarter, said point being previously described as 50 rods North of the Southeast One-quarter of the Southwest One-quarter of the Southeast One-quarter; thence North 00° 04' 31" East, along the West line of the Southeast One-quarter, 492.69 feet to the Northwest corner of the Southeast One-quarter of the Southeast One-quarter; thence South 89° 46' 29" East, along the North line of the Southeast One-quarter of the Southeast One-quarter, 1321.67 feet to the Northeast corner of the Southeast One-quarter of the Southeast One-quarter; thence South 00° 07' 42" West, along the East line of the Southeast One-quarter of the Southeast One-quarter, 1312.01 feet to the point of beginning, containing 2,487,242 square feet or 57.100 acres of land.

The above described parcel of land being subject to conveyances for town road purposes and any reservations for Church Road.

TOTAL AREA
2,487,242 SQ.FT.
57.100 ACRES

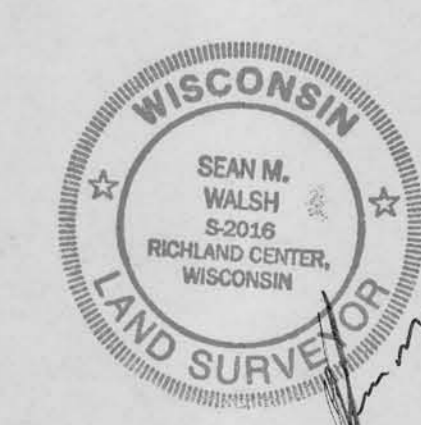

I HAVE SURVEYED THE PROPERTY DEPICTED HEREON AND THIS IS A CORRECT REPRESENTATION THEREOF AND SHOWS THE SIZE AND LOCATION OF THE PROPERTY AND ITS EXTERIOR BOUNDARIES.

THIS SURVEY IS MADE FOR THE EXCLUSIVE USE OF THE PRESENT OWNERS OF THE PROPERTY, AND ALSO THOSE WHO PURCHASE, MORTGAGE OR GUARANTEE THE TITLE THEREOF, WITHIN ONE (1) YEAR HEREOF; AND AS TO THEM I HEREBY CERTIFY THAT SAID SURVEY AND THIS MAP WERE MADE IN ACCORDANCE WITH ACCEPTABLE PROFESSIONAL STANDARDS AND THE INFORMATION CONTAINED HEREON IS TO THE BEST OF MY KNOWLEDGE, INFORMATION AND BELIEF A TRUE REPRESENTATION THEREOF.

BENCHMARK SURVEYS
OF SW. WIS., INC.
P. O. BOX 486, 133 N. CENTRAL AVE., RICHLAND CENTER, WI 53581
(608) 647-8533

SHEET 1 OF 1
JOB NUMBER 1381

DR. BY: SMW
JULY, 1996