

REC'D JAN 2 1998

# SURVEY PLAT

PREPARED FOR: CITY OF PLATTEVILLE

LOCATED IN BLOCK "H" OF BAYLEY'S SUBDIVISION, PLATTEVILLE, WISCONSIN

## WAIVER OF MONUMENTATION

I, HOWARD CROFOOT, DO HEREBY CERTIFY THAT THE MONUMENTS BE PLACED AS SHOWN ON THIS PLAT.

## AUSTIN ENGINEERING - LARRY L. AUSTIN

4211 HWY 81 E, LANCASTER, WI 53813  
PHONE 608-723-6363 FAX 608-723-6702

DRAWN BY: SW AUSTIN  
APPROVED: LL AUSTIN  
CREW: BS - DK  
SHEET 1 OF 1

FIELDBOOK: 94-30  
C:\SURVEY3\PLVILLE\JAYTOPO  
C:\EPSA\PROGRAM\PLVILLE\HS

HOWARD CROFOOT

DATE

## DESCRIPTION

COMMENCING AT THE NORTHWEST CORNER OF LOT 6, BLOCK "B" OF GASSER ADDITION TO THE CITY OF PLATTEVILLE, GRANT COUNTY, WISCONSIN, SAID CORNER BEING THE POINT OF BEGINNING; THENCE N 01°34'20" E 25.00' TO A POINT ON THE NORTH LINE OF HEER STREET; THENCE S 88°09'40" E 27.82' TO A 3/4" REBAR ON THE SAID NORTH LINE; THENCE S 31°40'21" W 28.82' TO A POINT ON THE SOUTH LINE OF SAID HEER STREET; THENCE N 88°09'40" W 13.37' TO THE POINT OF BEGINNING, CONTAINING 515 S.F., MORE OR LESS, AND BEING SUBJECT TO ANY AND ALL EASEMENTS OF RECORD, AND/OR USAGE.

## SURVEYOR'S CERTIFICATE

I, LARRY L. AUSTIN, REGISTERED WISCONSIN LAND SURVEYOR, DO HEREBY CERTIFY THAT THE ABOVE DESCRIPTION WAS SURVEYED, MAPPED, AND MONUMENTED BY ME OR UNDER MY DIRECT SUPERVISION ALL IN ACCORDANCE WITH THE INSTRUCTIONS OF THE HOWARD CROFOOT, AND TO THE BEST OF MY KNOWLEDGE AND BELIEF THIS PLAT IS AN ACCURATE REPRESENTATION THEREOF.

*Larry L. Austin*  
LARRY L. AUSTIN R.L.S. 1903

*12/23/97*  
DATE

BEARINGS REFERENCED TO THE NORTH LINE OF LOT 6, BLOCK "B" OF GASSER ADDITION TO THE CITY OF PLATTEVILLE, WHICH IS ASSUMED TO BEAR N 89°09'40" W.

## BLOCK "H" BAYLEY'S SUBDIVISION

LOT 6

EXISTING HOUSE

NORTH LINE OF HEER STREET

METAL SHED

HEER STREET

BLOCK GASSER "B" ADDITION

SOUTH LINE OF HEER STREET

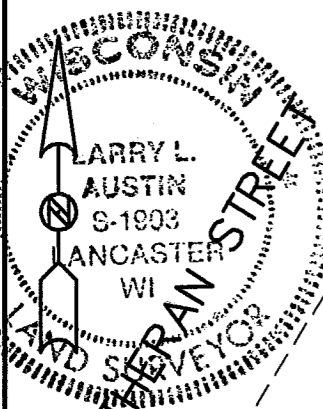

REC'D JAN 2 1998  
City of Platteville, Gasser Addition Lot 6, Block B

## LEGEND

- ▲ 1 1/2" IRON PIPE FOUND
- ▲ 1" IRON PIPE FOUND
- 3/4" X 24" REBAR SET
- EXISTING TREE LOCATION



SCALE 1" = 20'

