

37

REC'D DEC 29 1997

PLAT OF SURVEY

FOR: CLARENCE BERNING

SHEET 1 OF 2

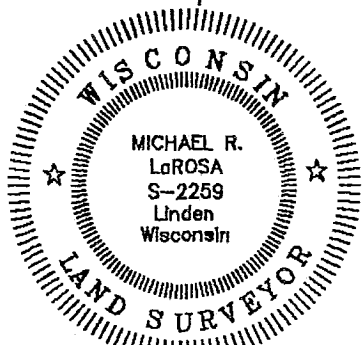
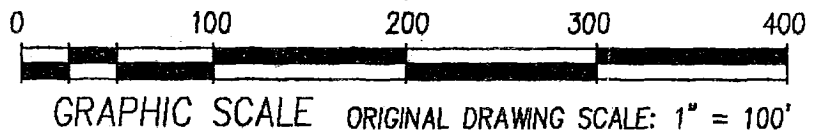

Michael R. LaRosa
11/24/1997

N

PLAT BEARINGS ARE REFERENCED TO THE E-N 1/4 SECTION LINE OF SECTION 12, T1N, R11W WHICH IS ASSUMED TO BEAR S 89°45'42" W.

SW 1/4 OF THE NE 1/4

W 1/4 CORNER FOUND 1-1/4" REBAR



S 89°45'42" W 2753.95'

N 07°39'36" E
38.84'

CENTERLINE OF NORTH HOLLOW ROAD

S 89°45'42" W

266.12'

S 89°45'42" W
P.O.B.

N 89°45'42" E
505.91'
18.41'

DRAINAGE

5.00 ACRES ±

(S 89°42' W
S 89°44'36" W
136.00'

323.81'

284.75'

VOL. 659
PG. 446

(N 88°05' W, 316.61)
N 88°07'24" W
316.24'

VOL. 433
PG. 428

OFFICE DATA:	
JOB I.D.	97S-277
SURVEY CREW:	ML BB
FIELD BOOK NO.:	97-10
DWG. STORED:	VERS13EP
DRAWN BY:	ML
DRAWING NO.:	<DIR>97S-277.DWG
DATA FILE NO.:	<DIR>97S-277.DAT

- LEGEND:**
- 1"X24"X1.13 #/LF IRON PIPE SET
 - 1-1/4"X24"X1.13 #/LF(MIN. WT.) IRON PIPE SET
 - 3/4" IRON ROD SET
 - ▲ IRON ROD FOUND
 - △ IRON PIPE FOUND
 - X- FENCE
 - () RECORDED AS
 - + NO MONUMENT PLACED

727.92'

50' RM
S 10°02'01" W
145.13'

CENTERLINE OF S.T.H. 80

E 1/4 CORNER CORNER LOCATION FROM 4 TIES FOUND IN PLACE.

2276.96'



SCHMIT ENGINEERING & SURVEYING
215 E. GRACE ST DODGEVILLE, WI. 53533 (608)935-2721

7E

Plat of survey
For: Clarence Berning
Job #97s-277
Sheet 2 of 2

PARCEL DESCRIPTION:

A parcel of land located in part of the SW 1/4 of the NE 1/4 of Section 12, T1N, R1W, Grant County, Wisconsin, to wit:

Commencing at the E 1/4 CORNER of said Section 12; thence S 89° 45' 42" W along the East-West 1/4 section line of said section, 2276.96' to the POINT OF BEGINNING; thence continuing along said line, S 89° 45' 42" W, 266.12'; thence N 7° 39' 36" E, 505.91'; thence N 89° 45' 42" E, 727.92' to the westerly right of way of State Trunk Highway 80; thence S 10° 02' 01" W along said right of way, 195.13'; thence N 88° 07' 24" W, 316.24'; thence S 89° 44' 36" W, 136.00'; thence S 7° 39' 36" W, 323.81' to the POINT OF BEGINNING; said described parcel containing 5.00 acres, more or less. Parcel is subject to an easement for North Hollow Road along the southerly side thereof. Parcel is subject to any easements of record and or usage.

SURVEYOR'S CERTIFICATE:

I hereby certify that I have made a survey according to the instructions and/or description furnished me and that the plat drawn is a correct representation of that survey to the best of my knowledge and belief.

Michael R. LaRosa

Michael R. LaRosa RLS No. S-2259

11/24/1997
date

C:\D\97S-277\97S-277.DES

