

Part of NW 1/4, SE 1/4 Sec 21, T1N R2W
Jamestown Township

1-2(21)

Jansen Property

Commencing at the SW corner of the SE 1/4, Sec. 21, T1N, R2W, 4th P.M. Grant County, Wisconsin; thence North, 132.00 ft.; thence East, 193.00 ft. to the centerline of S.T.H. #35; thence N 13° 00' E, 1078.94 Ft. along said centerline to the point of beginning; thence N 13° 09' E, 833.76 ft. along said centerline; thence S 77° 00' E, 260.00 ft.; thence S 13° 00' W, 842.63 ft.; thence N 75° 03' E, 260.15 ft. to the point of beginning, containing 3.88 acres, more or less.

DIXON & ORTH
REGISTERED SURVEYORS
PLATTEVILLE, WIS.

N: 75° 03' W

COPY

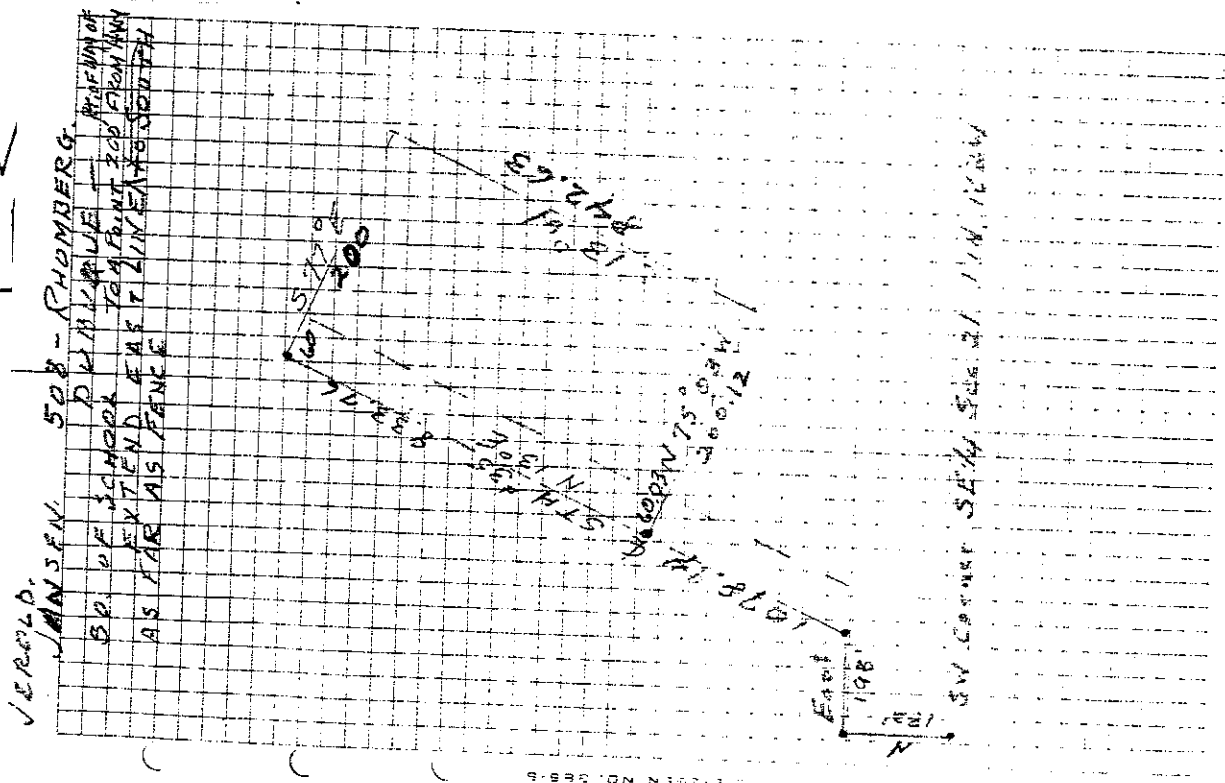

RECEIVED NF427
By Land Information Office at 1:42 pm, Sep 18, 2020

FILE