

260



JAN 3 1986

RECEIVED

SURVEY PLAT

City of
Cuba City

LEGEND

-  Found 1/2" drill hole in concrete walk
-  Set 1/2" drill hole in concrete walk
-  Set 2" x 36" iron pipe min. weight = 3.65 lbs./lin. ft.

SURVEYED FOR:

City of Cuba City
Cuba City, Wisconsin

Surveyors note:

The right-of-way as shown was surveyed for new street construction, under the direction of the Public Works Committee of the City of Cuba City.



Bearings are referenced to the East line of Block 1, original plat of Cuba City, assumed to bear N1°03'20"E.

Douglas J. Malliet

Douglas J. Malliet, S-1266
Registered Land Surveyor
December 19, 1985



SCALE: 1" = 100'

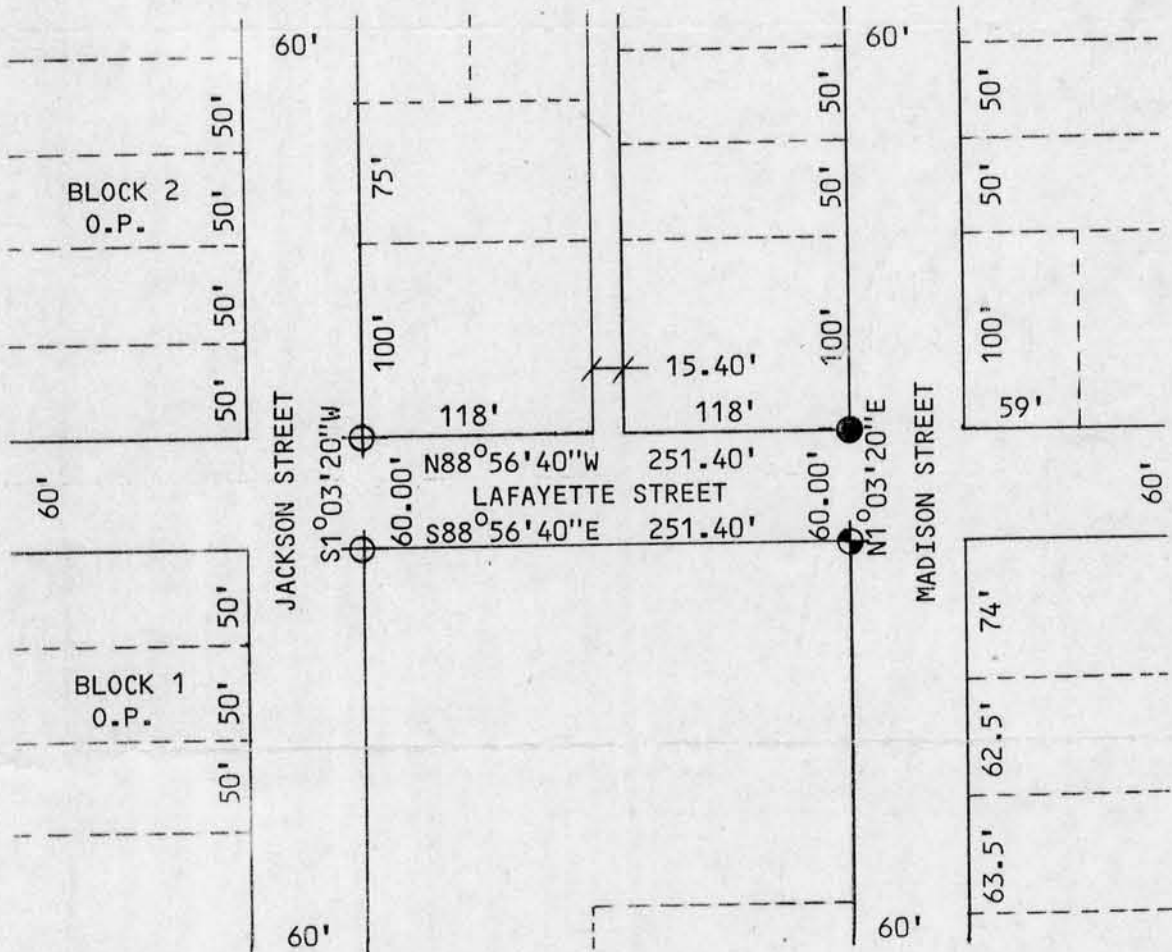

D. F. BURBACH MUNICIPAL & CIVIL ENGINEERS

Box 96B, Highway 80 South • Platteville, Wisconsin 53818 • (608) 348-3262