

Sec. 36, T6N, R1W

SURVEY PLAT

LOCATED IN THE SOUTHEAST 1/4 OF THE SOUTHEAST 1/4, THE NORTHEAST 1/4 OF THE SOUTHEAST 1/4, SECTION 36, TOWN 6 NORTH, RANGE 1 WEST, TOWN OF WINGVILLE, GRANT COUNTY, WISCONSIN.

OWNER: WINIFRED McREYNOLD
MOUNTFORT, WISCONSIN

LEGEND AND NOTES

○ SET 1-1/4" x 24" IRON PIPE, MIN. WT.
1.13 LBS./LIN. FT.



SCALE: 1" = 200'

BEARINGS ARE REFERENCED TO THE CENTERLINE OF S.T.H. '80', RECORDED AS N00°42'00"W.



10

SURVEY PLAT

SURVEYOR'S CERTIFICATE:

I, John M. Halverson, Registered Land Surveyor, hereby certify that I have surveyed a parcel of land located in the Southeast ¼ of the Southeast ¼ and the Northeast ¼ of the Southeast ¼, Section 36, Town 6 North, Range 1 West, Town of Wingville, Grant County, Wisconsin described as follows:

Commencing at the Southeast corner of said Section 36; thence North 00°13'34" West, 776.53 feet along the East line of the SE¼ of said Section 36 to the point of beginning; thence North 59°51'00" West, 745.04 feet; thence North 00°42'00" West, 448.37 feet; thence South 80°42'20" East, 276.01 feet; thence North 09°38'02" East, 102.14 feet; thence North 79°05'00" East, 363.08 feet to a point on the East line of the SE¼ of said Section 36; thence South 00°13'34" East, 947.44 feet along the East line of said SE¼ to the point of beginning.

Said parcel contains 10.00 acres. Subject to public highway right-of-way to S.T.H. '80' and also subject to any and all other easements of record.

I further certify that such survey and the representation thereof hereon are true and correct to the best of my knowledge and belief.

April 27, 1986
Date

John M. Halverson
John M. Halverson
Registered Land Surveyor
Arena, Wisconsin 53503

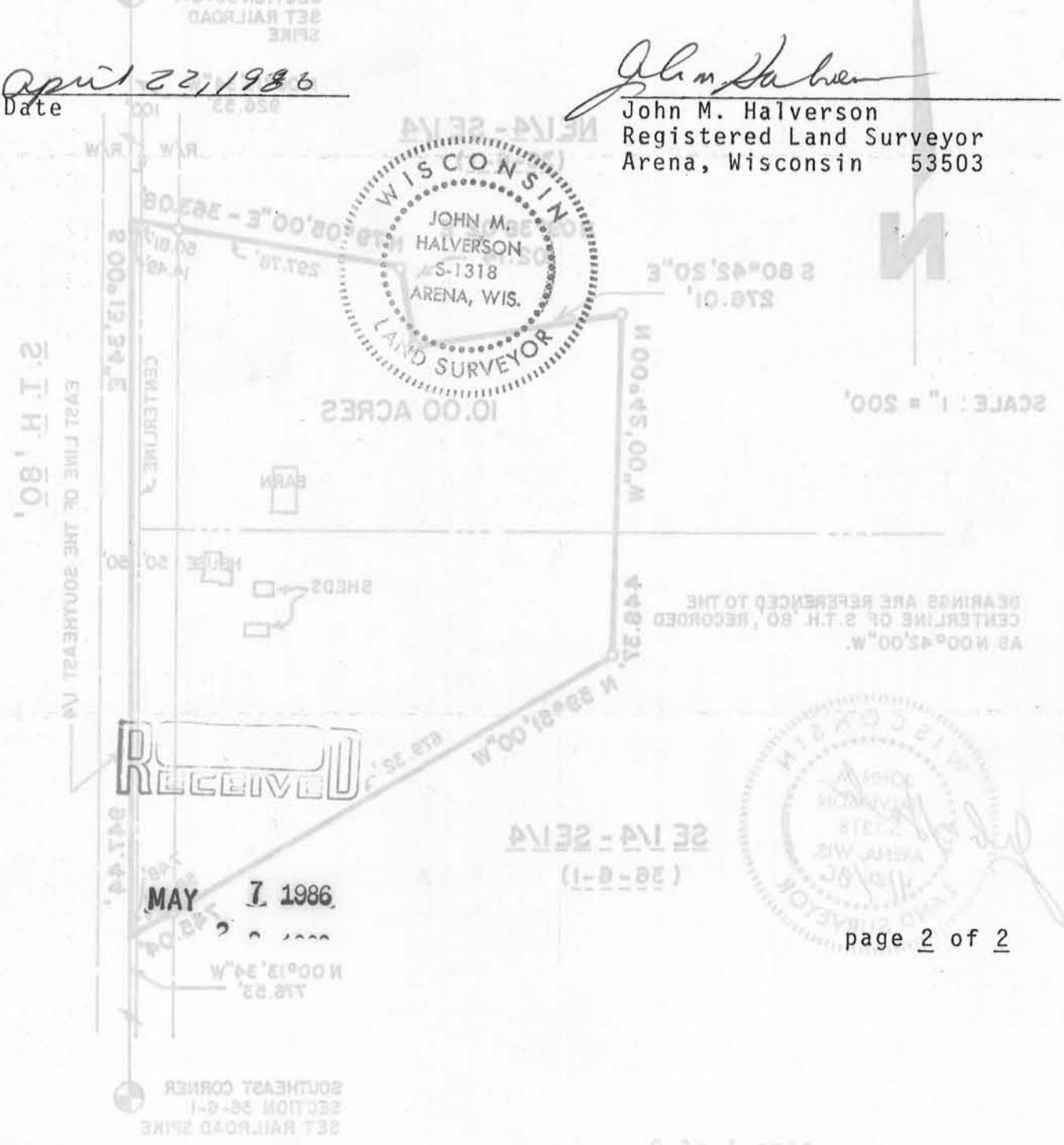

RECEIVED

MAY 7 1986

