

# PLAT OF SURVEY

NORTHWEST CORNER  
SECTION 27, T3N R3W  
Railroad Spike found

NORTH 1/4 CORNER  
SECTION 27, T3N R3W  
1" Iron pipe found

## LEGEND

- ⊕ Section Corner—all ties found
- 3/4" x 18" rebar set with cap
- 3/4" rebar found
- ⊙ 5/8" Rebar found
- No monument set
- ( ) Recorded as
- [ ] Property described in Document Number, Grant County Registry
- Boundary of Survey
- - - Section line
- - - Centerline NE 1/4 - NW 1/4
- - - Right of Way
- - - Previously surveyed line
- \* \* \* \* Existing fence

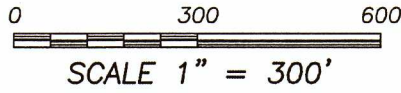

The North-South 1/4 line of Section 27 bears S 00°10'55" E according to the Grant County Coordinate System WISCORS NAD 83 (2011) which was determined by G.P.S. observation.

[746928]  
PREVIOUS SURVEY  
BY AARON AUSTIN  
DATED 6-20-2012  
BOOK 31, PAGE 50

[746928]  
PREVIOUS SURVEY  
BY AARON AUSTIN  
DATED 6-20-2012  
BOOK 31, PAGE 50

PREVIOUS SURVEY  
BY AARON AUSTIN  
DATED 12-13-2021  
BOOK 47, PAGE 91

PREVIOUS SURVEY  
BY AARON AUSTIN  
DATED 10-7-2010  
BOOK 28, PAGE 64

**13.88± ACRES**  
**604,516± SQ.FT.**

**DUTCH HOLLOW ROAD**

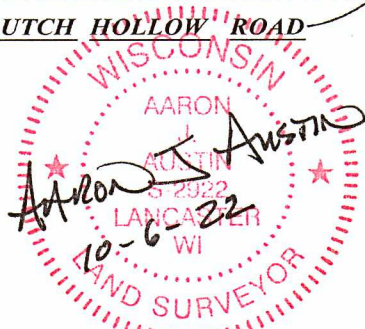

This survey was prepared for the exchange  
of land between adjoining land owners.



4211 HWY 81 E, LANCASTER, WI 53813  
PHONE: 608-723-6363 FAX: 608-723-6702

Prepared for: **TRAVIS KUSTER**

JOB NO: 22S160  
H:\CRD\21S266  
H:\PLAT\T3NR3W\27\22S160-KUSTER

DRAWN BY: AJ AUSTIN  
CREW CHIEF: SHANE AUSTIN  
CREW: O. AUSTIN, T. AUSTIN

SHEET 1 OF 2

# PLAT OF SURVEY

**DESCRIPTION:**

Located in the Southeast Quarter (SE 1/4) of the Northwest Quarter (NW 1/4) of Section Twenty-Seven (27), Township Three (3) North, Range Three (3) West of the 4th P.M., Town of Potosi, Grant County, Wisconsin, and being described as follows:

Commencing at a 1" iron pipe marking the North Quarter (N 1/4) corner of said Section; thence South 00° 10' 55" East 1329.49 feet along the North-South Quarter (N-S 1/4) line of said Section to a 3/4" rebar marking the Northeast corner of the Southeast Quarter (SE 1/4) of the Northwest Quarter (NW 1/4) thereof, said corner being the point of beginning; thence continuing South 00° 10' 55" East 478.20 feet along said North-South Quarter (N-S 1/4) line to a 5/8" rebar marking the Northeast corner of a previous survey by Aaron Austin dated 12-13-2021 filed in Book: 47, Page: 91 of Grant County Surveys; thence South 88° 14' 03" West 630.51 feet along the North line of said survey to a 5/8" rebar; thence South 89° 18' 30" West 525.02 feet along the North line of said survey to a 5/8" rebar; thence North 15° 45' 05" West 521.48 feet along a line of that property as described in Document Number 746928, Grant County Registry to a 3/4" rebar on the North line of the Southeast Quarter (SE 1/4) of said Northwest Quarter (NW 1/4); thence North 89° 54' 30" East 1295.25 feet along said North line to the point of beginning. Tract being subject to any and all easements of record and/or usage.

**SURVEYOR'S CERTIFICATE:**

I, Aaron J. Austin, Professional Wisconsin Land Surveyor, hereby certify:

That the above description was surveyed, mapped and monumented as shown on this plat by me or under my direct supervision and field work was completed on 9-29-2022.  
That this survey was prepared under the instructions of Travis Kuster.  
That this survey complies with Chapter A-E 7 of the Wisconsin Administrative Code and to the best of my knowledge and belief, this plat is an accurate representation thereof.  
That all plans that do not show a seal imprint in red ink may contain unauthorized alterations.  
The certification contained on this document shall not apply to any copies.

Dated this 6th day of October, 2022.

  
Aaron J. Austin, S-2922



**Austin Engineering LLC**  
austinengineeringllc.com

4211 HWY 81 E, LANCASTER, WI 53813  
PHONE: 608-723-6363 FAX: 608-723-6702

Prepared for: TRAVIS KUSTER

JOB NO: 22S160  
H:\CRD\21S266  
H:\PLAT\T3NR3W\27\22S160-KUSTER

DRAWN BY: AJ AUSTIN  
CREW CHIEF: SHANE AUSTIN  
CREW: O. AUSTIN, T. AUSTIN