

PLAT OF SURVEY

EASEMENT DESCRIPTION:

A Thirty-three foot (33') wide access easement for ingress-egress which is located in the Northeast Quarter (NE 1/4) of the Northeast Quarter (NE 1/4) of Section Fifteen (15), Township Four (4) North, Range Three (3) West of the 4th P.M., Town of South Lancaster, Grant County, Wisconsin being described as follows:

Commencing at an Aluminum Monument marking the Northeast corner of said Section 15;
thence South 01° 26' 53" East 480.24 feet along the East line of said Section to the Northeast corner of that property described in Document Number 802094, Grant County Registry;
thence South 83° 05' 37" West 33.76 feet along the North line of said property to a 3/4" rebar marking the Point of Beginning;
thence South 83° 05' 37" West 33.11 feet along said North line;
thence South 02° 08' 13" East 165.00 feet;
thence North 83° 05' 37" East 33.11 feet to the Easterly right of way of a township road known as Stage Road;
thence North 02° 08' 13" West 165.00 feet along said right of way to the point of beginning.

SURVEYOR'S CERTIFICATE:

I, Aaron J. Austin, Professional Wisconsin Land Surveyor, hereby certify:
That the above easement descriptions were surveyed and mapped as shown on this plat by me or under my direct supervision and field work was completed on 8-25-2022.

That this survey was prepared under the instructions of Gary Morrow.
That this survey complies with Chapter A-E 7 of the Wisconsin Administrative Code and to the best of my knowledge and belief, this plat is an accurate representation thereof.

That all plans that do not show a seal imprint in red ink may contain unauthorized alterations.

The certification contained on this document shall not apply to any copies.

Dated this 16th day of September, 2022.

Aaron J. Austin
Aaron J. Austin, S-2922

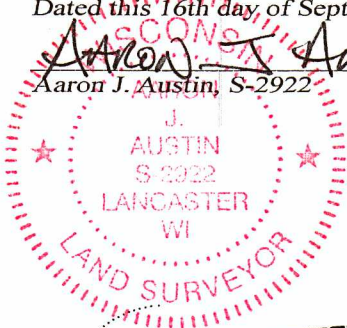

NORTHEAST CORNER SECTION 15, T4N R3W Aluminum Monument and ties found



S 01°26'53" E 480.24'

STAGE ROAD

2651.16'

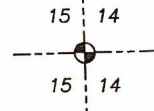

S 83°05'37" W 33.11'

S 83°05'37" W 426.67'

33.76'

POINT OF BEGINNING

33'

S 02°08'13" E 165.00'

N 02°08'13" W 165.00'

33'

N 83°05'37" E 33.11'

drive

LEGEND

- ⊕ Section Corner—as designated
- 3/4" rebar found
- × No monument set
- Boundary of Easement
- - - Previously surveyed line
- Section line
- - - Existing centerline
- - - Right of Way—Established
- 33' from existing centerline
- x - x - Existing fence

TRACT 4
PREVIOUS SURVEY
BY AARON AUSTIN
DATED 2-13-2019
BOOK 43, PAGE 22
Document Number 802094
Grant County Registry



0 50 100

SCALE 1" = 50'

The East line of then NE 1/4 of Section 15 bears S 01°26'53" E according to the Grant County Coordinate System WISCORS NAD 83 (2011) which was determined by G.P.S. observation.

EAST 1/4 CORNER SECTION 15, T4N R3W Aluminum Monument and ties found



Austin Engineering LLC
austinengineeringllc.com

4211 HWY 81 E, LANCASTER, WI 53813
PHONE: 608-723-6363 FAX: 608-723-6702

Prepared for: GARY MORROW

JOB NO: 22S156
H:\CRD\22S156-MORROW
H:\PLAT\T4NR3W\15\22S156-MORROW

FIELDBOOK: SP80, F30
DRAWN BY: SW AUSTIN
CREW: SWA - TJA

SHEET 1 OF 1