

DESCRIPTION PROVIDED:
 Property described in Document Number 802753, Grant County Registry and being described as follows:

Lots 4 and 5, EXCEPTING therefrom land described in Volume 250 of Deeds, page 539 in the Grant County Registry; Lots 6 and 7, all in Block 5; Outlot 2; and Outlot 1 EXCEPT that part, which would be cut off in the Southeast corner by a continuation of the North line of Block 4 to the East line of Outlot 1, according to Original Plat of Mt. Ida, Town of Mt. Ida, Grant County, Wisconsin.

SURVEYOR'S CERTIFICATE:
 I, Aaron J. Austin, Professional Wisconsin Land Surveyor, hereby certify:

That the above description was surveyed, mapped and monumented as shown on this plat by me or under my direct supervision and field work was completed on 7-21-2022.
 That this survey was prepared under the instructions of Andrew Pluemmer.
 That this survey complies with Chapter A-E 7 of the Wisconsin Administrative Code and to the best of my knowledge and belief, this plat is an accurate representation thereof.
 That all plans that do not show a seal imprint in red ink may contain unauthorized alterations.
 The certification contained on this document shall not apply to any copies.

Dated this 8th day of August, 2022.
 Aaron J. Austin
 Aaron J. Austin, S-2922

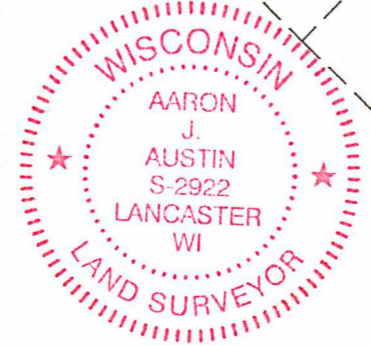

- LEGEND**
- Section Corner
 - ⊙ 3/4" rebar found
 - ⊙ 5/8" rebar found
 - 5/8" x 18" rebar set with cap
 - No monument set
 - ◇ Wood lath set
 - ◇ Wood lath from previous survey
 - () Recorded as
 - [] Property described in Document Number, Grant County Registry
 - ⊠ Underground pedestal
 - ⊙ Utility pole
 - ⊙ Existing well
 - Boundary of Survey
 - Section line
 - Centerline
 - Right of Way
 - Platted lot line
 - Previously surveyed line
 - Existing deed line
 - Existing improvement
 - Existing structure
 - Existing fence

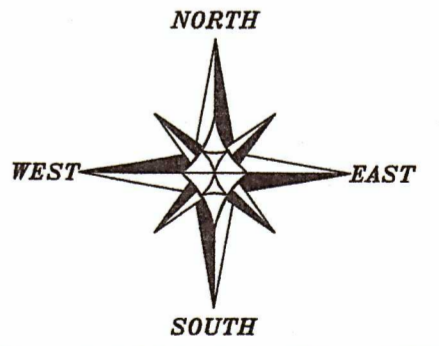

The North line of the NE 1/4 of Section 29 bears S 89°34'18" E according to the Grant County Coordinate System WISCORS NAD 83 (2011) which was determined by G.P.S. observation.

0 60 120
 SCALE 1" = 60'

Right of Way established from R/W Project Number 1660-01-22 on file at the Grant County Highway Department

PLAT OF SURVEY
 PREPARED FOR: ANDREW PLUEMER
 LOCATED IN SECTION 29, T6N R3W, TOWN OF MT. IDA, GRANT COUNTY, WISCONSIN

Austin Engineering LLC
 austinengineeringllc.com
 4211 HWY 81 E
 LANCASTER, WI 53813
 PHONE 608-723-6363
 FAX 608-723-6702

JOB NO: 225065
 H:\CRD\215278
 H:\PLAT\MT IDA\225065-PLUEMER
 FIELDBOOK: TDSR
 DRAWN BY: AJ AUSTIN
 CREW: OWEN AUSTIN
 SHEET 1 OF 1

AUG 15 2022 10617