

PLAT OF SURVEY

DESCRIPTION:

Recorded in Volume 1011, Page 648 as Document No. 664259, Grant County Registry and being described as follows:

Parcel I:

Part of Lot Two (2) and part of Lot Three (3) of Block Sixty-nine (69) of the Assessment Plat, City of Lancaster, Grant County, Wisconsin, described as follows:
Commencing at a point which is 298.58 feet North and 198.25 feet West of the Northeast Corner of Lot Eleven (11) of the recorded plat of Golf Heights Addition to the City of Lancaster, Grant County, Wisconsin;
thence South 89° 48' West 150.00 feet to the point of beginning;
thence North 00° 12' West 108.00 feet;
thence South 89° 48' West 115.00 feet;
thence South 15° 31' 15" West 112.09 feet;
thence North 89° 48' East 145.00 feet to the point of beginning.

PARCEL II:

Non-exclusive easement for the benefit of Parcel I for ingress and egress over and across the premises described as follows; to-wit:

Commencing at the Northeast corner of the N.E.1/4 of Section 10. T 4 N, R 3 W of the 4th P.M., City of Lancaster, Grant County, Wisconsin;

thence West 344.02 feet;
thence South 29.01 feet to a point on the North line of Block 69 of the Assessor's Plat of the City of Lancaster and the point of beginning;
thence South 00° 12' 00" East 320.09 feet;
thence South 89° 48' 00" West 119.04 feet;
thence South 00° 12' 00" East 130.00 feet;
thence North 89° 48' 00" East 145.00 feet;
thence South 00° 12' 00" East 167.14 feet;
thence South 89° 48' 00" West 30.00 feet;
thence North 00° 12' 00" West 137.14 feet;
thence South 89° 48' 00" West 145.00 feet;
thence North 00° 12' 00" West 190.00 feet;
thence North 89° 48' 00" East 119.04 feet;
thence North 00° 12' 00" West 290.28 feet to a point on the North line of Block 69;
thence South 89° 50' 07" East 30.00 feet to the point of beginning.
Said lands also described as part of Lot Two (2), part of Lot Two (2)B and part of Lot Three (3), Block Sixty-nine (69) of the Assessment Plat of the City of Lancaster, Grant County, Wisconsin.

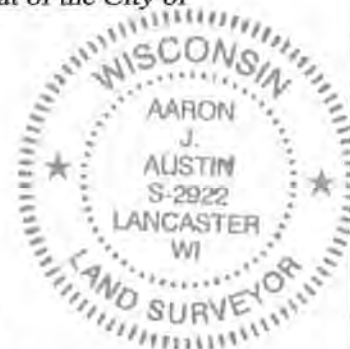

SURVEYOR'S CERTIFICATE:

I, Aaron J. Austin, Registered Wisconsin Land Surveyor, hereby certify:

That the above description was surveyed, mapped and monumented as shown on this plat by me or under my direct supervision.

That conformance with local ordinances are not guaranteed with this survey.

That this survey was prepared under the instructions of Earl Tranel.

That to the best of my knowledge and belief, this plat is an accurate representation thereof.

That all plans that do not show a seal imprint in red ink may contain unauthorized alterations.

The certification contained on this document shall not apply to any copies.

Dated this 25th day of February, 2014.

A handwritten signature in black ink that reads "Aaron J. Austin".

Aaron J. Austin, S-2922

SURVEYOR'S NOTES:

Surveyor has made no investigation for easements of record, encumbrances, restrictive covenants, ownership title evidence except as specifically shown on this plat. No distance should be assumed by scaling. No improvements have been located unless shown and noted. No representation as to ownership, use or possession should be hereon implied. Refer to abstract, title or local ordinances for any additional restriction, easements or building setback lines. No abstract, nor title commitment, nor results of title searches were furnished to the surveyor.



Austin
Engineering LLC
austinengineeringllc.com

4211 HWY 81 E, LANCASTER, WI 53813
PHONE: 608-723-6363 FAX: 608-723-6702

Prepared for: EARL TRANEL

JOB NO: 14s005
G:\14s005
H:\PLAT\LANCASTER\AP\BLOCK-69\14s005-TRANEL

FIELDBOOK: TDSR
DRAWN BY: AJ AUSTIN
CREW: SW AUSTIN

SHEET 2 OF 2