

PLAT OF SURVEY

WEST 1/4 CORNER
SECTION 4, T6N R1W

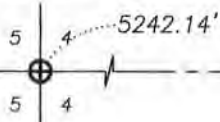

SNOWBOTTOM ROAD

EAST 1/4 CORNER
SECTION 4, T6N R1W
POINT OF BEGINNING

N 89°56'04" E
372.65'

GROVE OF TREES

339.60'

EDGE OF FIELD

3 GROVE OF TREES

LEGEND

- No. 6 x 18" rebar set with cap
- ⊕ No. 8 rebar found with Grant County Aluminum Cap
- ⊠ Aluminum Monument found with Grant County Aluminum Cap
- No. 6 rebar found
- + No monument set

0 300 600

SCALE 1" = 300'

C2
L=408.45'
R=5594.47'
C LEN=408.36'
BRG=N 05°22'10" E

C4
L=412.79'
R=5627.47'
C LEN=412.70'
BRG=S 05°21'34" W

CENTERLINE
COUNTY HIGHWAY "G"

TRACT 1
13.65± ACRES
594,475± SQ.FT.

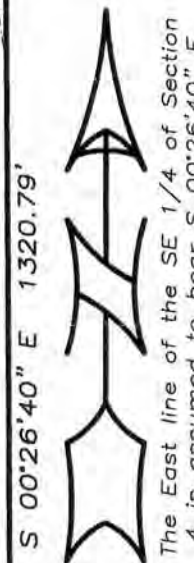

NE - SE
702.62'
N 07°27'40" E

SOUTH LINE
NE 1/4, SE 1/4

498.69'

SOUTHEAST CORNER
NE 1/4, SE 1/4

C1
L=217.71'
R=2650.00'
C LEN=217.64'
BRG=N 05°06'27" E

C3
L=213.42'
R=2617.00'
C LEN=213.37'
BRG=S 05°07'29" W

66' WIDE
PUBLIC ROADWAY
EASEMENT

EAST LINE, SE 1/4
1320.79'

S 00°26'40" E

Arion J. Austin

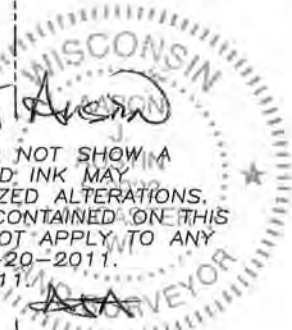

ALL PLANS THAT DO NOT SHOW A SEAL IMPRINT IN RED INK MAY CONTAIN UNAUTHORIZED ALTERATIONS. THE CERTIFICATION CONTAINED ON THIS DOCUMENT SHALL NOT APPLY TO ANY COPIES. DATED: 9-20-2011. REVISED: 9-28-2011.

SE - SE

NO HIGHWAY PLAN FOUND, ASSUMED 66' WIDE PUBLIC ROADWAY EASEMENT, 33' ON EACH SIDE TRAVELED CENTERLINE -VERIFY RIGHT OF WAY WITH GRANT COUNTY HIGHWAY DEPT. BEFORE ANY CONSTRUCTION IN THE PROXIMITY-

SOUTHWEST CORNER
SE 1/4, SE 1/4

N 89°52'21" W 1321.93'

4 3
9 10

SOUTHEAST CORNER
SECTION 4, T6N R1W

TRACT 1
PREVIOUS SURVEY
BY LARRY AUSTIN
DATED 12-3-2008
JOB NO. 08s265



Austin
Engineering LLC
austinengineeringllc.com

Prepared for: MARK FILLBACK

4211 HWY 81 E, LANCASTER, WI 53813
PHONE: 608-723-6363 FAX: 608-723-6702

JOB NO: 11s200
G:\T7NR1W\29
H:\PLAT\T6NR1W\04\11s200-FILLBACK

FIELDBOOK: TDSR
DRAWN BY: AJ AUSTIN
CREW: BS-SB

SHEET 1 OF 2

NOV 04 2011

PLAT OF SURVEY

TRACT 1 DESCRIPTION:

Located in the Northeast Quarter (NE 1/4) of the Southeast Quarter (SE 1/4) of Section Four (4), Township Six (6) North, Range One (1) West of the 4th P.M., Town of Wingville, Grant County, Wisconsin, containing 13.65 acres, more or less, and being described as follows:

Commencing at the East Quarter (E 1/4) corner of said Section 4, said corner being the point of beginning;

thence South $00^{\circ} 26' 40''$ East 1320.79 feet along the East line of said Section to the Southeast corner of the Northeast Quarter (NE 1/4) of the Southeast Quarter (SE 1/4) thereof;

thence North $89^{\circ} 58' 07''$ West 531.72 feet along the South line of the Northeast Quarter (NE 1/4) of the Southeast Quarter (SE 1/4) of said Section to a point in the centerline of County Highway "G";

thence 217.71 feet on the arc of a curve to the right having a radius of 2650.00 feet and a long chord bearing North $05^{\circ} 06' 27''$ East 217.64 feet along said centerline;

thence North $07^{\circ} 27' 40''$ East 702.62 feet along said centerline;

thence 408.45 feet on the arc of a curve to the left having a radius of 5594.47 feet and a long chord bearing North $05^{\circ} 22' 10''$ East 408.36 feet along said centerline to the North line of the Southeast Quarter (SE 1/4) of said Section;

thence North $89^{\circ} 56' 04''$ East 372.65 feet along the North line of the Southeast Quarter (SE 1/4) of said Section to the point of beginning.

Tract being subject to any and all easements of record and/or usage.

SURVEYOR'S CERTIFICATE:

I, Aaron J. Austin, Registered Wisconsin Land Surveyor, hereby certify:

That the above description was surveyed, mapped and monumented as shown on this plat by me or under my direct supervision.

That conformance with local ordinances are not guaranteed with this survey.

That this survey was prepared under the instructions of Mark Fillback.

That to the best of my knowledge and belief, this plat is an accurate representation thereof.

That all plans that do not show a seal imprint in red ink may contain unauthorized alterations.

The certification contained on this document shall not apply to any copies.

Dated this 21st day of September, 2011.

Revised this 28th day of September, 2011. (MAP AND SURVEYOR'S NOTE) *AAA*

Aaron J. Austin
Aaron J. Austin, S-2922

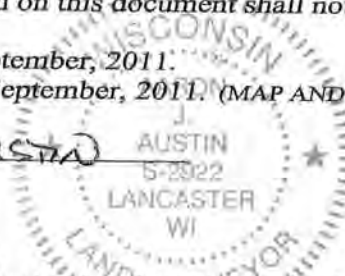

SURVEYOR'S NOTES:

Surveyor has made no investigation for easements of record, encumbrances, restrictive covenants, ownership title evidence except as specifically shown on this plat. No distance should be assumed by scaling. No improvements have been located unless shown and noted. No representation as to ownership, use or possession should be hereon implied. Fences shown on this survey were measured at random locations. The fence may meander between fence corners and are shown for reference only. Possession and occupational rights MAY have been acquired to the fence and it is not known if the fence is a fence of convenience or if it is intended to mark the boundary. This survey was prepared with the intent of following the lines shown and described hereon. Refer to abstract, title or local ordinances for any additional restriction, easements or building setback lines. No abstract, nor title commitment, nor results of title searches were furnished the surveyor.



Austin
Engineering LLC
austinengineeringllc.com

4211 HWY 81 E, LANCASTER, WI 53813
PHONE: 608-723-6363 FAX: 608-723-6702

Prepared for: MARK FILLBACK

JOB NO: 11s200
G:\T7NR1W\29
H:\PLAT\T6NR1W\04\11s200-FILLBACK

FIELDBOOK: TDSR
DRAWN BY: AJ AUSTIN
CREW: BS-SB

SHEET 2 OF 2