

TRACT 1 DESCRIPTION:
Located in the Northwest Quarter (NW 1/4) of the Southwest Quarter (SW 1/4) of Section Fifteen (15), Township Four (4) North, Range Four (4) West of the 4th P.M., Town of Beetown, Grant County, Wisconsin, containing 19.85 acres, more or less, and being described as follows:

Commencing at the West Quarter (W 1/4) corner of said Section, said corner being the point of beginning;
thence North 89° 45' 47" East 1338.66 feet to a No. 6 rebar marking the Northeast corner of the Northwest Quarter (NW 1/4) of said Southwest Quarter (SW 1/4);
thence South 01° 51' 59" East 825.00 feet along the East line of the NW 1/4 of said SW 1/4 to a No. 6 rebar;
thence South 89° 46' 18" West 759.00 feet along a line of that property as described in Volume 561, Page 485 recorded as Document No. 478965, Grant County Registry to a No. 6 rebar;
thence North 36° 25' 14" West 1021.59 feet along a line of said property to the point of beginning.
Tract being subject to any and all easements of record and/or usage.

SURVEYOR'S CERTIFICATE:
I, Aaron J. Austin, Registered Wisconsin Land Surveyor, hereby certify:

That the above description was surveyed, mapped and monumented as shown on this plat by me or under my direct supervision.
That conformance with local ordinances are not guaranteed with this survey.
That this survey was prepared under the instructions of Dick Wiedenbeck.
That to the best of my knowledge and belief, this plat is an accurate representation thereof.
That all plans that do not show a seal imprint in red ink may contain unauthorized alterations.
The certification contained on this document shall not apply to any copies.

Dated this 14th day of March, 2011.

Aaron J. Austin
Aaron J. Austin, S-2922

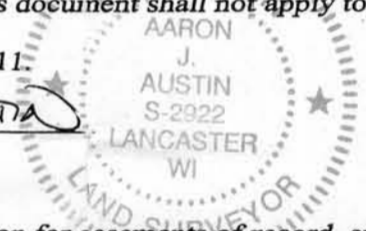

SURVEYOR'S NOTES:
Surveyor has made no investigation for easements of record, encumbrances, restrictive covenants, ownership title evidence except as specifically shown on this plat. No distance should be assumed by scaling. No improvements have been located unless shown and noted. No representation as to ownership, use or possession should be hereon implied. Refer to abstract, title or local ordinances for any additional restriction, easements or building setback lines. No abstract, nor title commitment, nor results of title searches were furnished the surveyor.

LEGEND

- ⊠ Bernsten Aluminum Monument found
- ▲ 2" diameter iron pipe found
- △ 1" diameter iron pipe found
- No. 6 rebar found
- No. 6 x 24" rebar set with cap
- Steel T-post set
- Approximate location of fence
- () Recorded as
- [-] Property described in Volume and Page, Grant County Registry

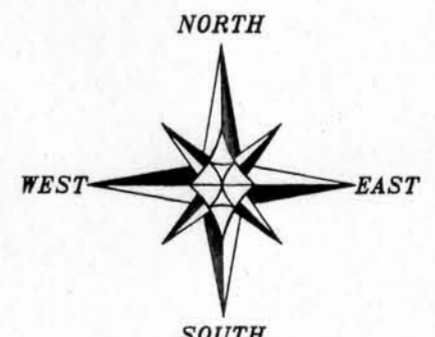

The West line of the SW 1/4 of Section 15 is assumed to bear S 01°57'08" E.

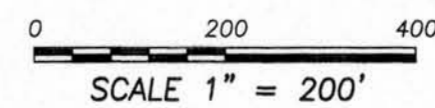

PLAT OF SURVEY

PREPARED FOR: DICK WIEDENBECK
LOCATED IN SECTION 15, T4N R4W, TOWN OF BEETOWN, GRANT COUNTY, WISCONSIN



4211 HWY 81 E
LANCASTER, WI 53813
PHONE 608-723-8363
FAX 608-723-6702

JOB NO: 10s303 FIELDBOOK: TDSR
G:\T4NR4W\22 DRAWN BY: AJ AUSTIN
H:\PLAT\T4NR4W\15\10s303-WIEDENBECK CREW: BS-SA
SHEET 1 OF 1