

NO.	GRANTOR	GRANTEE	INSTRUMENT	D A T E	Book	Page	RECORD	DATE	REMARKS	A R E A
1	Henry C. Deobor	CH&N Ry.Co.	Q.C.D.	June 9, 1853	31	37	June 11, 1853			2.43
2	Heirs of R.M. Huntington	CH&N Ry.Co.	Deed	May 23, 1875	31	8	Aug. 23, 1875			1.90
3	Mary Smith, et al A. A. Stephens (Guardian)	CH&N Ry.Co.	W. D. Ordn. Deed	Oct. 27, 1852 Aug. 23, 1875	38 35	198 209	Dec. 26, 1859 Dec. 26, 1859			1.24
4	Same Deed as Parcel #2	CH&N Ry.Co.	Deed	May 22, 1875	73	515	Aug. 23, 1875			40350
5	William Tenney	CH&N Ry.Co.	W. D.	Dec. 3, 1856	107	306	Dec. 16, 1856			2.94
6	William Fruessing	CH&N Ry.Co.	Deed	May 22, 1875	73	515	Aug. 23, 1875			1.94
7	Same Deed as Parcel #6	CH&N Ry.Co.	Deed	Feb. 25, 1875	73	516	Aug. 23, 1875			1.31
8	Francis Rose	CH&N Ry.Co.	Deed	Feb. 25, 1875	73	517	Aug. 23, 1875			33350
9	Thomas Chapman	CH&N Ry.Co.	Deed	Feb. 25, 1875	73	517	Aug. 23, 1875		Held by adverse possession since 1875.	6.71
10	Possessory Title									13500
11	Mrs. D. Jones, et al Hannah S. Jayley	CH&N Ry.Co. to CH&N Ry.Co.	Q.C.D. Q.C.D. Deed	May 24, 1853 May 31, 1853	98 100	570 24	June 11, 1853 June 14, 1853			2.32
12	H. Robbins Hanna Robbins	CH&N Ry.Co. CH&N Ry.Co.	W. D. W. D.	Jan. 3, 1855 Sept. 3, 1856	98 97	286 236	Jan. 10, 1855 Oct. 2, 1856			1.98
13	Wash. H. Virgin	CH&N Ry.Co.	W. D.	Sept. 3, 1856	97	236	Oct. 2, 1856			

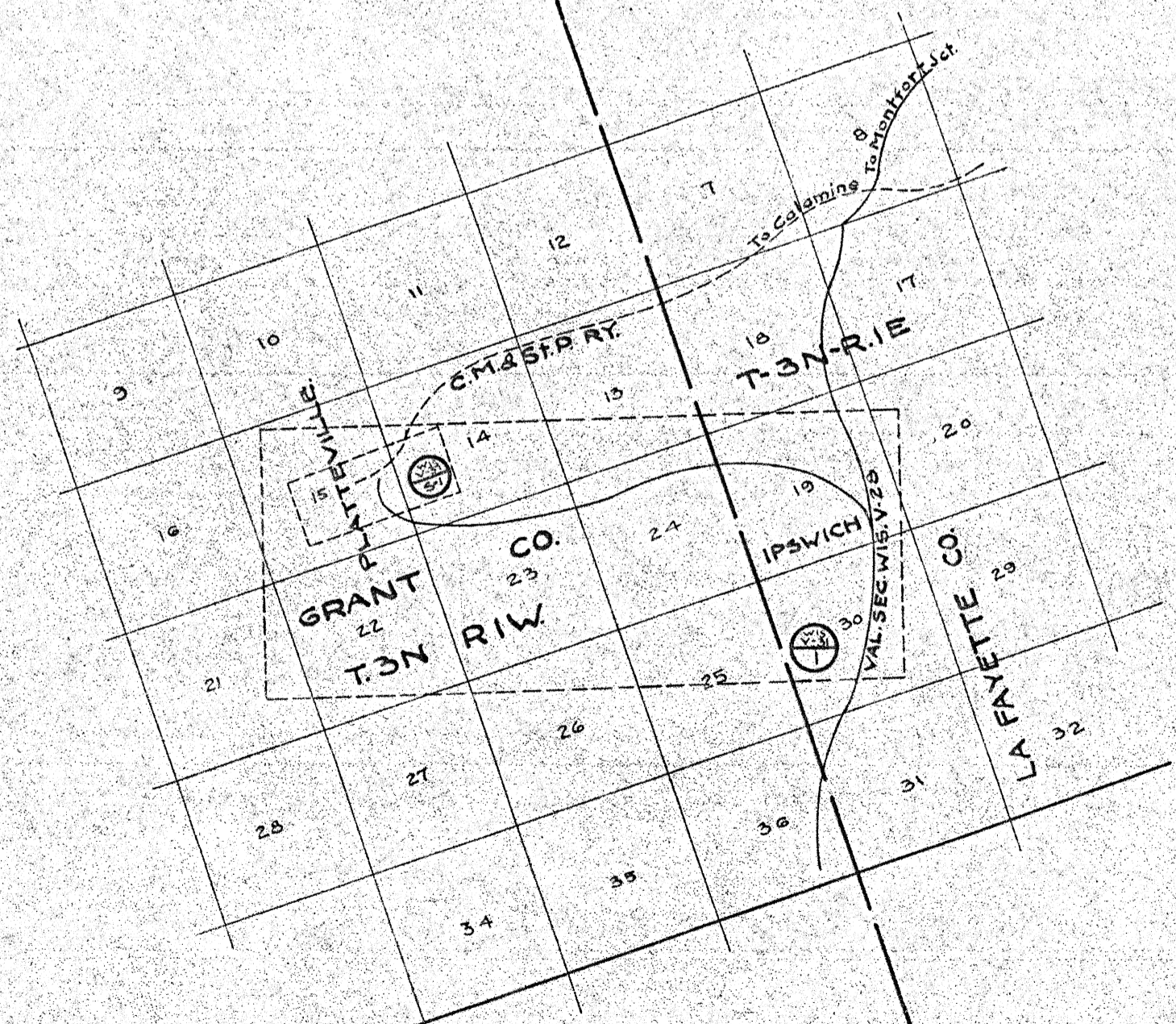

STATE OF ILLINOIS
COUNTY OF COOK

I, the undersigned, officer of the Chicago and North Western Railway, do hereby certify that this is a correct MAP in a series of 1 primary sheets and 1 supplemental sheets of said Railway from survey station 1371+00 to survey station 1569+58, MADISON Division State of WISCONSIN prepared from the records of said company.

Correct *Howard S. Sumner*
Valuation Engineer

Subscribed and sworn before me this 24th day of Jan. 1918.

Howard S. Sumner
Notary Public in and for the County of Cook, State of Illinois
My commission expires April 27th 1921.

RIGHT OF WAY AND TRACK MAP
CHICAGO AND NORTH-WESTERN RAILWAY
OPERATED BY THE
C. & N-W. RY. CO.
MADISON DIVISION
IPSWICH TO PLATTEVILLE, WIS.
STA. 1371+00 TO STA. 1569+58
SCALE 1-IN = 400 FT. JUNE 30, 1917.
OFFICE OF CHIEF ENGINEER
CHICAGO, ILL.

PLATTED - R.A.W. - MAY 8, 1917
CHECKED - S.K.V. - JUNE 1, 1917