

COMMISSIONERS

JERRY DONOHUE, CHAIRMAN
FRED J. SEGUIN, VICE-CHAIRMAN
K. G. KURTENACKER, SECRETARY



A. L. HAMBRECHT
CONSTRUCTION ENGINEER
WM. HOENIG
MAINTENANCE ENGINEER
C. R. STOKES
MATERIAL ENGINEER
C. H. KIRCH
BRIDGE ENGINEER
W. B. BLAIR
CHIEF ACCOUNTANT

W. C. BUETOW
STATE HIGHWAY ENGINEER

WISCONSIN HIGHWAY COMMISSION
STATE CAPITOL ANNEX

MADISON

January 26, 1931.

Mr. J. T. Webb,
County Clerk, Grant County,
Lancaster, Wisconsin

Mr. A. W. DiVall, Chairman,
Grant County Highway Committee,
Fennimore, Wisconsin

Gentlemen:

SUBJECT: Federal Aid Project No. 415-B
Mt. Ida-Fennimore Road
U. S. Highway No. 18-61
Grant County
Relocation Order.

It having been deemed necessary for the proper improvement of a state trunk highway to relocate or widen a portion thereof, a plat showing the old and the new locations and a copy of the order of the State Highway Commission are hereby filed with each of you, as required by law.

Very truly yours,

WISCONSIN HIGHWAY COMMISSION,

By

K. G. Kurtenacker
K. G. Kurtenacker,
Secretary.

KGK: AP
cc-DE#9
Henry Mink, Lancaster, Wis.
W.B.B.



STATE HIGHWAY COMMISSION

STATE OF WISCONSIN

FEDERAL AID PROJECT NO. 415-B-
MT. IDA-FENNIMORE ROAD
U. S. HIGHWAY NO. 18-61
GRANT COUNTY
RELOCATION ORDER

A resolution was presented to the Commission by the Secretary as follows:

Due to the proposed construction of the above named project which extends along a state trunk highway known as U. S. Highway No. 18-61 as located in the state trunk highway layout of 1923, or subsequently located in accordance with the Statutes, from a point 65 feet north and 570 feet west of the south one-quarter (1/4) corner of Section 15, Town 6 North, Range 3 West, extending thence northeasterly, southeasterly and easterly to the south one-quarter (1/4) corner of Section 18, Township 6 North, Range 2 West, it becomes necessary for the proper construction and improvement of U. S. Highway No. 18-61 to make certain relocations and to secure certain additional right of way. A plat of the said relocations and of the right of way to be acquired, marked "Plat of Right of Way Required, Federal Aid Project No. 415-B, Mt. Ida-Fennimore Road, U.S.H. No. 18-61, Grant County", was presented, the same being sheet No. 3 of the plans for said Federal Aid Project No. 415-B.

THEREFORE, BE IT FOUND AND DETERMINED that the alignment shown on the plat marked "Plat of Right of Way Required, Federal Aid Project No. 415-B, Mt. Ida-Fennimore Road, U. S. H. No. 18-61, Grant County" be approved; that the state trunk highway be and hereby is changed and relocated in accordance with said plat by authority granted the Commission under Section 83.08 of the Statutes; that the relocations shown thereon be ordered; that the state trunk highway as laid out by the Legislative Committee and the Highway Commission in 1923, or as subsequently located, between the limits shown on said plat, be and hereby is discontinued; that said state trunk highway be officially located as shown on the attached plat; that it be determined that necessity exists for the acquirement of the right of way shown on said plat; that the State Highway Engineer be directed to order the construction of said Federal Aid Project No. 415-B along the alignment shown on the said plat and to secure the right of way necessary for such construction in the manner provided by law for the acquirement of right of way in such cases. All previous actions of the Commission or other authority which conflict herewith are hereby rescinded.

It was moved and seconded that the resolution be adopted. Carried.

The Secretary of the State Highway Commission does hereby certify that the foregoing is a correct copy of the order of the said Commission in the said matter made at its meeting held January 24, 1931, and that the attached plat is a correct copy of the plat named in the order.

Copies of the said order and plat are hereby filed with the County Clerk and with the County Highway Committee of Grant County, in order that the said Committee may deal by contract with the owners of the land required for and of the premises to be affected by such change and make provision for such change within thirty days, as required by law.

STATE HIGHWAY COMMISSION OF WISCONSIN,

By

K. G. Kurtenacker,
Secretary.

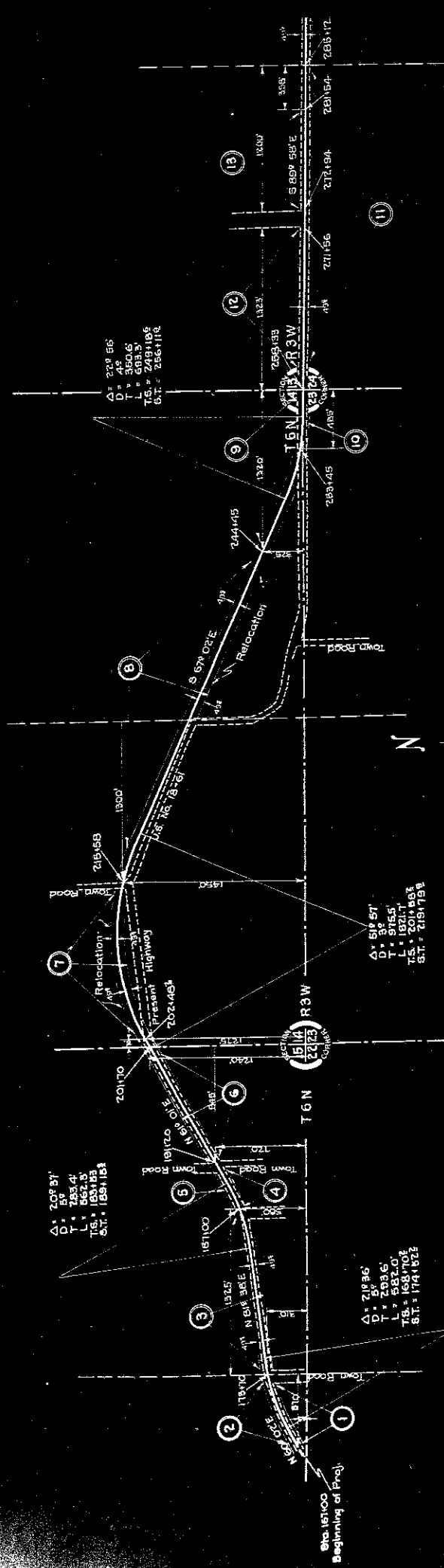

No.	OWNER	Address	Acres	DESCRIPTION	MORTGAGE	Address	AMOUNT PAID
1	Alfred Miller	Edgewater	0.01	SE 1/4 of SW 1/4 Sec. 18 T6R3W	None		
2	Joe Dorner		0.01	SE 1/4 of SW 1/4 Sec. 18 T6R3W	None		
3	Glenn Beck		0.01	SE 1/4 of SW 1/4 Sec. 18 T6R3W	None		
4	Donald Cook		0.19	SE 1/4 of SW 1/4 Sec. 18 T6R3W	None		
5	Wm. Callahan		0.01	SE 1/4 of SW 1/4 Sec. 18 T6R3W	None		
6	Walter Peterson		2.68	NW 1/4 of SW 1/4 Sec. 18 T6R3W	None		
7	Edmund Peterson		0.01	SE 1/4 of SW 1/4 Sec. 18 T6R3W	None		
8	Edmund Peterson		0.01	SE 1/4 of SW 1/4 Sec. 18 T6R3W	None		
9	Edmund Peterson		0.01	SE 1/4 of SW 1/4 Sec. 18 T6R3W	None		
10	Edmund Peterson		0.01	SE 1/4 of SW 1/4 Sec. 18 T6R3W	None		
11	Edmund Peterson		0.01	SE 1/4 of SW 1/4 Sec. 18 T6R3W	None		
12	Edmund Peterson		0.01	SE 1/4 of SW 1/4 Sec. 18 T6R3W	None		
13	Edmund Peterson		0.01	SE 1/4 of SW 1/4 Sec. 18 T6R3W	None		
14	Edmund Peterson		0.01	SE 1/4 of SW 1/4 Sec. 18 T6R3W	None		
15	Edmund Peterson		0.01	SE 1/4 of SW 1/4 Sec. 18 T6R3W	None		
16	Edmund Peterson		0.01	SE 1/4 of SW 1/4 Sec. 18 T6R3W	None		
17	Edmund Peterson		0.01	SE 1/4 of SW 1/4 Sec. 18 T6R3W	None		
18	Edmund Peterson		0.01	SE 1/4 of SW 1/4 Sec. 18 T6R3W	None		
19	Edmund Peterson		0.01	SE 1/4 of SW 1/4 Sec. 18 T6R3W	None		
20	Edmund Peterson		0.01	SE 1/4 of SW 1/4 Sec. 18 T6R3W	None		

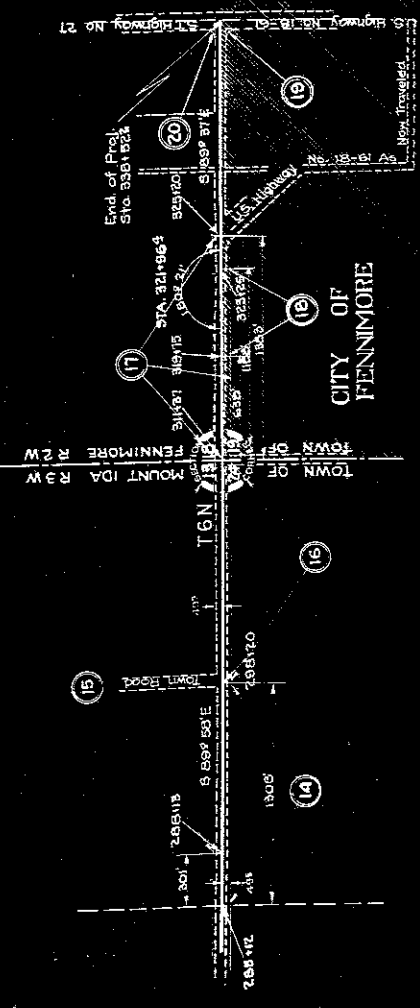

PLAT OF RIGHT OF WAY REQUIRED
 FEDERAL AID PROJECT NO. 415 "B"
 MOUNT IDA — FENNIMORE ROAD
 U.S.H.NO. 18-61 GRANT COUNTY