

COMMISSIONERS

THOMAS F. DAVLIN, CHAIRMAN
WM. E. O'BRIEN, VICE-CHAIRMAN
THOS. J. PATTISON, SECRETARY



E. L. ROETTIGER
STATE HIGHWAY ENGINEER

W. B. BLAIR
CHIEF ACCOUNTANT

STATE HIGHWAY COMMISSION OF WISCONSIN

STATE OFFICE BUILDING

MADISON

February 9, 1939

Mr. Alonzo Aupperle,
County Clerk, Grant County
Lancaster, Wisconsin

Mr. A. W. DiVall, Chairman
Grant County Highway Committee
Fennimore, Wisconsin

Gentlemen:

SUBJECT: Div. Job No. 9572
Mount Ida-Fennimore Road
U.S.H. No. 18
Grant County
Relocation Order

It having been deemed necessary for the proper improvement of a state trunk highway to relocate or widen a portion thereof, a plat showing the old and the new locations and a copy of the order of the State Highway Commission are hereby filed with each of you, as required by law.

Very truly yours,

STATE HIGHWAY COMMISSION OF WISCONSIN

Thos. J. Pattison,
Secretary.

TJP:AP

cc:DE#9

:Eugene Croft, Lancaster

:W.B.B.

STATE HIGHWAY COMMISSION

STATE OF WISCONSIN

DIVISION JOB NO. 9572
MOUNT IDA-FENNIMORE ROAD
U. S. HIGHWAY NO. 18
GRANT COUNTY
RELOCATION ORDER

(Revision of Relocation Order noted in Paragraph 12 of the Minutes of the Meeting of November 7, 1938)

A resolution was presented to the Commission by the Secretary as follows:

Due to the proposed construction of the above named project which extends along a state trunk highway known as U.S. Highway No. 18, as located in the state trunk highway layout of 1923, or subsequently located in accordance with the Statutes, from a point 1,195 feet east and 870 feet south of the northwest corner of Section 29, Township 6 North, Range 3 West, thence northeasterly to a point 265 feet north and 155 feet east of the south one-quarter corner of Section 18, Township 6 North, Range 3 West, it becomes necessary for the proper construction and improvement of said U.S. Highway No. 18 to make certain relocations and to secure certain additional right of way. A plat of the said relocations and the right of way to be acquired, marked "Revised January 27, 1939, Revised November 1, 1938, Plat of Right of Way Required, Division Job No. 9572, Mount Ida-Fennimore Road, U.S.H. No. 18, Grant County," was presented, the same being sheets Nos. 4 and 5 of the plans for said Division Job No. 9572.

THEREFORE, BE IT FOUND AND DETERMINED that the alignment shown on the plat marked, "Revised January 27, 1939, Revised November 1, 1938, Plat of Right of Way Required, Division Job No. 9572, Mount Ida-Fennimore Road, U.S.H. No. 18, Grant County," be approved; that the state trunk highway be and hereby is changed and relocated in accordance with said plat by authority granted the Commission under Section 83.08 of the Statutes; that the relocations shown thereon be ordered; that the state trunk highway as laid out by the Legislative Committee and the Highway Commission in 1923, or as subsequently located, between the limits shown on said plat, be and hereby is discontinued; that said state trunk highway be officially located as shown on the attached plat; that it is necessary to take for highway purposes, in order to carry out said improvement, the land within the limits of said highway as relocated and shown on said plat; that the State Highway Engineer be directed to order the construction of said Division Job No. 9572 along the alignment shown on the said plat and secure the right of way necessary for such construction in the manner provided by law for the acquirement of right of way in such cases. All previous actions of the Commission or other authority which conflict herewith are hereby rescinded.

It was moved and seconded that the resolution be adopted. Carried.

The Secretary of the State Highway Commission does hereby certify that the foregoing is a correct copy of the order of the said Commission in the said matter made at its meeting held February 7, 1939, and that the attached plat is a correct copy of the plat named in the order.

Copies of the said order and plat are hereby filed with the county clerk and with the county highway committee of Grant County, in order that the said committee may negotiate for and obtain an easement, conveyance or deed from the owners of the land required for and of the premises to be affected by such change and make provision for such change within 90 days as required by law.

STATE HIGHWAY COMMISSION OF WISCONSIN

By

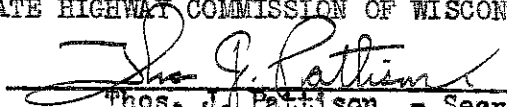
Thos. J. Pattison - Secretary.

STATE	PLAT NO.	DATE
4	WISC. 9572	4

REVISION AND NO. 9572



LOCATION SKETCH

PAR.	OWNER	DESCRIPTION	ACRES	FENCE REQS.
1	L. C. SPEAKER	NW1/4-NW1/4 SEC. 29 T6N R3W	0.06	7
2	CHESTER MONYPENNY	NE1/4-NW1/4 SEC. 29 T6N R3W	0.06	5
3	JOE A. EDGE	NE1/4-NW1/4 NW1/4 SEC. 29 SW1/4 SEC. 29 T6N R3W	5.22	379
4	MRS. L. VESPERMAN	NW1/4-NW1/4 SEC. 29 T6N R3W	0.13	23
5	KRUEL ESTATE	SW1/4 SEC. 21 T6N R3W	4.21	299
6	F. E. MCFICKAN	NE1/4-SW1/4 NW1/4 SEC. 21 T6N R3W	6.98	377
7A	LEWIS HOWELL	NE1/4-NW1/4 SEC. 29 T6N R3W	2.57	63

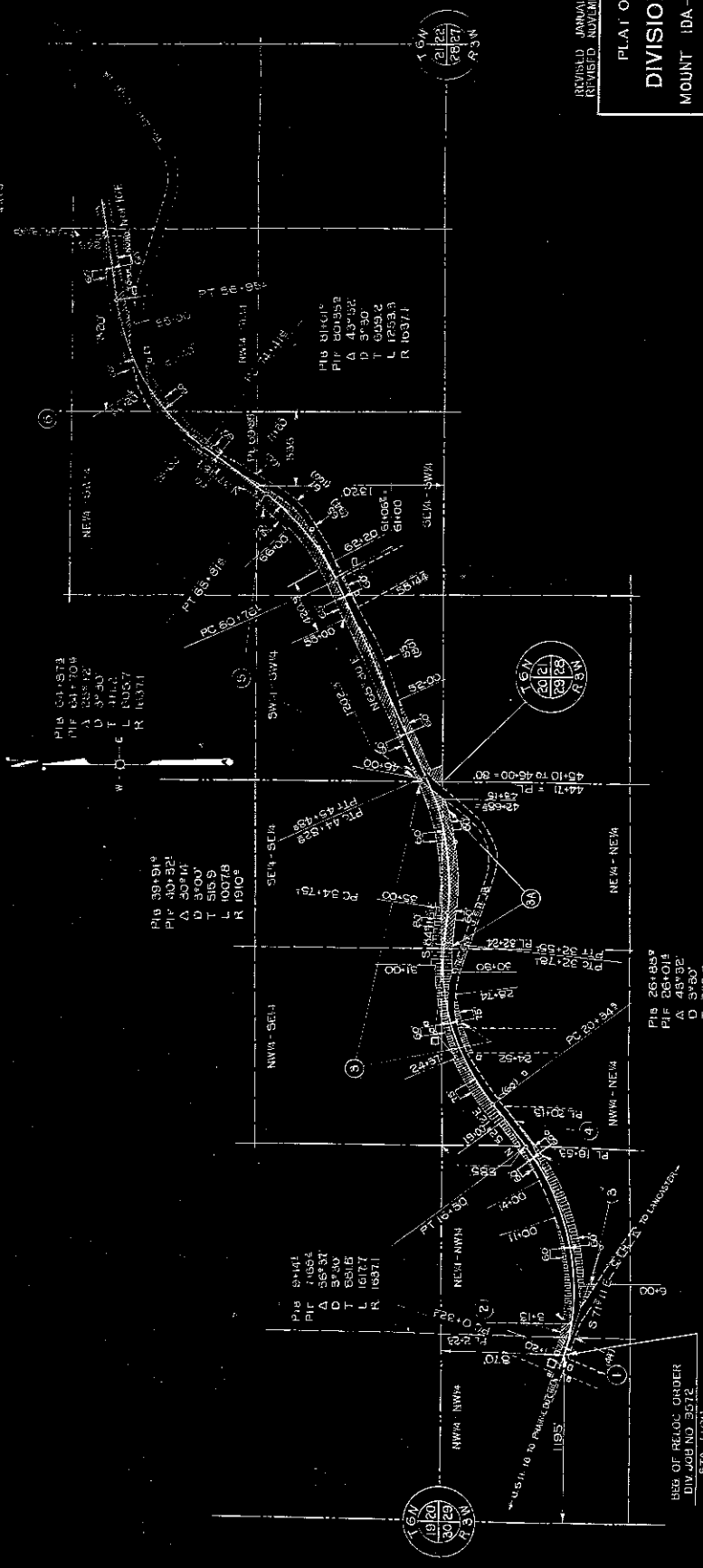

REVISION AND NO. 21 1938
REVISED NOVEMBER, 1938.

PLAT OF RIGHT OF WAY REQUIRED
DIVISION JOB NO. 9572
 MOUNT IDA — FENNIMORE ROAD
 U.S.H.NO. 18 GRANT COUNTY

SCALE
 1" = 40'

REG. OF RELOC. ORDER
 DIV. JOB NO. 9572
 STA. 1+00

167
 182
 202
 231N

167
 182
 202
 231N

167
 182
 202
 231N

