



State of Wisconsin \ DEPARTMENT OF TRANSPORTATION



DIVISION OF HIGHWAYS AND TRANSPORTATION SERVICES

4802 Sheboygan Avenue  
P.O. Box 7916  
Madison, WI 53707-7916

June 11, 1985

Mr. Nelson J. Huske, Commissioner  
Grant County Highway Department  
1011 North Adams Street  
Lancaster, Wisconsin 53813

ROADS DIVISION

JUN 11 1985

RECEIVED

Ms. Dorothea Eck  
Grant County Clerk  
Courthouse  
130 West Maple Street  
P.O. Box 191  
Lancaster, Wisconsin 53813

Dear Sir and Madame:

Project 1209-0-21  
Dickeyville-Platteville Road  
USH 151  
Grant County

The Department of Transportation deems it necessary to make certain changes in location and to acquire certain lands and interests in lands for the proper improvement or maintenance of the above-designated project and highway. The relocation order of the Department and the map showing the highway as laid out and established and the lands and interests to be acquired are transmitted herewith.

The attached relocation order sets forth the provisions by whom the right of way will be acquired.

Sincerely,

*M. J. Schaeffer*  
for Maryin J. Schaeffer, P.E.  
Administrator

Enc.

CC: Trans. Dist. 1  
Real Estate

RELOCATION ORDER

R-0-572

State of Wisconsin/Department of Transportation  
DIVISION OF HIGHWAYS AND TRANSPORTATION FACILITIES

| PROJECT                | NAME OF ROAD                 | HIGHWAY                | COUNTY |
|------------------------|------------------------------|------------------------|--------|
| 1209-0-21              | Dickeyville-Platteville Road | USH 151                | Grant  |
| RIGHT OF WAY PLAT DATE | PLAT SHEET NUMBERS           | DATE OF PREVIOUS ORDER |        |
| May 7, 1985            | 4.0 through 4.3              | - - - -                |        |

Description of Termini of Project

From a point 693.91 feet south of and 1,143.42 feet west of the east one-quarter corner of Section 1, Township 2 North, Range 2 West, thence northeasterly to a point 934.20 feet north of and 164.00 feet east of the said east one-quarter corner of Section, Township and Range.

To properly establish, lay out, widen, enlarge, extend, construct, reconstruct, improve, or maintain a portion of the highway designated above, it is necessary to relocate or change and acquire certain lands or interests in lands as shown on the right of way plat for the above project.

To effect this change, pursuant to authority granted under Sections 84.02(3) and 84.09, Wisconsin Statutes, the Department of Transportation hereby orders that:

1. The said highway is hereby laid out and established to the lines and widths as shown on the plat.
2. The required lands or interests in lands as shown on the plat shall be acquired by the Division of Highways and Transportation Facilities, in the name of the State of Wisconsin, pursuant to the provisions of Section 84.09(1) or (2), Wisconsin Statutes.
- ~~3. This order supersedes and amends any previous order issued by the Department.~~

May 23, 1985

Date

*[Handwritten Signature]*  
Deputy  
Administrator

|   |              |
|---|--------------|
| R/W PROJECT NUMBER                              | 1209-00-21   |
| FEDERAL PROJECT NUMBER                          | 4.0          |
| PLAT OF RIGHT OF WAY REQUIRED FOR<br>1209-00-00 |              |
| <b>DICKEYVILLE — PLATTEVILLE ROAD</b>           |              |
| U.S.H. 151                                      | GRANT COUNTY |
| SHEET NUMBER                                    | TOTAL SHEETS |
| 4.0   | 4            |

### Conventional Signs and Abbreviations

- |                                       |   |                                    |  |
|---------------------------------------|---|------------------------------------|--|
| STATE LINE                            | SECTION CORNER  | CEMETERY                           | FOUNDATION OR RUNS                           |
| COUNTY LINE                           | NOTATION FOR COMBUSTIBLE FLUIDS                       | GAS PUMPS                          | BUILDING                                     |
| TOWNSHIP AND RANGE LINES              | BRIDGE  | IRON PIN                           | POWER POLE                                   |
| SECTION LINE                          | STREAM OR RIVER                                       | TELEPHONE POLE                     | VALVE  |
| QUARTER LINE                          | LAKE  | TRANSMISSION TOWER AND LINE        | UNDERGROUND CABLE MARKER                     |
| SIXTEENTH LINE                        | CULVERT (BOX, PIPE OR CATTLE)                         | CHANNEL CHANGE                     | R/W POINT                                    |
| NEW CENTERLINE                        | SLOPE INTERCEPT                                       | RAIL LINE                          | R/W MONUMENT                                 |
| NEW R/W LINE                          | LOT, TIE AND OTHER MINOR DASHED LINES                 | NO ACCESS (BY STATUTORY AUTHORITY) | WINDMILL                                     |
| EXISTING R/W LINE                     | UNDERGROUND FACILITY (GAS, TELEPHONE, ELECTRIC, ETC.) | LIMITED HIGHWAY EASEMENT           | SIGN   |
| PROPERTY LINE                         | BEAM GUARD  | FENCE                              | SILO, MANHOLE, WELL, VENT, SEPTIC TANK, ETC. |
| CORPORATE LIMITS                      |   |                                    | TREES (DECIDUOUS)                            |
| SLOPE INTERCEPT                       |   |                                    | TREES (CONIFEROUS)                           |
| LOT, TIE AND OTHER MINOR DASHED LINES |   |                                    |  |

- ACRES  
AHEAD  
ALUMINUM  
BACK  
BARN  
CABLE MARKER  
CORNER  
ELECTRIC  
GARAGE  
HOUSE  
MONUMENT  
LIMITED HIGHWAY EASEMENT  
MONUMENT  
PEDESTAL  
PERMANENT  
PROPERTY LINE  
REMAINING  
RIGHT OF WAY  
SECTION  
SHED  
SQUARE FEET  
TELEPHONE  
TEMPORARY
- GN
- AC.  
A.H.  
ALUM.  
BK.  
B.  
C.M.  
COR.  
ELEC.  
G.  
H.  
L.H.E.  
MON.  
PED.  
PERMA.  
P.L.  
REM.  
R/W  
SEC.  
S.  
S.F.  
TEL.  
TEMP.

**NOTES**

COORDINATES AND BEARINGS ON THIS PLAT ARE ORIENTED TO THE WISCONSIN COORDINATE SYSTEM SOUTH ZONE. ALL PLAT DISTANCES ARE GROUND LENGTH AND MAY BE CONVERTED TO GRID LENGTH BY MULTIPLYING THE DISTANCE BY THE GRID FACTOR PROVIDED ON THE DETAIL SHEETS.

RIGHT OF WAY MONUMENTS ARE TYPE 2 AND ARE PLACED PRIOR TO OR AT THE TIME OF LAND TITLE TRANSFER.

RIGHT OF WAY BOUNDARIES ARE DEFINED WITH COURSES OF THE PERIMETER OF THE HIGHWAY LANDS REFERENCED TO THE U.S. PUBLIC LAND SURVEY OR OTHER SURVEYS OF PUBLIC RECORD.

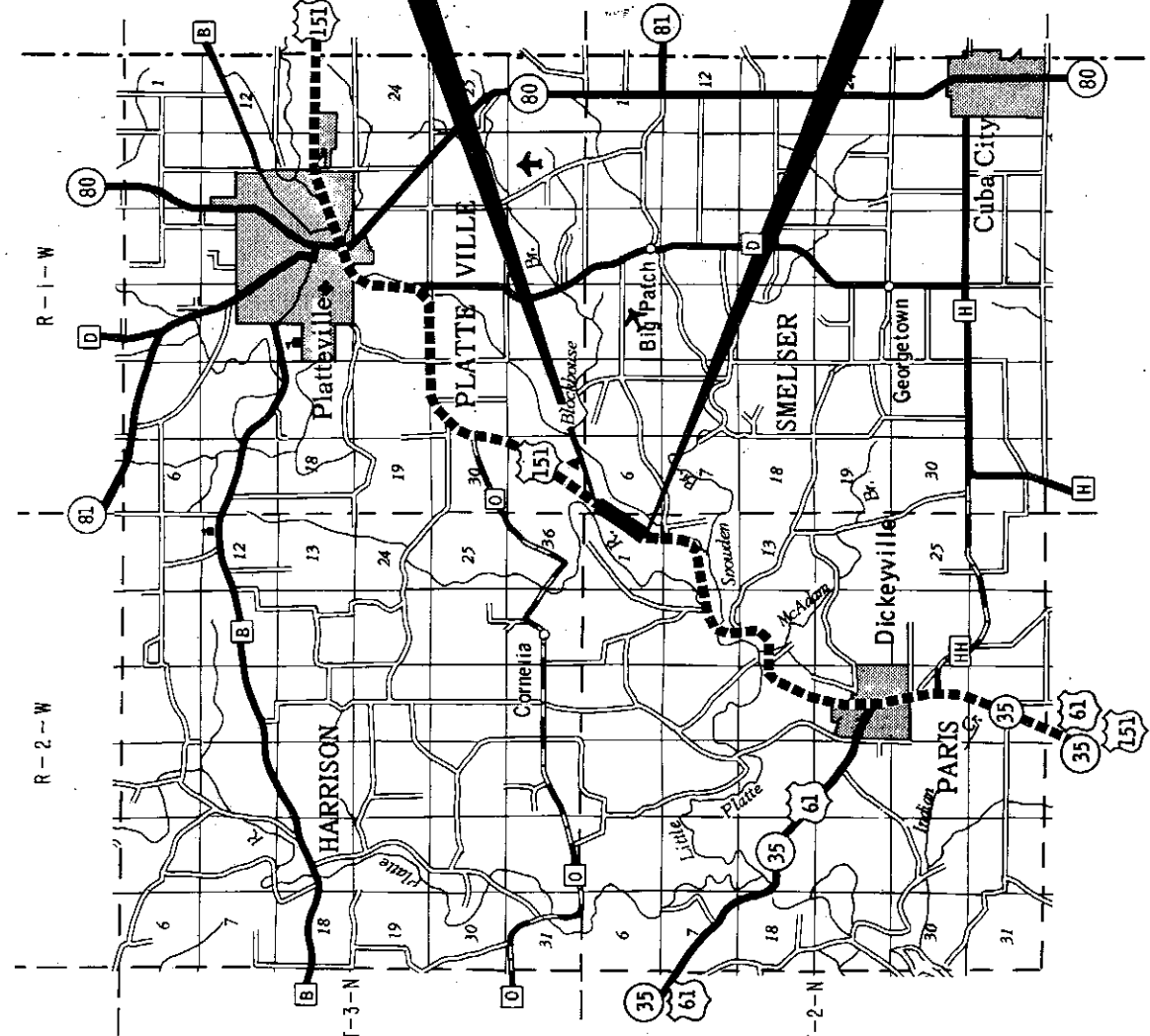

END RELOCATION ORDER  
934.20' N. of and 164.00' E. of the E. 1/4 Cor. of  
Sec. 1, T. 2 N., R. 2 W.

BEGIN RELOCATION ORDER  
683.91' S. of and 1.143.42' W. of the E. 1/4 Cor. of  
Sec. 1, T. 2 N., R. 2 W.

|  |   |
|--|---|
| REVISION   | DATE  |
|  |   |
| STATE OF WISCONSIN<br>DEPARTMENT OF TRANSPORTATION   |   |
| Approved:  | <i>Walter J. Kowalski</i><br>District Transportation Director |
| Date:  | 5/4/85  |
| Approved:  | <i>B.J. Mullen</i><br>Director, Bureau of Real Estate         |
| Date:  | 5/14/85   |
| U.S. DEPARTMENT OF TRANSPORTATION<br>FEDERAL HIGHWAY ADMINISTRATION<br>REGION 5 WISCONSIN DIVISION |   |
| Approved:  |   |
| Date:  |   |
| Division Administrator   |   |

TOTAL NET LENGTH OF CENTERLINE = 0.395 MILES

# SCHEDULE OF LANDS & INTERESTS REQUIRED

AREAS SHOWN IN THE TOTAL ACRES COLUMN MAY BE APPROXIMATE AND ARE DERIVED FROM TAX ROLLS OR OTHER AVAILABLE SOURCES AND MAY NOT INCLUDE LANDS OF THE OWNER WHICH ARE NOT CONTIGUOUS TO THE AREA TO BE ACQUIRED.

|                    |            |                        |              |
|--------------------|------------|------------------------|--------------|
| REVISION DATE      | COUNTY     | DATE                   | SHEET NUMBER |
|                    | U.S.H. 151 | 5/7/85                 | 4.1          |
| R/W PROJECT NUMBER |            | FEDERAL PROJECT NUMBER |              |
| 1209-00-21         |            |                        |              |

| PARCEL NUMBER | SHEET NUMBER | OWNER(S)                        | INTEREST REQUIRED | TOTAL ACRES OR S.F. |       | R/W ACRES REQUIRED OR S.F. |          | TOTAL ACRES REM. | L.H.E. ACRES TEMP. | L.H.E. ACRES PERM. |
|---------------|--------------|---------------------------------|-------------------|---------------------|-------|----------------------------|----------|------------------|--------------------|--------------------|
|               |              |                                 |                   | EXISTING            | TOTAL | NEW                        | EXISTING |                  |                    |                    |
| 1             | 4.2          | ALLEN N. KLECKNER               | FEE               | 170.60              | 5.61  | 0.44                       | 5.17     | 164.99           |                    |                    |
| 2             | 4.2          | KAY MARIE PLATT                 | FEE               | 175.41              | 0.52  | 0.10                       | 0.42     | 174.89           |                    |                    |
| 3             | 4.2          | GRANT ELECTRIC COOPERATIVE (40) | RELEASE OF RIGHTS |                     |       |                            |          |                  |                    |                    |

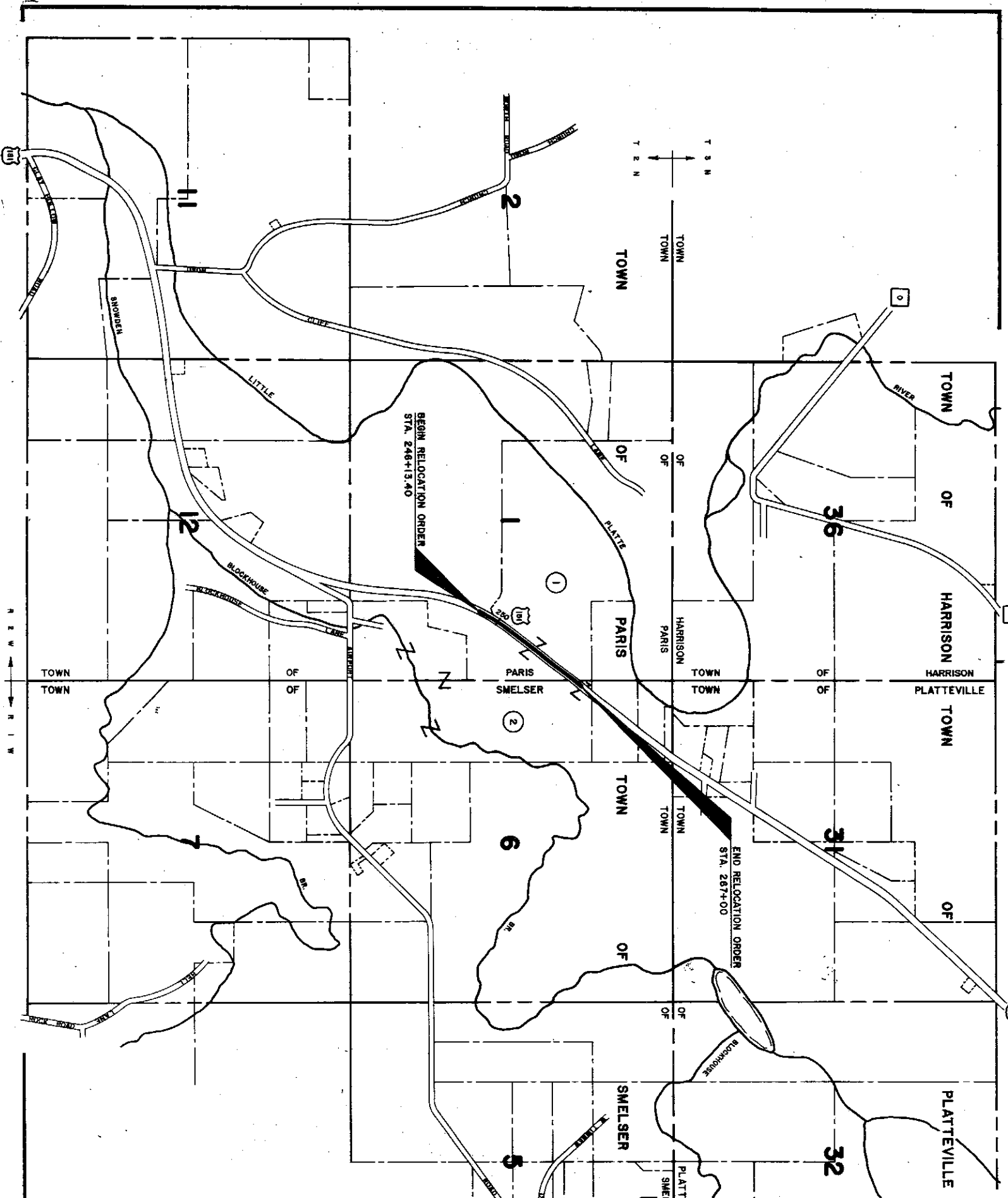

|  |   |              |    |
|--|---|--------------|----|
| REVISION DATE  | 1209 - 00 - 21                                      | SHEET NUMBER | 42 |
| TOTAL PROJECT NUMBER   | PART OF RIGHT OF WAY REQUIRED FOR<br>1209 - 00 - 00 |              |    |
| <b>DICKEYVILLE - PLATTEVILLE ROAD</b><br>U.S.H. 161<br>GRANT COUNTY<br>DATE<br>MAY 7, 1989 |   |              |    |
| NOT TO SCALE   |   |              |    |
| CONSTRUCTION PROJECT NUMBER  |   |              |    |

