



State Highway Commission of Wisconsin

STATE OFFICE BUILDING
1 WEST WILSON STREET
MADISON, WISCONSIN

MAIN OFFICE

June 28, 1963

Mr. Edward J. Nickson, Commissioner
Grant County Highway Department
Box 150
Lancaster, Wisconsin

✓ Miss Mildred Krehn
Acting Grant County Clerk
Courthouse
Lancaster, Wisconsin

Dear Sir and Madam:

SUBJECT: Project T 017-1(20)
Fennimore-Mount Ida Road
U.S.H. 18
Grant County

The Highway Commission deems it necessary to make certain revisions on a previously approved right of way plat and to acquire certain lands and interests in lands according to such revisions, for the proper improvement or maintenance of the above-designated project and highway. The revised relocation order of the Commission and the map showing the highway as laid out and established and the lands and interests to be acquired are transmitted herewith.

~~Highway Commission shall make the necessary acquisitions of lands and interests not previously acquired, pursuant to Section 84.09(1) or (2), Wisconsin Statutes.~~

Very truly yours

STATE HIGHWAY COMMISSION OF WISCONSIN

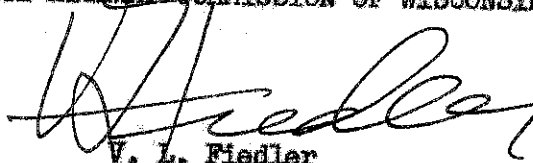
V. L. Fiedler
Secretary

VLF:AK
CC:DE#1
RVL
Enc.

RELOCATION ORDER
BY STATE HIGHWAY COMMISSION OF WISCONSIN

* * * * *

THE STATE HIGHWAY COMMISSION FINDS AND DETERMINES THAT:

The proper establishing, laying out, widening, enlarging, extending, constructing, reconstructing, improving, or maintaining a portion of the highway now designated as U. S. Highway 18, from a point 878 feet west and 391 feet south of the north one-quarter corner of Section 22, Township 6 North, Range 3 West, and extending thence northeasterly to a point 1067 feet east and 460 feet north of the south one-quarter corner of Section 15, Township 6 North, Range 3 West,

and on roads or lands in and about and along and leading to same, requires certain relocation or change and the acquisition of lands or interests in lands as shown on the map or copy thereof marked

"PLAT OF RIGHT OF WAY REQUIRED, PROJECT T 017-1(20)"

for the Pennimore-Mount Ida Road,

U.S. H. 18, Grant County, dated June 25, 1963,

the same being sheet—No.—4 of the plans for said project, and

Pursuant to its authority under Sections 84.02 (3) and 84.09, Wisconsin Statutes,

THE STATE HIGHWAY COMMISSION HEREBY ORDERS THAT:

(1) The said highway is hereby laid out and established to the lines and widths as shown on the said plat.

(2) The required lands or interests in lands as shown on the plat shall be acquired by the County Highway Commission of the county in which the lands are situated pursuant to the provisions of Section 84.09 (2), Wisconsin Statutes. However, said County Highway Commission shall have no authority to settle or compromise any action or proceeding which might arise because of acts done by it in complying with this order without approval or orders by the State Highway Commission. **in the name of the State of Wisconsin by the Highway Commission pursuant to the provisions of Section 84.09(1) or (2), Wisconsin Statutes.**

(3) Buildings, fixtures or chattels acquired incident to the acquisition of lands or rights in lands under this order, and to be removed, shall, subject to approval of the Highway Commission, be sold by the County Highway Commission at public or private sale to the highest bidder, and the net proceeds of such sale paid into the state highway fund.

(4) This order supersedes and amends the previous order issued by the Commission on May 29, 1963.

* * * * *

The foregoing order was issued by the State Highway Commission and entered in the minutes of its meeting on June 28, 1963.

Secretary, State Highway Commission of Wisconsin

DATE	BY	REVISION
12-22-83		
12-22-83		

NO. OF SHEETS	NO. OF SHEETS	NO. OF SHEETS
22.1	17.1	21.20
4	4	4

DATE	BY	REVISION
12-22-83		
12-22-83		

DATE	BY	REVISION
12-22-83		
12-22-83		

DATE	BY	REVISION
12-22-83		
12-22-83		

DATE	BY	REVISION
12-22-83		
12-22-83		

DATE	BY	REVISION
12-22-83		
12-22-83		

DATE	BY	REVISION
12-22-83		
12-22-83		

DATE	BY	REVISION
12-22-83		
12-22-83		

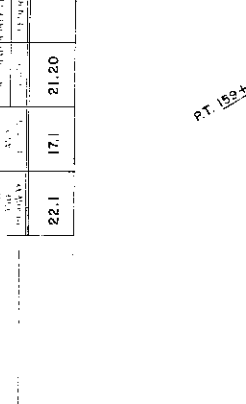

BEGIN RELOCATION ORDER
 PROJ. T017-1(20), STA. 133+30.8
 80' WEST AND 50' SOUTH OF THE
 NORTH 1/4 COR., SEC. 16, T6N, R3W

END RELOCATION ORDER
 PROJ. T017-1(20), STA. 152+41.5
 STA. 155+46, PROJECT P.O.T. (123)
 1087' EAST AND 460' NORTH OF THE
 SOUTH 1/4 COR., SEC. 16, T6N, R3W

STANDARD ABBREVIATIONS

H.	HOUSE
S.	SHED
CONC.	CONCRETE
FOUND.	FOUNDATIONS
PROP.	PROPERTY LINE
A.C.	ACRES
PERM.	PERMANENT
PROJ.	PROJECT
STA.	STATION
S.B.P.	SEPTIC BREAKER PIPE

SCHEDULE OF LANDS & INTERESTS REQUIRED

PARCEL NUMBER	OWNER	INTERESTS REQUIRED	ACRES
1	CLIFFORD MC NAMER	SCENIC EASEMENT	—
2	CECIL HOWELL	SCENIC EASEMENT	—
3	HELEN M. WINANDY	SCENIC EASEMENT	—
4, 13		SCENIC EASEMENT	—
5		SCENIC EASEMENT	—

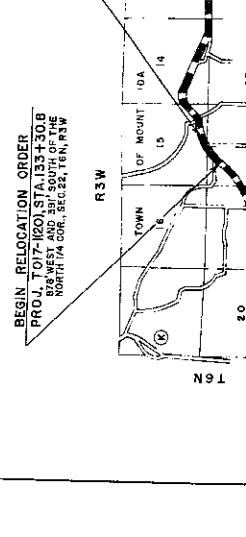

NOTE:
 BEARINGS SHOWN ON THIS PLAT ARE THE TRUE
 BEARINGS OF EACH TANGENT TO THE NEAREST MINUTE

STATE HIGHWAY COMMISSION OF WISCONSIN
 PLAT OF RIGHT OF WAY REQUIRED
 PROJECT T 017-1(20)
 FENNIMORE - MOUNT IDA ROAD
 U.S.H. 16 GRANT COUNTY

SCALE
 1" = 100 FEET

DATE: APRIL 14, 1983