

COMMISSIONERS

THOMAS F. DAVLIN, CHAIRMAN
WM. E. O'BRIEN, VICE-CHAIRMAN
THOS. J. PATTISON, SECRETARY

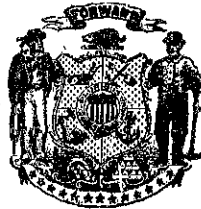

E. L. ROETTIGER
STATE HIGHWAY ENGINEER

W. B. BLAIR
CHIEF ACCOUNTANT

STATE HIGHWAY COMMISSION OF WISCONSIN

STATE OFFICE BUILDING

MADISON

January 24, 1936.

Mr. Alonzo Aupperle,
County Clerk, Grant County
Lancaster, Wisconsin

Mr. Edw. P. Noble,
County Clerk, Lafayette County
Darlington, Wisconsin

Mr. A. W. DiVall, Chairman
Grant County Highway Committee
Fennimore, Wisconsin

Mr. Charles B. Dugdale, Chairman
Lafayette County Highway Committee
Platteville, Wisconsin

Gentlemen:

SUBJECT: Div. Jobs Nos. 9409 & 9510
Shullsburg-East Dubuque Rd.,
S.T.H. No. 11
Grant and Lafayette Counties
Relocation Order

It having been deemed necessary for the proper improvement of a state trunk highway to relocate or widen a portion thereof, a plat showing the old and the new locations and a copy of the order of the State Highway Commission are hereby filed with each of you, as required by law.

Very truly yours,

STATE HIGHWAY COMMISSION OF WISCONSIN,

By

Thos. J. Pattison,
Secretary.

TJP:AP

cc:DE#9

:Henry Mink, Lancaster
:H.I. Shockley, Darlington
:W.B.B.

STATE HIGHWAY COMMISSION

STATE OF WISCONSIN

DIVISION JOBS NOS. 9409 & 9510
SHULLSBURG-EAST DUBUQUE ROAD
STATE TRUNK HIGHWAY NO. 11
GRANT AND LAFAYETTE COUNTIES
RELOCATION ORDER

A resolution was presented to the Commission by the Secretary as follows:

Due to the proposed construction of the above named project which extends along State Trunk Highway No. 11, as located in the state trunk highway layout of 1923, or subsequently located in accordance with the Statutes, from a point 1,796 feet west and 2,645 feet north of the south-east corner of Section 12, Township 1-North, Range 1 West, thence easterly to a point 1,100 feet west and 2,660 feet north of the south-east corner of Section 8, Township 1 North, Range 1 East, it becomes necessary for the proper construction and improvement of said State Trunk Highway No. 11 to make certain relocations and to secure certain additional right of way. A plat of the said relocations and the right of way to be acquired, marked "Plat of Right of Way Required, Division Job No's. 9409 & 9510, Shullsburg-East Dubuque Road, S.T.H. No. 11, Grant & Lafayette Counties," was presented, the same being sheet No. 4 of the plans for said Division Jobs Nos. 9409 and 9510.

THEREFORE, BE IT FOUND AND DETERMINED that the alignment shown on the plat marked "Plat of Right of Way Required, Division Job No's. 9409 & 9510, Shullsburg-East Dubuque Road, S.T.H. No. 11, Grant & Lafayette Counties" be approved; that the state trunk highway be and hereby is changed and relocated in accordance with said plat by authority granted the Commission under Section 83.08 of the Statutes; that the relocations shown thereon be ordered; that the state trunk highway as laid out by the Legislative Committee and the Highway Commission in 1923, or as subsequently located, between the limits shown on said plat, be and hereby is discontinued; that said state trunk highway be officially located as shown on the attached plat; that it is necessary to take for highway purposes, in order to carry out said improvement, the land within the limits of said highway as relocated and shown on said plat; that the State Highway Engineer be directed to order the construction of said Division Jobs Nos. 9409 and 9510 along the alignment shown on the said plat and secure the right of way necessary for such construction in the manner provided by law for the acquirement of right of way in such cases. All previous actions of the Commission or other authority which conflict herewith are hereby rescinded.

It was moved and seconded that the resolution be adopted. Carried.

The Secretary of the State Highway Commission does hereby certify that the foregoing is a correct copy of the order of the said Commission in the said matter made at its meeting held January 21, 1936, and that the attached plat is a correct copy of the plat named in the order.

Copies of the said order and plat are hereby filed with the County Clerk and with the County Highway Committee of Grant and Lafayette Counties, in order that the said Committees may deal by contract with the owners of the land required for and of the premises to be affected by such change and make provision for such change within thirty days, as required by law.

STATE HIGHWAY COMMISSION OF WISCONSIN,

By

Thos. J. Pattison, Secretary.

NO. 9409	STATE	PLAT NO.	DATE
9409	MO.	4	1917

SECTION FOR NO. 9409 & 9510

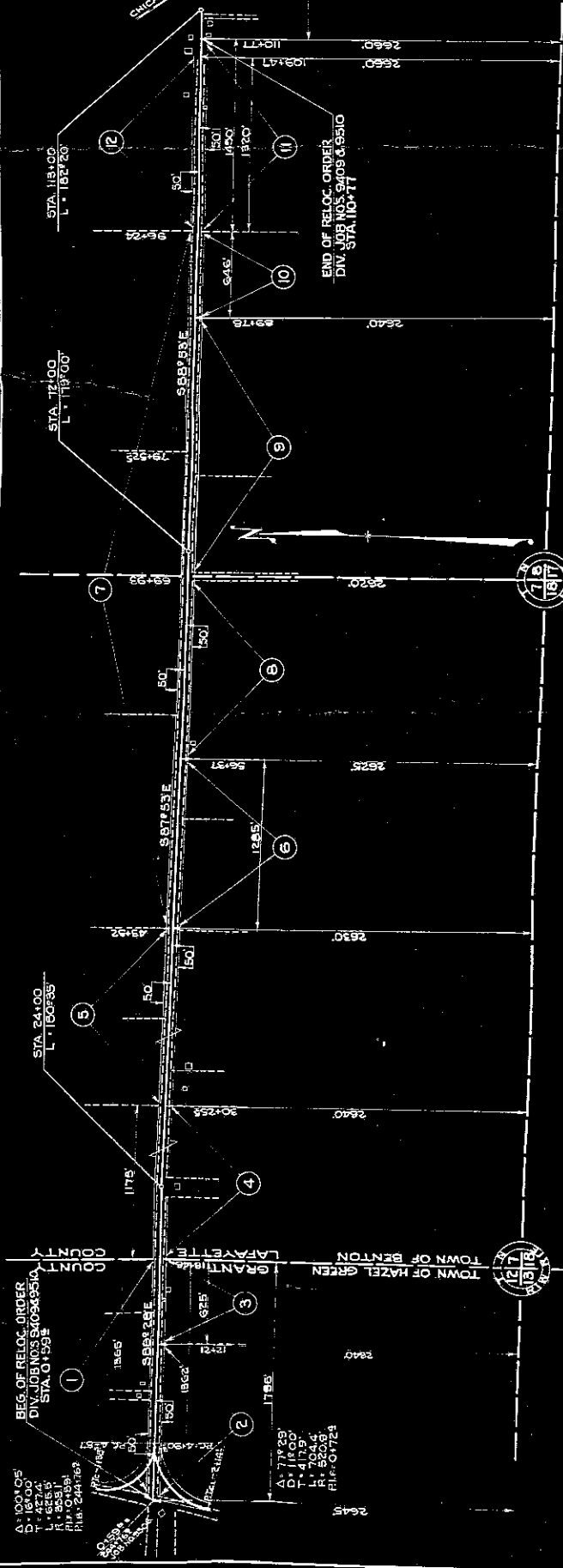

716 1817

716 1817

716 1817

NO.	OWNER	ADDRESS	ACRES	DESCRIPTION	MORTGAGEE	ADDRESS	AMOUNT PAID
1	THOMAS CARTER	CUBA CITY	1.38	SW 1/4 SEC 12 T11R W			
2	BARTLE FARGUE	BENTON	0.65	N 1/2 SEC 12 T11R W			
3	FRANK W. GAY	BENTON	0.65	SW 1/4 SEC 12 T11R W			
4	W. H. GALL	"	1.00	NW 1/4 SW 1/4 NW 1/4 SEC 11 T11R E			
5	ALBERT GRAY	"	0.45	NW 1/4 SW 1/4 SEC 11 T11R E			
6	G. T. CALVERT	"	0.11	SW 1/4 SEC 12 T11R W			
7	LESLIE JACKSON	BENTON	0.65	N 1/2 SEC 12 T11R W			
8	GROKIN BROS.	BENTON	0.65	N 1/2 SEC 12 T11R W			
9	ERDIE HIRD SCARDEN	"	0.65	PART NW 1/4 SEC 11 T11R E			
10	THOMAS BRESANZA	"	0.65	NW 1/4 SEC 11 T11R E			
11	THOMAS BRESANZA	"	0.65	NW 1/4 SEC 11 T11R E			
12	W. H. CALVERT, JR.	"	0.65	SW 1/4 SEC 11 T11R E			

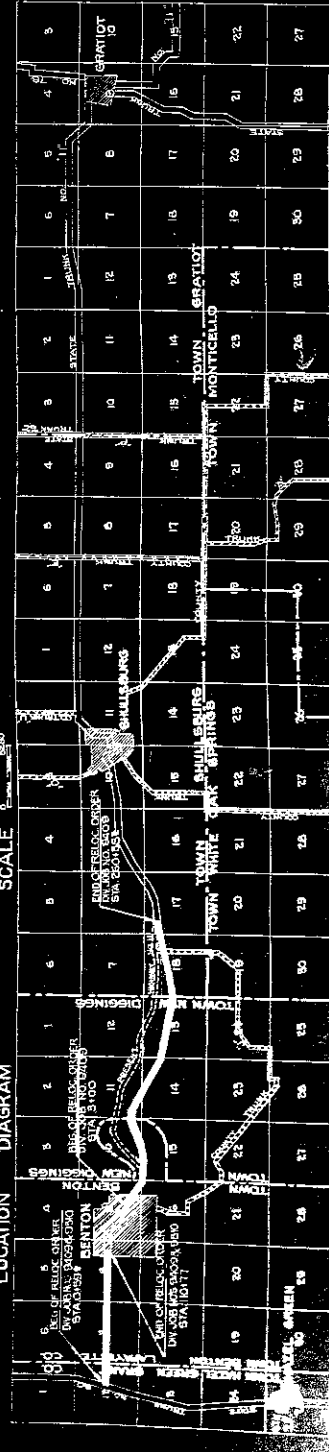

SCALE 1" = 800'

SCALE 1" = 800'

PLAT OF RIGHT OF WAY REQUIRED
DIVISION JOB NO'S 9409 & 9510
SHULLSBURG—EAST DUBUQUE ROAD
ST. NO. 11 GRANT & LAFAYETTE COUNTIES

SCALE

1 OF 3