

WISCONSIN DEPARTMENT OF TRANSPORTATION  
TOWN PLAT RECORD

TOWN OF  
**BOSCOBEL**  
COUNTY: GRANT  
(22-006)

DATE	MILEAGE FOR LOCAL ROADS/STREETS	LOCAL ROADS/STREETS Certified in accordance with sec. 86.30 Wis. stat.
(1) 4-1-96	6.80	Signature: <i>Ken Peckham</i> Date: 9-13-97 Title: CHAIRMAN
(2) 1-1-98		
(3) 4-1-98		

- (1) THIS DATA REPRESENT THE LAST CERTIFIED MILEAGE AS CORRECTED BY THE DISTRICT WHICH MAY HAVE BEEN USED FOR PAST TRANSPORTATION AIDS.
- (2) THE TOWN CHAIRMAN OR CITY/VILLAGE CLERK IS TO FILL IN THE MILEAGE TO BE CERTIFIED AS OPEN TO THE PUBLIC AS OF THE FOLLOWING JANUARY, INCLUDING THE NEW CHANGES THAT ARE MADE ON THE PLAT.
- (3) THIS DATA REPRESENTS MILEAGE ADJUSTMENTS MADE BY THE D.O.T. DISTRICT DUE TO FIELD VERIFICATION, INVENTORY, ANNEXATION, ETC. TRANSPORTATION AIDS PAYMENTS MAY BE MADE BASED ON THIS FIGURE.

LEGEND							
STATE TRUNKS	CONN. HIGHWAY	COUNTY TRUNKS	LOCAL ROAD/STREETS	RUSTIC ROAD	Non-pay ROAD/STREETS	CORPORATE LIMITS	COUNTY BOUNDARY

**Legend**

Railroad	
Bridge	
School	
Cemetery	
City, Village Town Hall	
Airport	
Unincorporated	

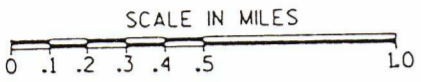

Year of last complete inventory - 1987  
The last assigned road number is 21

**SEND TO  
COUNTY CLERK**

R. 3 W.  
MARIETTA - CRAWFORD CO.

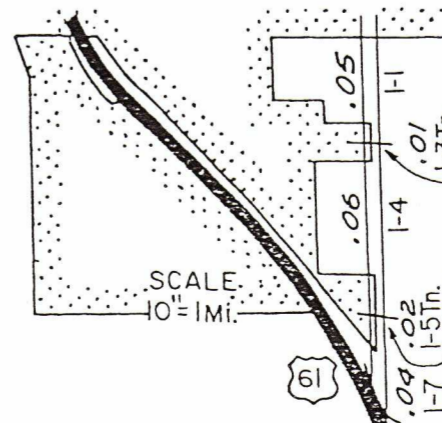
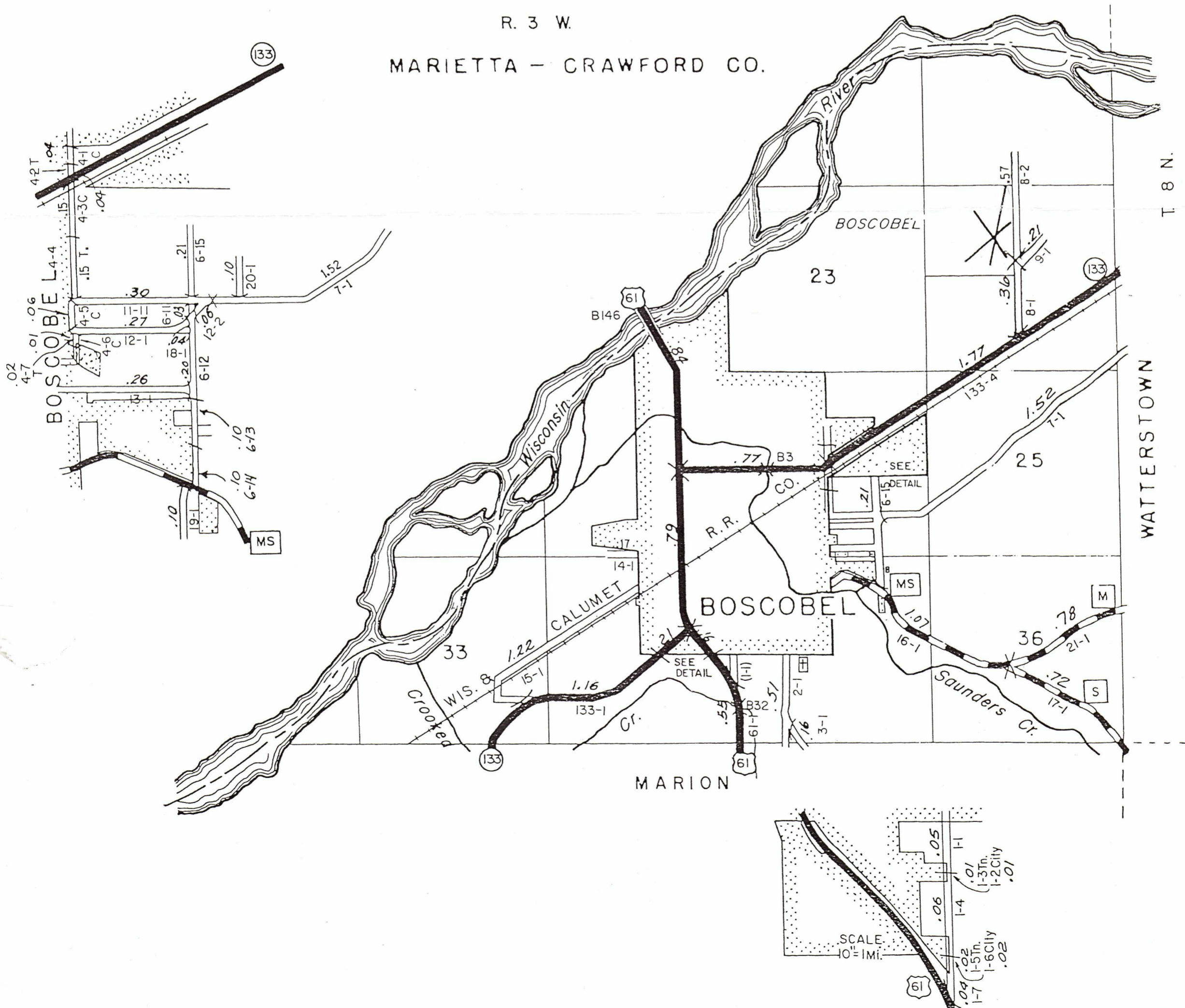

BOSCOBEL