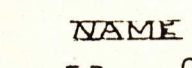
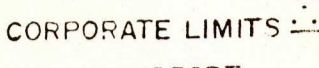
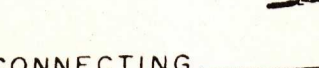
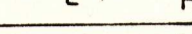
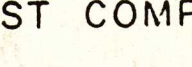

| STATE TRUNKS | CONN. STREETS | COUNTY TRUNKS | LOCAL STREETS |
|--------------|---------------|---------------|---------------|
| | | .15 | 24.02 |
| | | .15 | 23.89 |

LANCASTER

TOWN: S. LANCASTER & N. LANCASTER
 COUNTY: GRANT

LEGEND

 STATE HWYS.
 CONNECTING HIGHWAYS
 CORPORATE LIMITS
 AIRPORT
 NAME
 assigned street no. is 00166

Certified as correct *Deane Weyh* Signature _____ Title Director of Transportation

assigned street no. is 00166
 LAST COMPLETE INVENTORY—1982

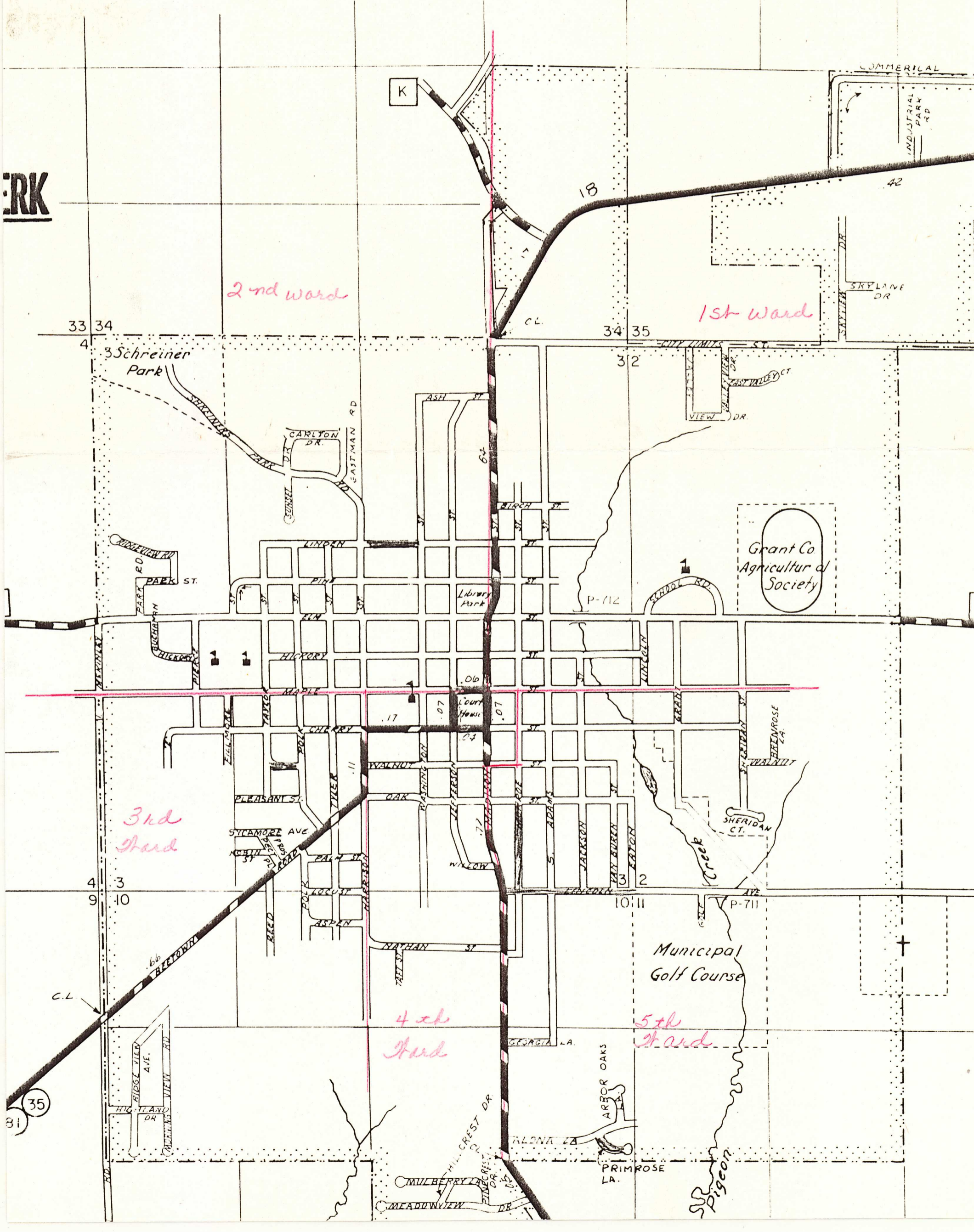

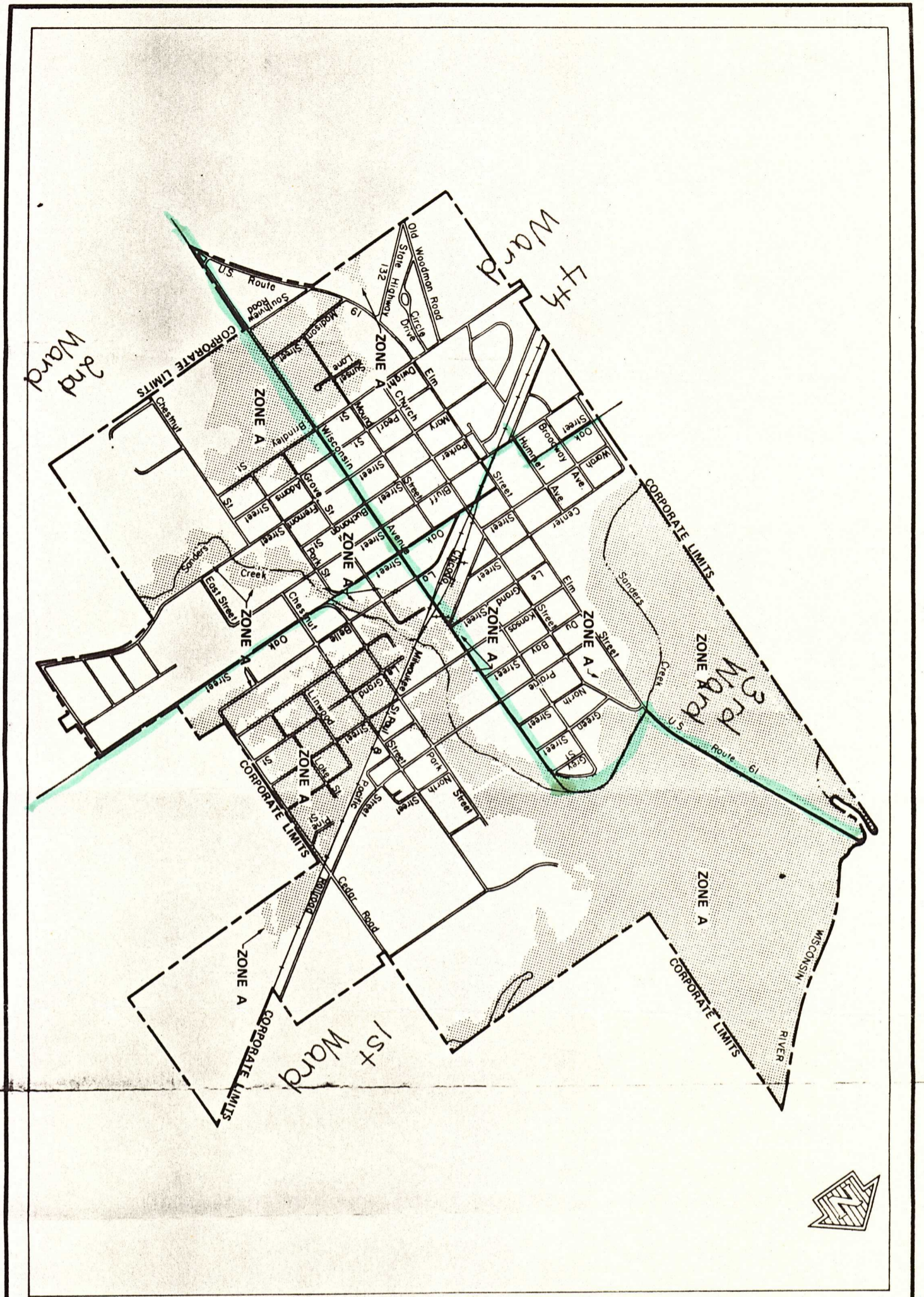

| | | | |
|----|---|---|------------------------------|
| 10 | DEPARTMENT OF HOUSING AND URBAN DEVELOPMENT Federal Insurance Administration CITY OF BOSCOBEL, WI (GRANT COUNTY) | APPROXIMATE SCALE 1000 0 1000 2000 3000 FEET | Map Revised NOV. 30, 1979 |
| | FLOOD HAZARD BOUNDARY MAP | | |

Dorothea -
 Shown above are the boundaries of Boscobel's
 four Wards per your request

GRANT Co.
WARD II

GRANT Co.
WARD III

LAFAYETTE
County

WARD III

LAFAYETTE
County
WARD IV

GRANT Co.
WARD I

GRANT Co.
WARD IV

City of Cuba City

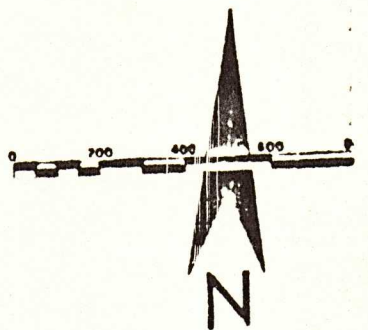

SMELSER TWP
RENTON TWP
HAZEL GREEN TWP
RENTON TWP

MOORE ROAD

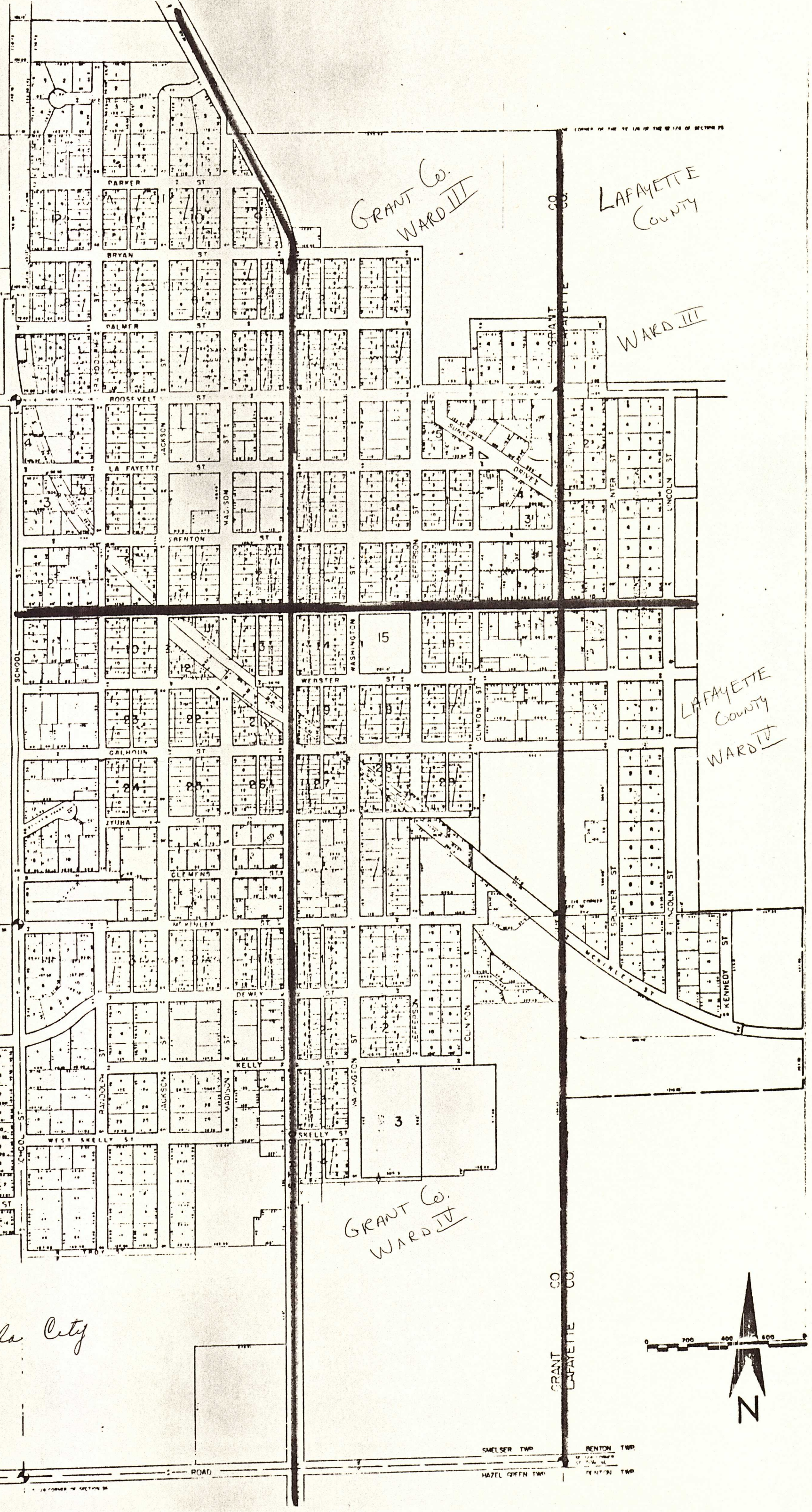

FENNIMORE, WISCONSIN

FEBRUARY, 1974

EISENHOWER ST.
KENNEDY ST.
WILSON ST.
WISCONSIN ST.
WASHINGTON ST.
ROOSEVELT ST.
MONROE ST.
MADISON ST.
LINCOLN AVE.
JEFFERSON ST.
JACKSON ST.
GRANT ST.
GARFIELD ST.
COOLIDGE ST.
CLEVELAND ST.
ADAMS ST.
MARSDEN PARK RD.

LEGEND

CORPORATE LIMITS - - - - -

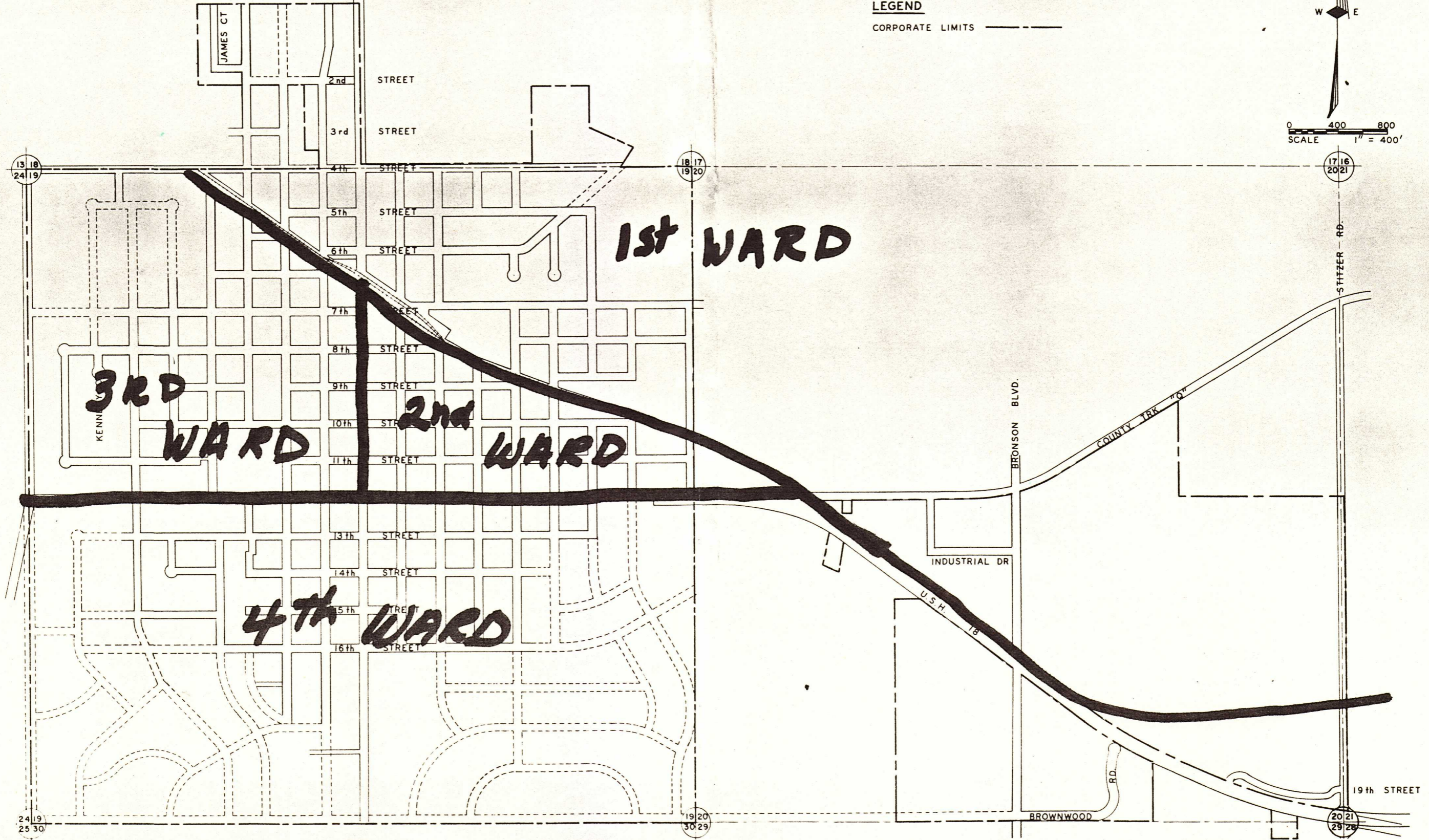
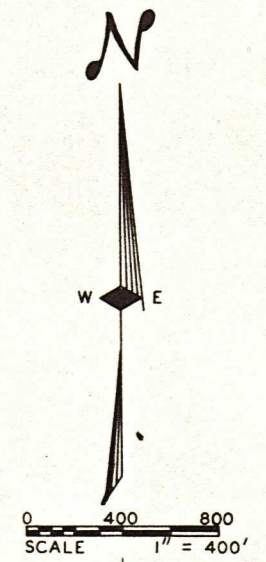

TALLEY AVE J-4
 MINERAL ST E-1-7
 MINERAL ST W-1-6
 MITCHELL AVE H-7
 MONROE ST G-4
 MOORE ST J-7
 MOUND VIEW CT 1-5
 MOUND VIEW DR 1-5
 NORTH ST J-7
 OAK ST H-7
 OAKHAVEN RD G-4
 PERRY DR E-6
 PHILLIPS RD H-7
 PINE ST E H-7
 PINE ST W G-7
 PITT ST 1-4
 PRESTON DR F-6
 PRINCESS CT G-4
 RICHARD ST G-6
 RIDGE AVE F-4
 RIDGE AVE H-4

UNIVERSITY OF WISCONSIN
PLATTEVILLE

1,2,3 ARMORY #1
 4,5,6 O.E. GRAY SCHOOL #2
 7,8,9 STUDENT CENTER #3
 10,11,12 FIRE STATION #4

FREE MAPS AT



CHAMBER OF COMMERCE

CITY HALL

1,446 reg. voters in Dist. 2 (Wards 4, 5 + 6)

1,578 reg. voters in Dist. 1 (Wards 1, 2 + 3)

1,730 reg. voters in Dist. 3 (Wards 7, 8 + 9)

1,618 reg. voters in Dist. 4 (Wards 10, 11 + 12)

Cannot campaign within 500 feet of polls on election day.
 Must live in City limit for ten days

LEGEND

- | | |
|---|---|
| PUBLIC BUILDINGS 1-Chamber of Commerce 2-Community Bldg. & Police Dept. H-6 4-Fire Dept. 1-7 5-Library G-7 7-Mining Museum 1-7 8-Post Office H-7 SCHOOLS & COLLEGES 12-Hammer-Robbins Grade School 1-7 13-High School K-5 15-Oliver Gray Grade School H-6 16-St. Mary's Parochial Grade School H-6 18-University of Wisconsin-Platteville F-7 19-West View Grade School E-5 RECREATIONAL 23-City Hall Park H-6 24-Harrison St. Park G-8 26-Moundview Park K-5 | MISCELLANEOUS 45-Big Badger Fairgrounds 46-American Legion Bldg. 48-Armory 1-6 49-Cunningham House 51-Masonic Temple H-7 52-Platteville Fairgrounds 54-Platteville Memorial 55-Pioneer Stadium F-6 57-Rountree House G-5 58-Sewage Treatment Plant 60-Sherman Park Memorial 61-Water Treatment Plant 63-WSW Radio Station CHURCHES 68-Assembly of God J-7 69-Calvary Baptist 1-7 71-St. Mary's Catholic 72-First Baptist Church |
|---|---|

WARDS NOV 28 1986

PLATTEVILLE

